

T23S, R32.5E, WM
HARNEY COUNTY, OREGON

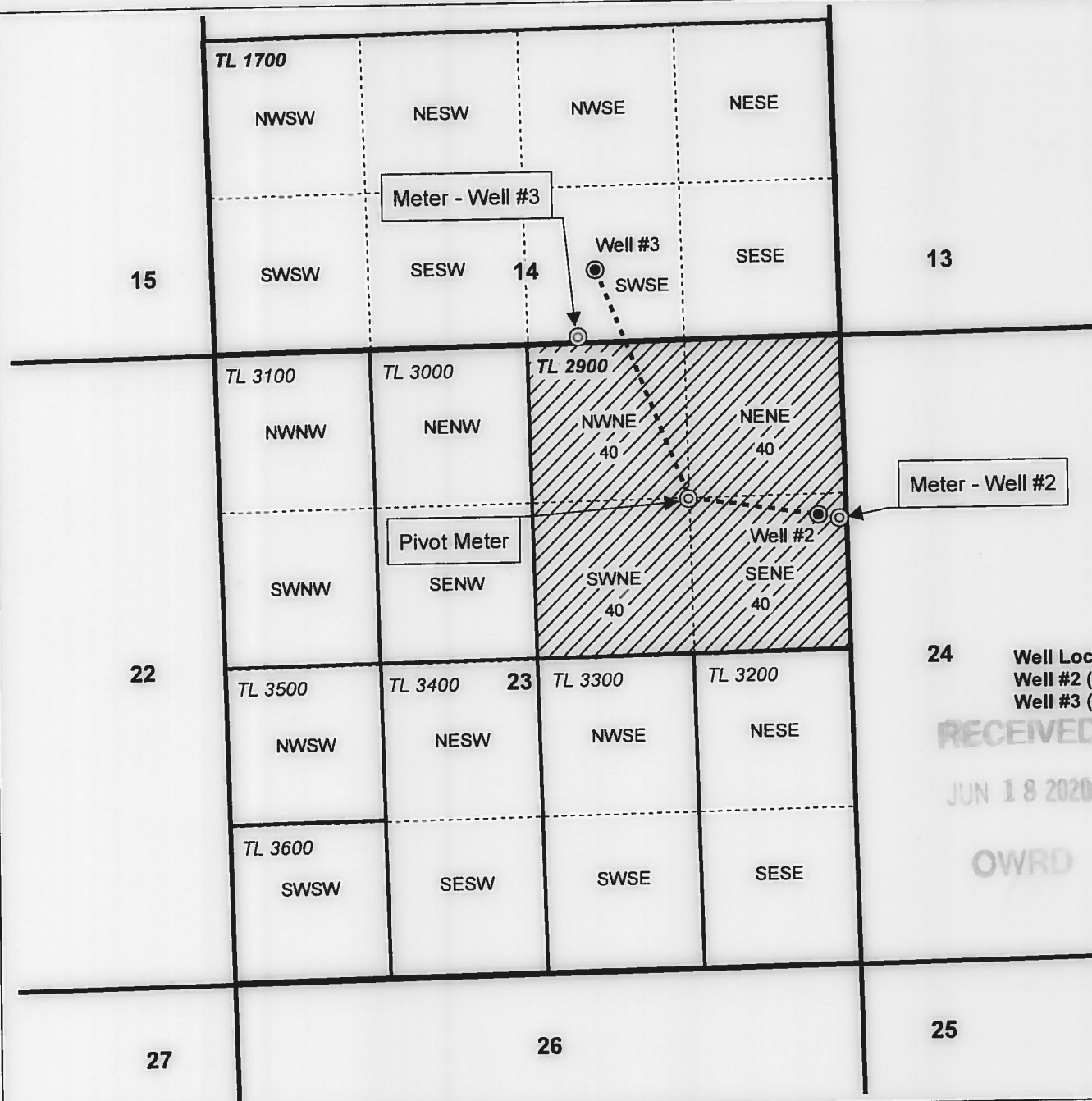

0 1,320 Feet
 1" = 1,320'

- Well
- ⊙ Meter
- Pipeline
- ▨ POU IR
- ▭ Section
- Quarter Quarter
- ▭ Tax Lot



24 Well Locations:
 Well #2 (HARN 51552/L-100252): 1500' S, 225' W of NE Cor Sec 23
 Well #3 (HARN 51925/L-111154): 620' N, 530' E of S 1/4 Cor Sec 14

RECEIVED
 JUN 18 2020
 OWRD

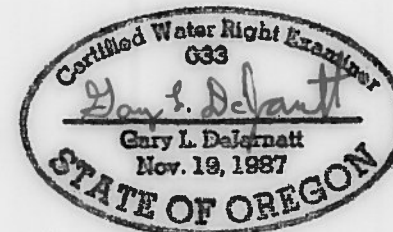

RENEWAL DATE 12/31/2021

CLAIM OF BENEFICIAL USE MAP
John Ensz Farms, LLC

NOTE: THIS MAP IS NOT INTENDED TO
 PROVIDE LEGAL DIMENSIONS OR LOCATIONS
 OF PROPERTY OWNERSHIP LINES.

WATER RIGHT SERVICES, LLC
 PO BOX 1830, BEND, OR 97709
 CCB# 197121 www.oregonwater.us
 541-389-2837 JOHNSHORT@USA.COM

AP G-16826 PERMIT G-17671

JOB # 20016

Date: 4/27/2020