

CLAIM OF BENEFICIAL USE MAP

TO CHANGE PLACE OF USE AND
A POINTS OF APPROPRIATION
FOR APP T-12515
HUFFORD ESTATE, LLC

RECEIVED

APR 22 2020

OWRD

SECTION 19, TOWNSHIP 24 SOUTH, RANGE 15 EAST, W.M.
TAX LOT: 600 LAKE COUNTY, OREGON

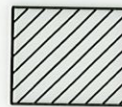
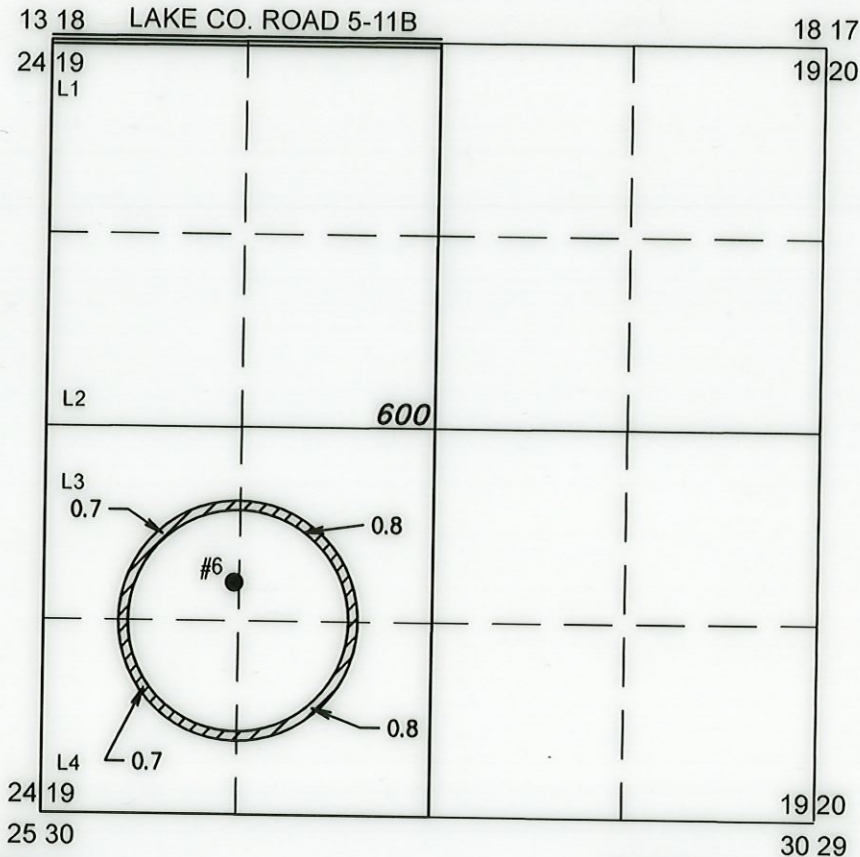
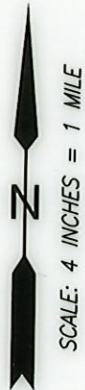

3.0 ACRES FROM #6 & PERMIT
G-10708, AS SHOWN

- #6 (PIVOT 7)
EXISTING WELL (LAKE 170/174) TRANSFER: T-12515
3700' SOUTH & 1310' EAST FROM THE NW CORNER SECTION
19

METER IS LOCATED ON THE DELIVERY PIPE 3 FEET NORTH
OF THE CENTER PIVOT SPRINKLER

RENEWAL DATE: 12/31/2020

THIS MAP IS FOR THE PURPOSE OF LOCATING A WATER
RIGHT ONLY AND HAS NO INTENT TO PROVIDE LEGAL
DIMENSIONS OR THE LOCATION OF PROPERTY LINES

PREPARED FOR:

HUFFORD ESTATE, LLC
P.O. BOX 99
FORT ROCK, OR 97735

PREPARED BY:



ALL POINTS ENGINEERING AND SURVEYING, INC.
P.O. BOX 767 TERREBONNE, OR 97760
(541) 548-5833 www.APEandS.com