

Section 1, T13S, R6W, W.M.,  
 Sections 31 & 32, T12S, R5W, W.M.,  
 Section 6, T13S, R5W, W.M.,  
 Section 19, T13S, R4W, W.M.,  
 Benton County, Oregon

Application S-88667, Permit S-55212  
 CLAIM OF BENEFICIAL USE MAP  
 O.O. Agriculture LLC

WILLAMETTE MAINSTREAM DIVERSION POINT  
 LOCATED:  
 1,700 FT S AND 980 FT E  
 FROM NW CORNER OF SECTION 19, T13S, R4W

OO AG REDIVERSION POINT LOCATED:  
 2,590 FT N AND 1,800 FT E  
 FROM SW CORNER OF SECTION 32, T12S, R5W

PIPELINE REDIVERSION POINT LOCATED:  
 1,040 FT S AND 930 FT E  
 FROM NW CORNER OF SECTION 6, T13S, R5W

CERTIFIED WATER RIGHT EXAMINER  
 439  
*Steven R. Bruce*  
 STEVEN R. BRUCE  
 JUNE 13, 1997  
 STATE OF OREGON  
 Expires 12/31/2021

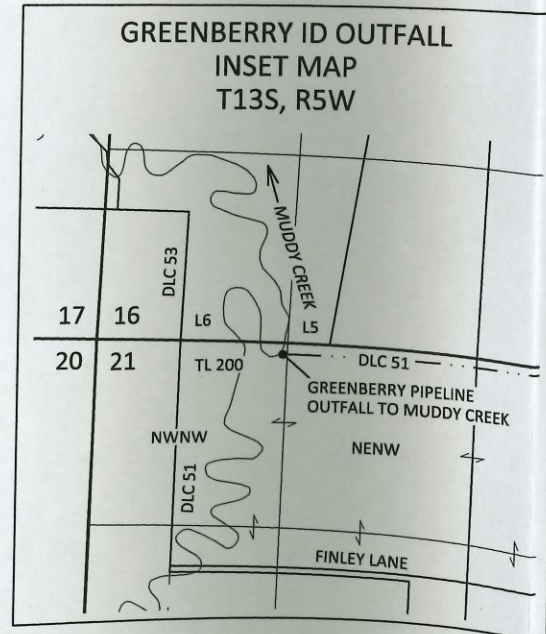
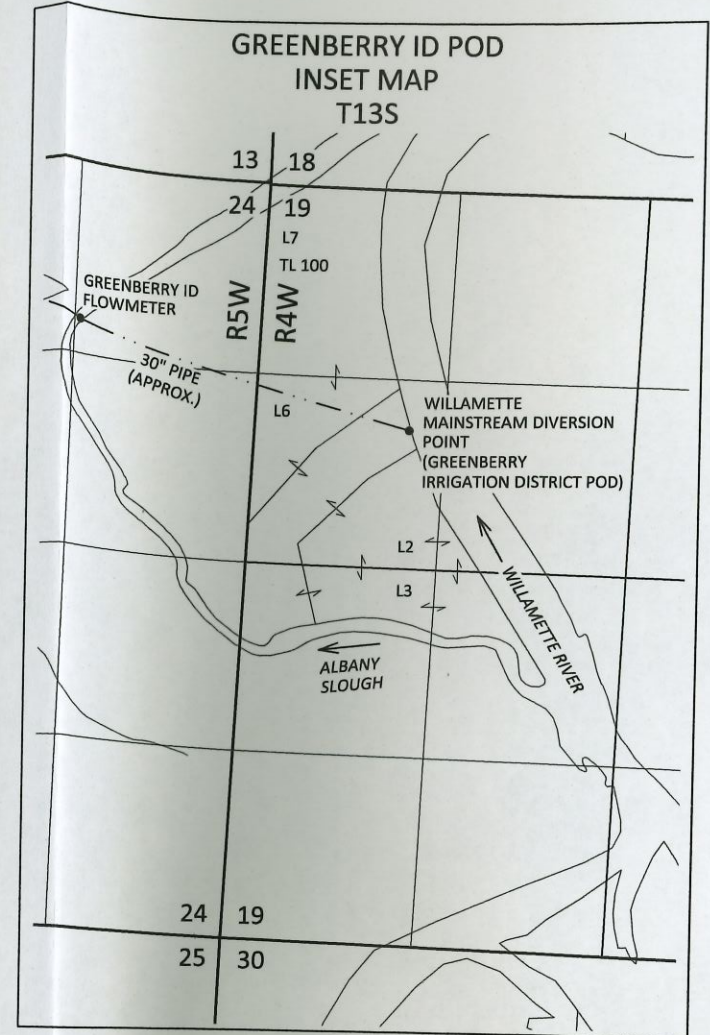
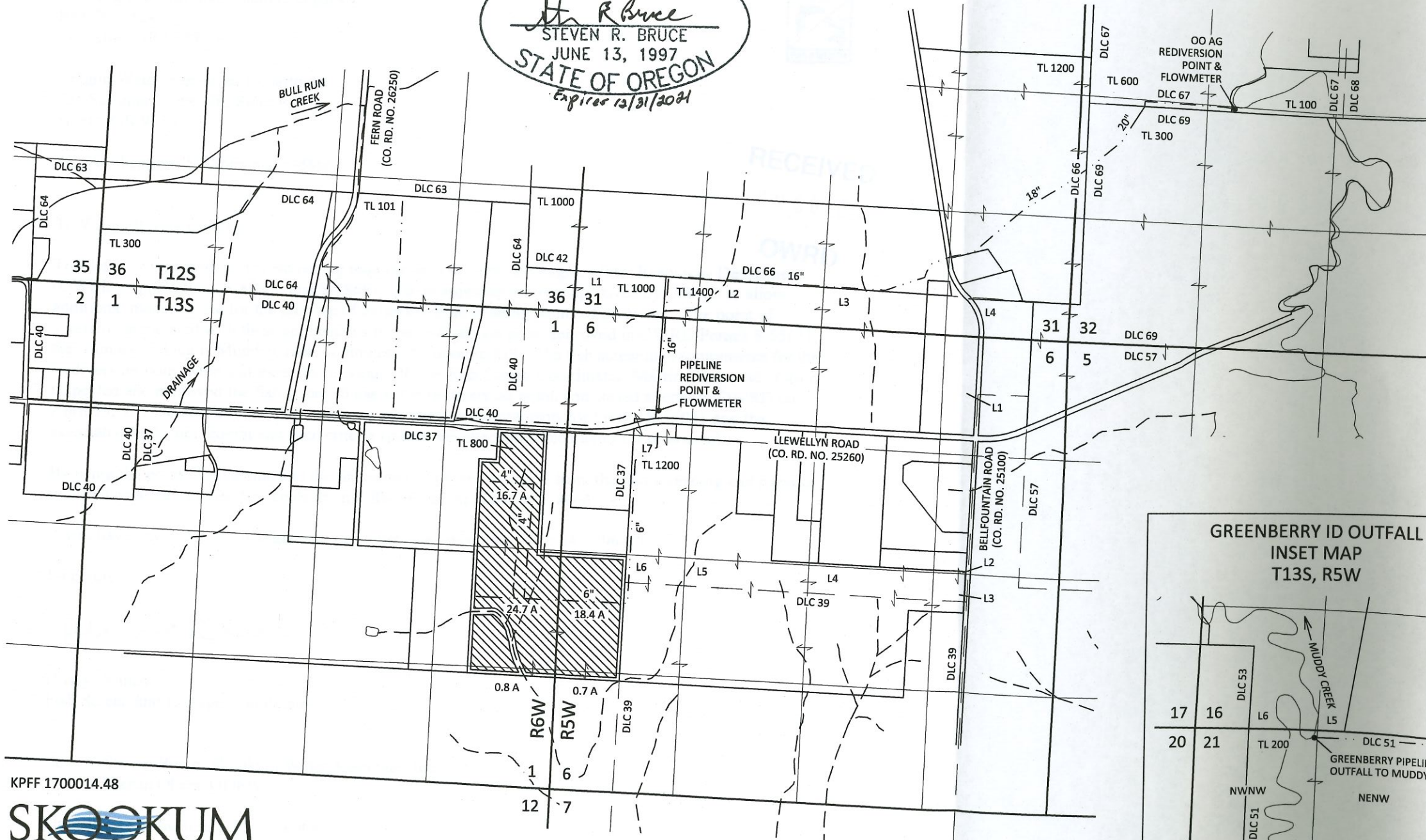

EXPLANATION

- PLACE OF USE  
61.3 ACRES
- POINT OF DIVERSION (POD), REDIVERSION POINT, OUTFALL
- PIPELINE (APPROX.)

Site inspection conducted  
 3/11/2021

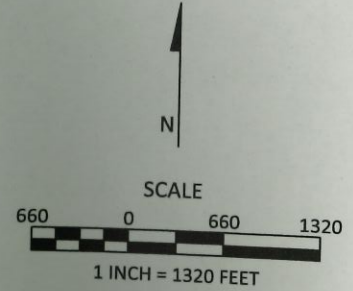

June 3, 2021

This map is not intended to provide legal  
 dimensions or locations of property  
 ownership lines

Figure 1

RECEIVED  
 JUN 30 2021  
 OWRD