

CLAIM OF BENEFICIAL USE MAP FOR T-11628
 T40S, R9W, WM, JOSEPHINE COUNTY
 NW1/4 SW1/4 of Section 26
 September 20, 2015

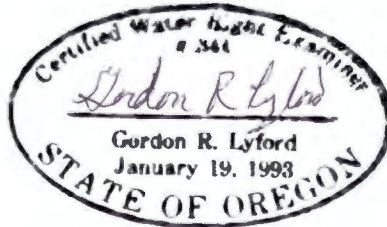
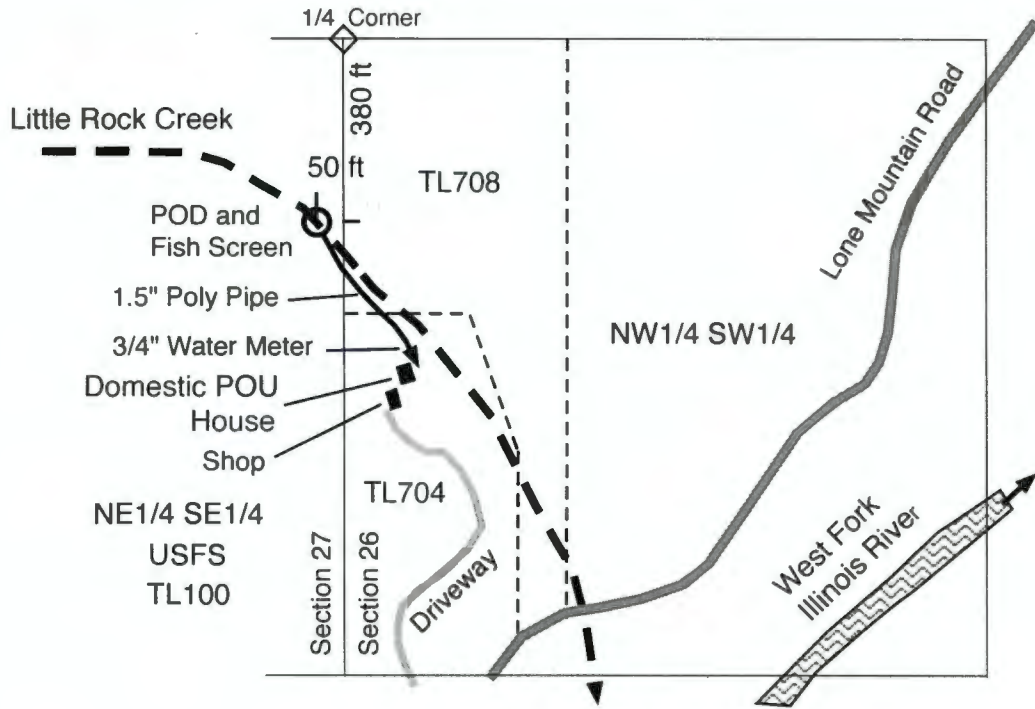
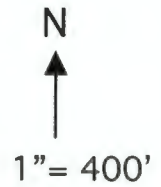

RECEIVED BY OWRD
 SEP 24 2015
 SALEM, OR

9-20-2015
 exp 12-31-2016

○ Point of Diversion

■ Place of domestic use with a priority of September 23, 1947 from application S-22836 and permit S-17966 at a rate of 0.005 cfs year round for one house.

- - - Tax lot lines

This map was drawn by Gordon R. Lyford for Robert and Wanda Powell to support their claim of beneficial use under T-11628 of water from Little Rock Creek for domestic use. They own tax lots 704 and 708.

This map was prepared for the purpose of identifying the location of water rights only and is not intended to provide legal dimensions or the location of property ownership lines.