

RECEIVED

JUL 12 2021

Claim of Beneficial Use Map

Place of Use

Transfer B-112

Deschutes County, Oregon

Township 17 and 18 South, Range 11 and 12 East (W.M.)

OWRD

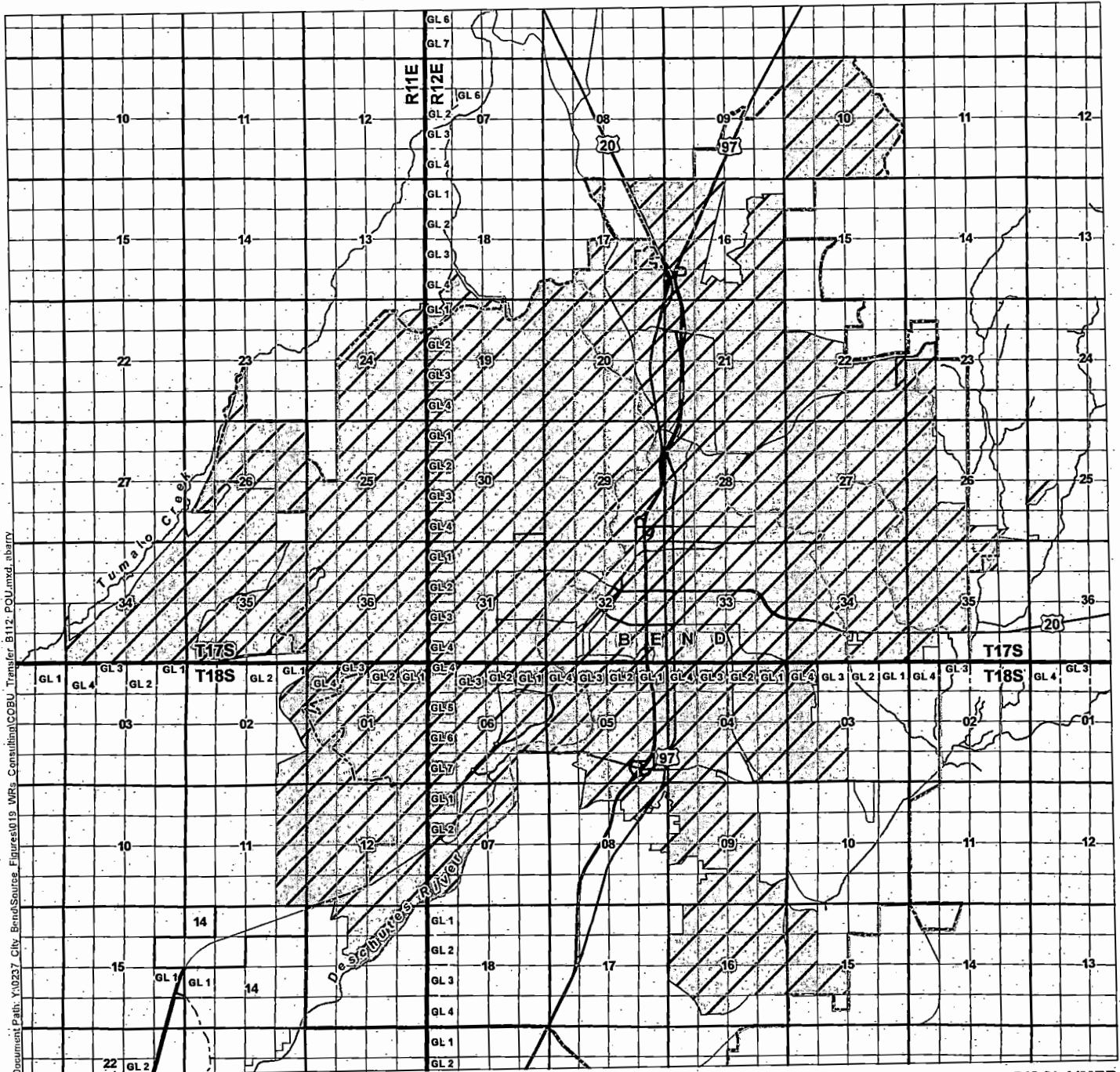

Document Path: Y:\0237 City Bend\Sources\Figures\019 WRS_Combined\COBU_Transfer B112_POU.mxd, abarry

LEGEND

- Place of Use (POU)
- City Water Service Boundary
- Government Lot (GL)
- City Boundary
- Major Road
- Watercourse

Certified Water Rights Examiner Stamp

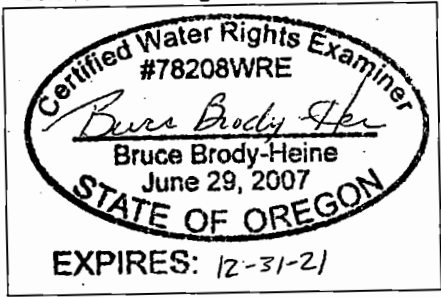

DISCLAIMER
This map was prepared for the purpose of identifying the location of a water right only and it is not intended to provide legal dimensions or location of property ownership lines.

MAP NOTES
Date: March 1, 2021
Data Sources: BLM, OGIC, City of Bend

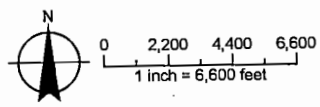

**Claim of Beneficial Use Map
Point of Diversion
Transfer B-112
Deschutes County, Oregon
Township 18 South, Range 10 East (W.M.)**

RECEIVED

JUL 12 2021

OWRD

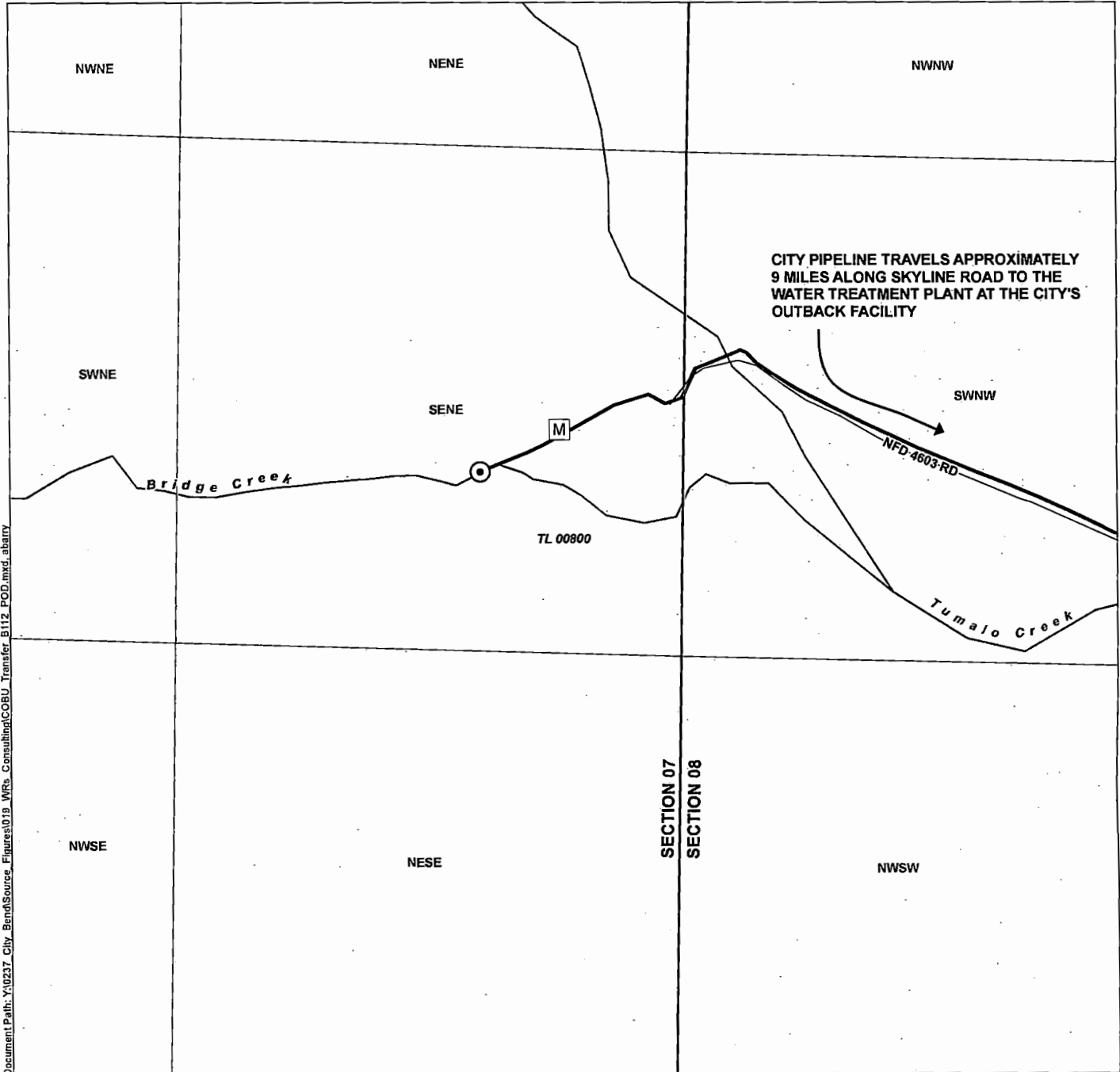

Document Path: Y:\0237_City_Bend\Source_Figures\019_WRs_Consulting\COBU_Transfer_B112_POD.mxd_abstr

LEGEND

- Point of Diversion (POD)
- Meter Location
- Pipeline
- Road
- Watercourse

POD LOCATION DESCRIPTION

Located 465 feet North and 542 feet West from the SE corner of the SE 1/4 of the NE 1/4 Quarter Section, Section 7, Township 18 South, Range 10 East (W.M.)
Water meter: Located 585 feet North and 325 feet West from the SE Corner of the SE 1/4 of the NE 1/4 Quarter Section, Section 7, Township 18 South, Range 10 East (W.M.)

Certified Water Rights Examiner Stamp

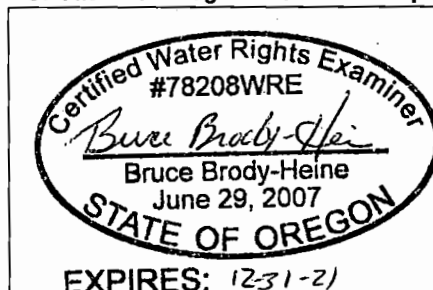

DISCLAIMER

This map was prepared for the purpose of identifying the location of a water right only and it is not intended to provide legal dimensions or location of property ownership lines.

MAP NOTES

Date: June 24, 2021
 Data Sources: BLM, OGIC, City of Bend

