

COBU MAP #1309

COBU MAP #1309

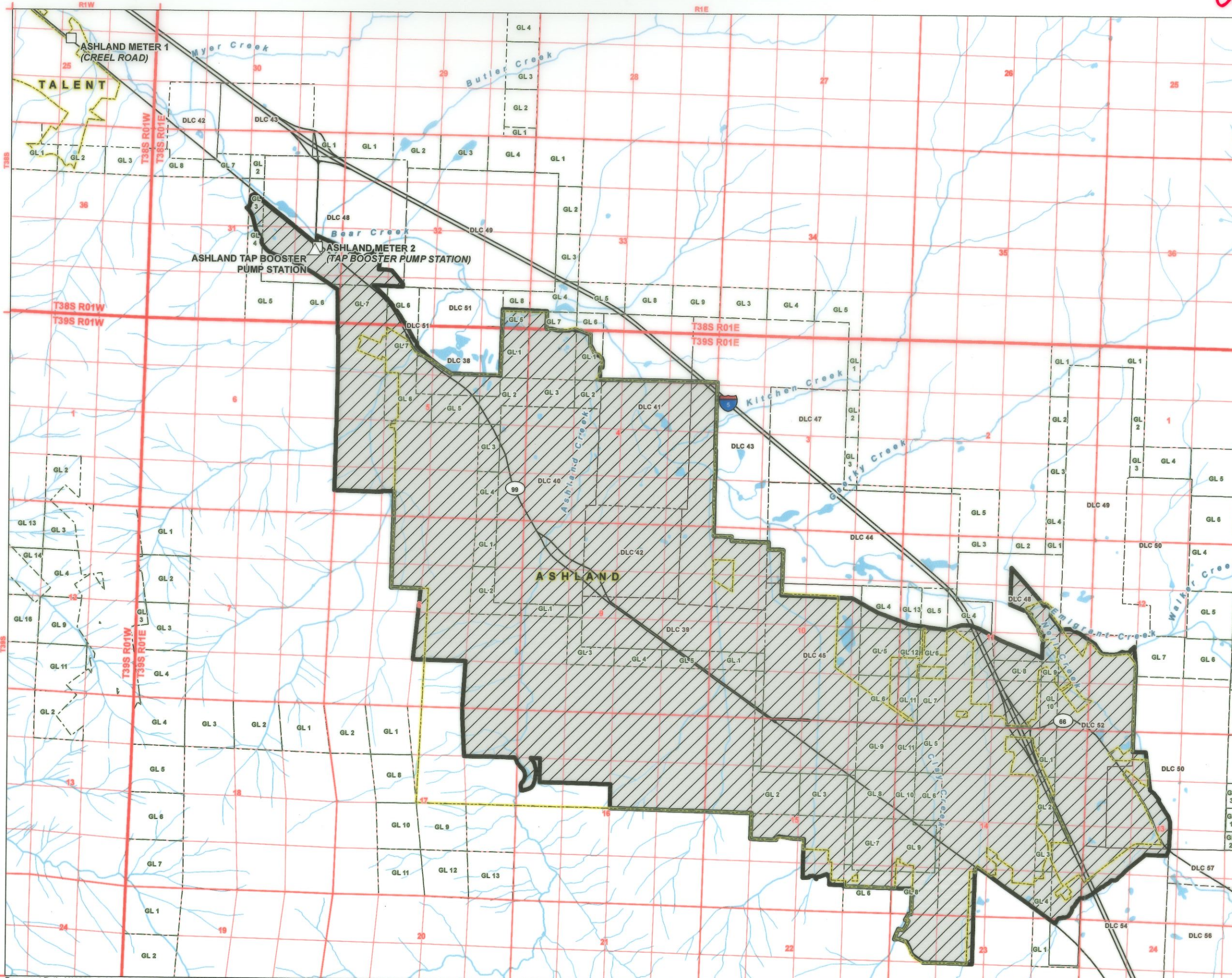

Claim of Beneficial Use Map
Place of Use Map
Permit S-54337 (Application S-85733)

A Water Right in the Name of
City of Ashland

LEGEND

- Meter
- △ Pump Station
- ▨ The service area of City of Ashland
- ▭ City Service Area
- ⊞ Government Lot (GL)
- ⊞ Donation Land Claim (DLC)
- ⬡ City Limit
- Major Road
- ~ Watercourse
- Waterbody

PLACE OF USE DESCRIPTION
"The service area of the City of Ashland"

RECEIVED

SEP 21 2021

OWRD

CERTIFIED WATER RIGHTS EXAMINER STAMP

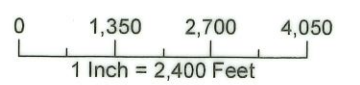
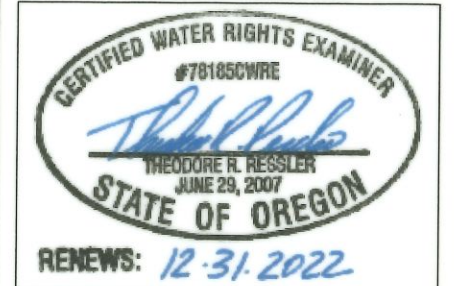

DISCLAIMER

This map was prepared for the purpose of identifying the location of a water right only and it is not intended to provide legal dimensions or location of property ownership lines.

Date: August 19, 2021
Data Sources: Jackson County GIS, OWRD



COBU MAP #1309



Document Path: Y:\0658_Ashland\Source_Figures\003_WR_Assistance\COBU_POD_S54337.mxd.mpalmer

- LEGEND**
- Point of Diversion (POD)
 - Donation Land Claim (DLC)
 - Tax Lot
 - Watercourse
 - Waterbody

Claim of Beneficial Use Map
Point of Diversion Map
Permit S-54337 (Application S-85733)
A Water Right in the Name of City of Ashland
Township 33 South, Range 1 East (WM)

CERTIFIED WATER RIGHTS EXAMINER STAMP



LOCATION DESCRIPTION
 Lost Creek Reservoir Outlet
 Located 2,055 feet south and 1,190 feet east from the NW
 corner of Section 26, Township 33 South, Range 1 East (W.M.)

RECEIVED
SEP 21 2021
OWRD

DISCLAIMER
 This map was prepared for the purpose of identifying the location of a water right only and it is not intended to provide legal dimensions or location of property ownership lines.



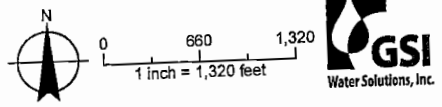

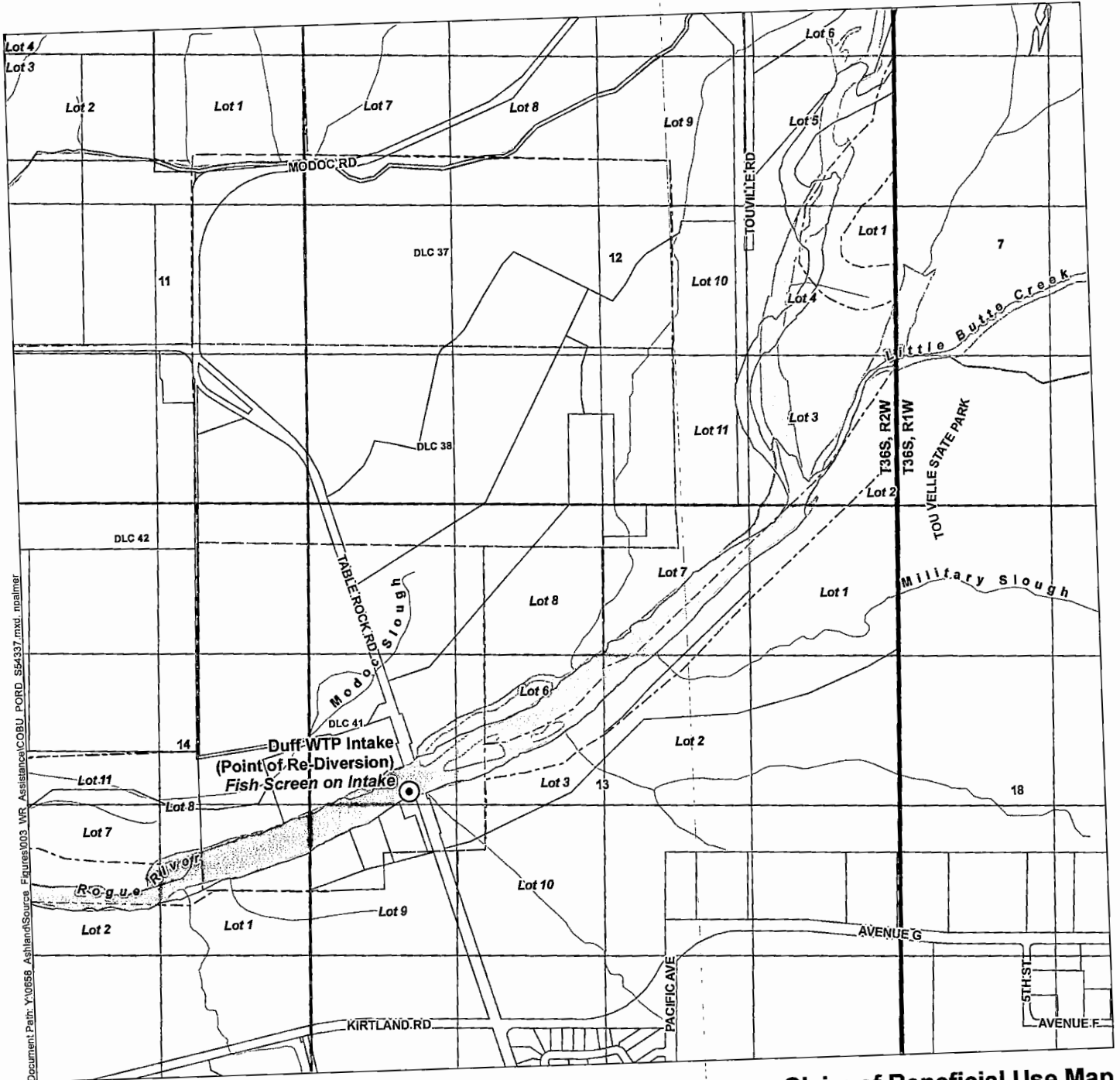

Date: August 19, 2021
 Data Sources: BLM, ESRI, OWRD, USGS, Jackson Co.





Document Path: Y:\0658_Ashland\Source_Figures\003_MR_Assistance\COBU_PORD_S54337.mxd_npalmer

LEGEND

-  Point of Re-Diversion (POD)
-  Donation Land Claim (DLC)
-  Government Lots
-  Tax Lot
-  Watercourse
-  Waterbody

CERTIFIED WATER RIGHTS EXAMINER STAMP

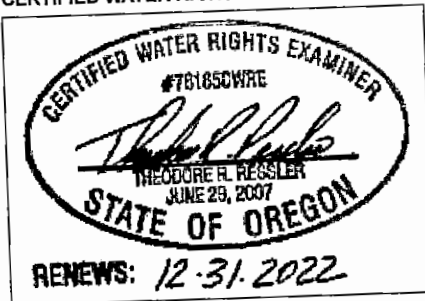

RECEIVED

SEP 21 2021

OWRD

LOCATION DESCRIPTION

Duff WTP Intake
 Located South 25°25'28" East, 4,385.6 feet from the NE corner of Donation Land Claim 42 (W.M.)

**Claim of Beneficial Use Map
 Point of Re-Diversion Map
 Permit S-54337 (Application S-85733)
 A Water Right in the Name of City of Ashland
 Township 36 South, Range 1 West (WM)**

DISCLAIMER
 This map was prepared for the purpose of identifying the location of a water right only and it is not intended to provide legal dimensions or location of property ownership lines.

Date: August 19, 2021
 Data Sources: BLM, ESRI, OWRD, USGS, Jackson Co.

