

T. 3N.,
R. 29E.,
W.M.

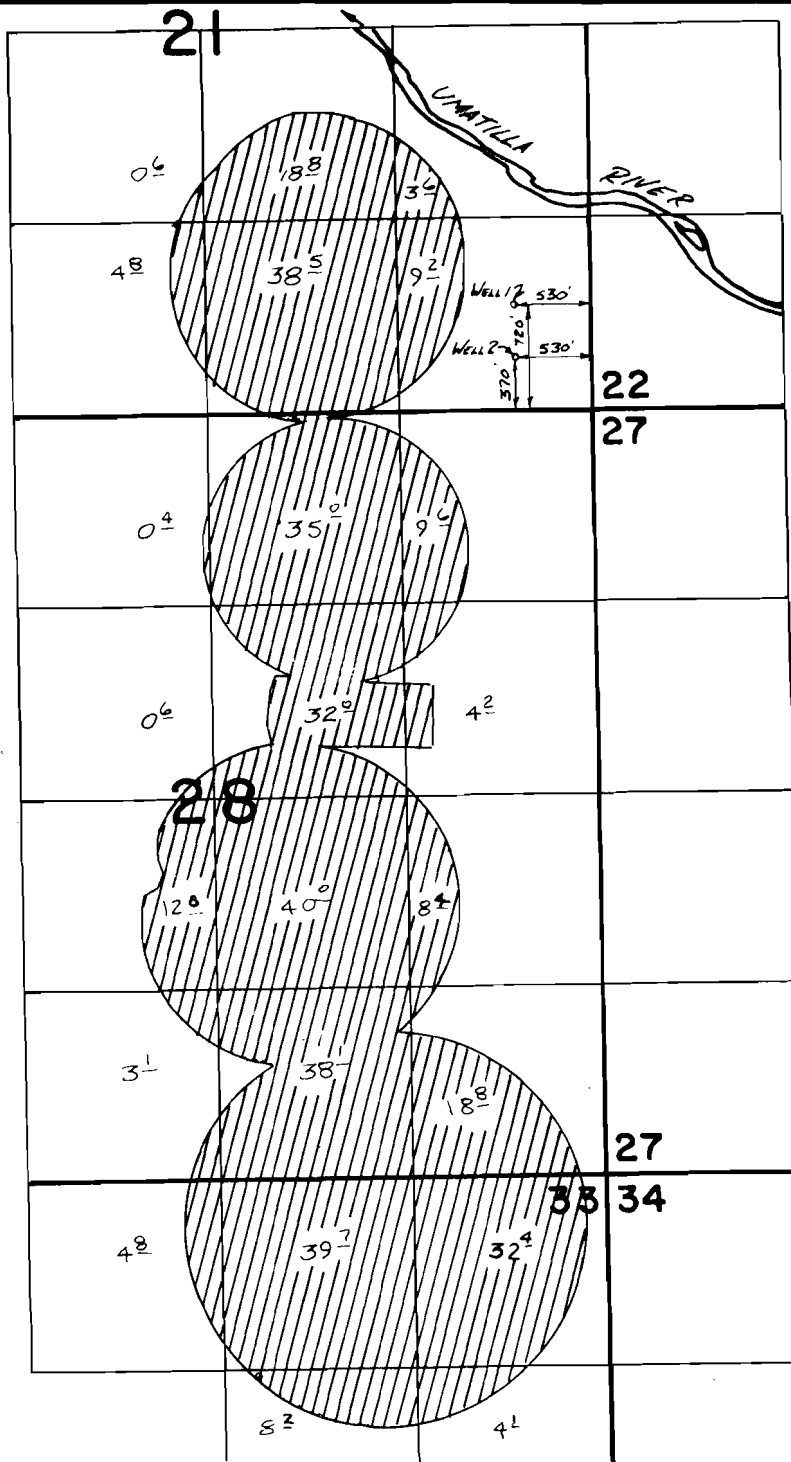

SCALE 1" = 1320'

**FINAL PROOF SURVEY
UNDER**

Application No. G-8976 Permit No. G-8369
IN NAME OF

.....RON.....HOLEMAN.....

Surveyed 7-28..... 1982., by *V.H. Church*.....

T. 3N.,
R. 29E.,
W.M.

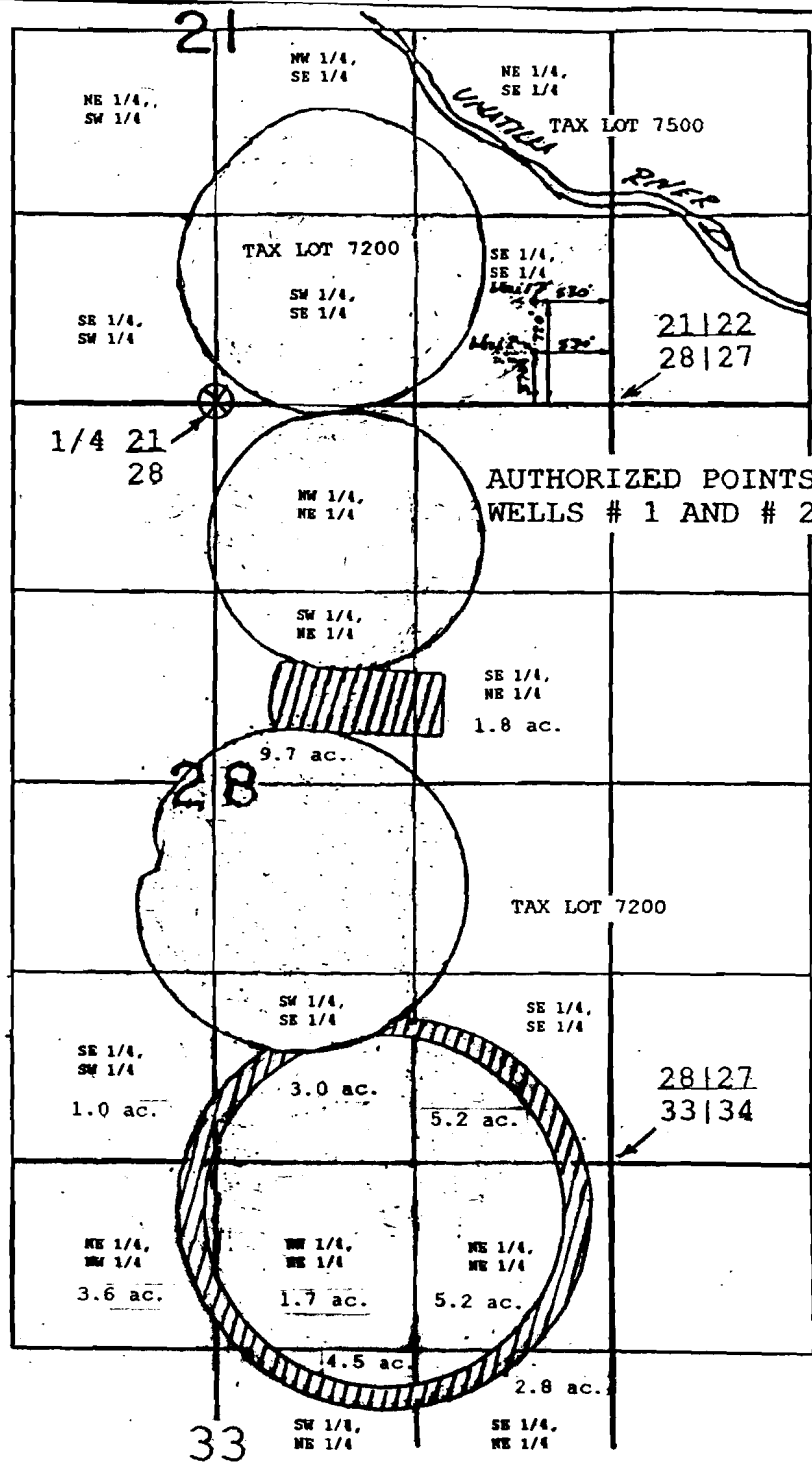

AUTHORIZED POINTS OF APPROPRIATION
WELLS # 1 AND # 2.

SCALE 1"=1320'

MAP TO ACCOMPANY WATER RIGHT TRANSFER APPLICATION
NEW PLACE OF USE

AFFECTING A PORTION OF
PERMIT G - 8369 CERTIFICATE 53082
SECTIONS 21, 28 AND 33, T. 3 N., R. 29 E., W.M.

UMATILLA COUNTY, OREGON

APPLICANTS: LLOYD AND LOIS PIERCY
T - 9683 and T - 9684

LEGEND



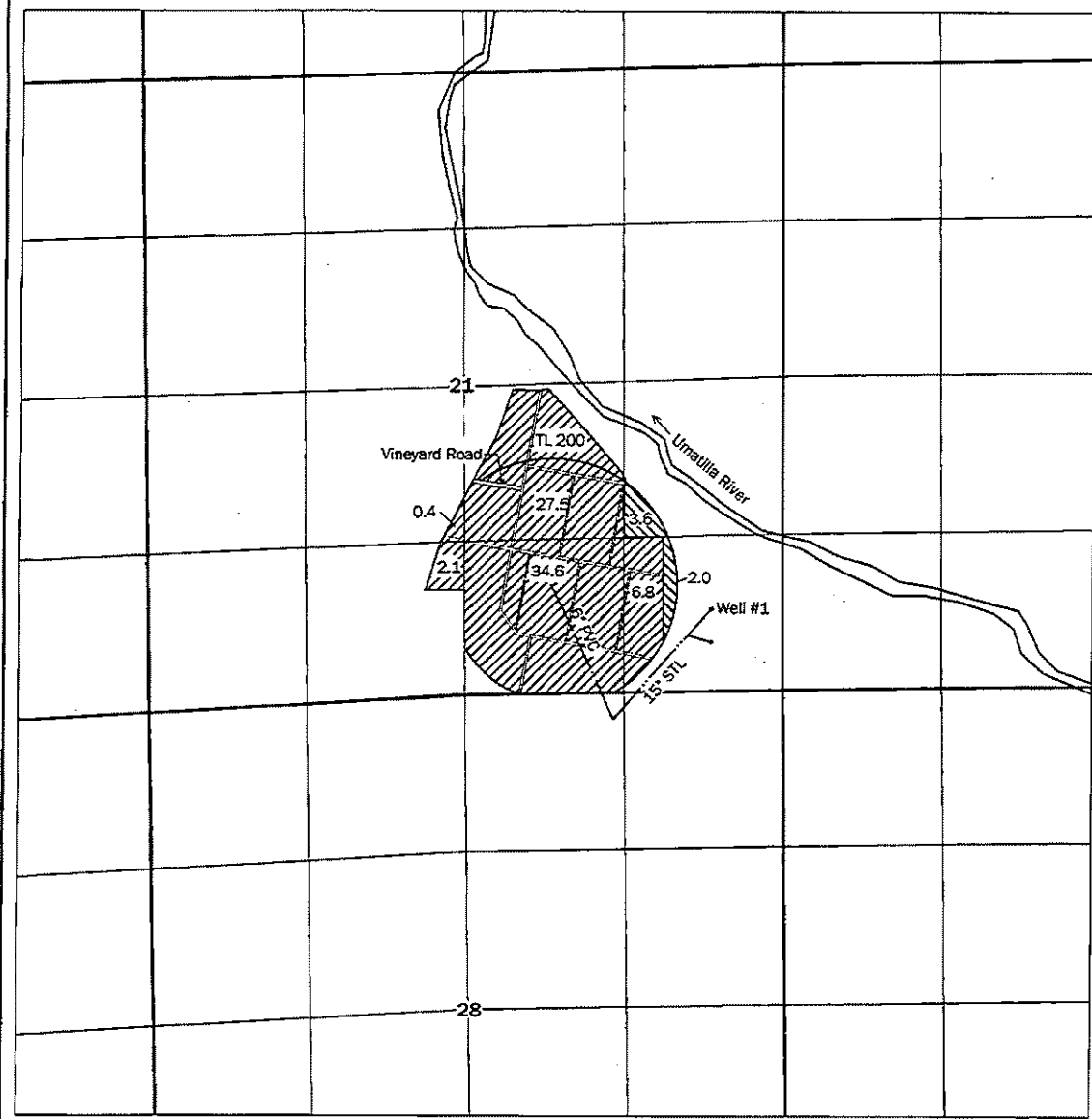

- ⊗ = TRANSFER "FROM" AREA
- ⊗ = CORNER TIED BY SURVEY

Amend



Place of use Transfer
Certificate 81319
Bales
T3N, R29E, W.M. Section 21
Umatilla County, Oregon
TO Lands

Legend

-  Buried Main Line
-  Wheel Line
-  7.14 AC TO Lands
-  Area not Involved in this Transfer

Point of Appropriation

Well #1
Located 720' North and 530' West from the SE corner, section 21.
Tax Lot 9300

Certified Water Rights Examiner Stamp

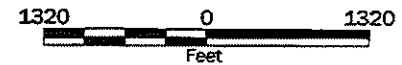
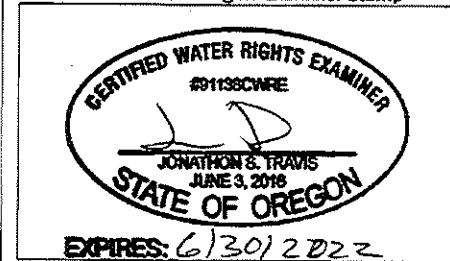

Disclaimer

This map was prepared for the purpose of identifying the location of a water right only and it is not intended to provide legal dimensions or location of property ownership lines.

Map Notes

Date: 09/31/21
Data Sources: ESRI
Prepared By: GeoEngineers

GEOENGINEERS

RECEIVED

FEB 01 2022

OWRD

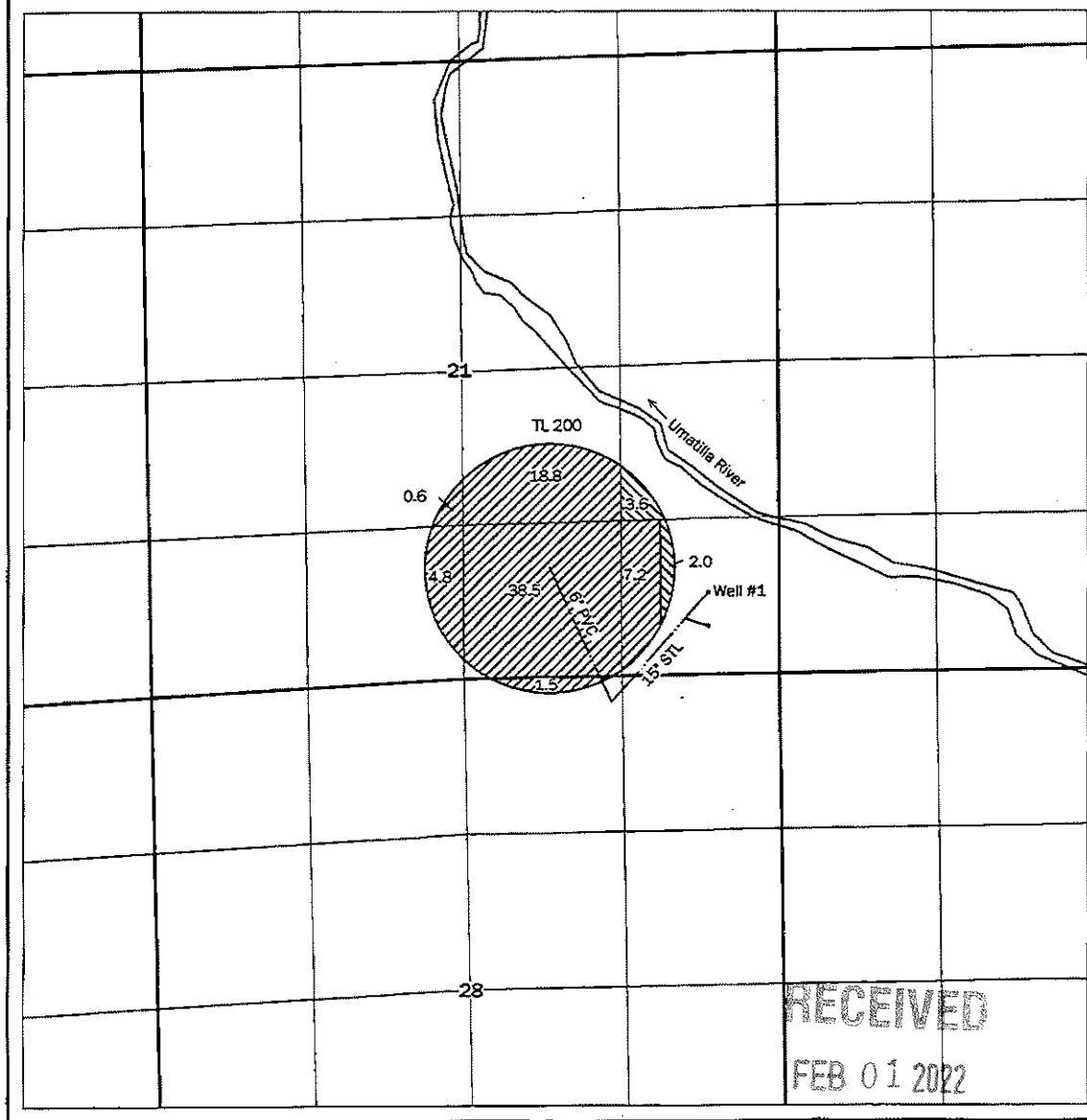

**Place of use Transfer
Certificate 81319**
Bales
T3N, R29E, W.M. Section 21
Umatilla County, Oregon
FROM Lands

- Legend**
- Buried Main Line
 - Wheel Line
 - 71.4 AC FROM Lands
 - Area not involved in this Transfer

Point of Appropriation
Well #1
Located 720' North and 530' West from the SE corner, section 21

Certified Water Rights Examiner Stamp

EXPIRES: 6/30/2022

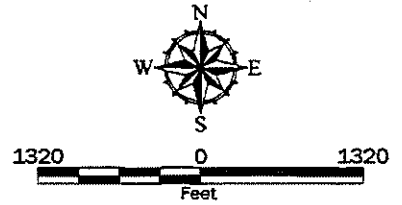

Disclaimer
This map was prepared for the purpose of identifying the location of a water right only and it is not intended to provide legal dimensions or location of property ownership lines.

Map Notes
Date: 09/31/21
Data Sources: ESRI
Prepared By: GeoEngineers



RECEIVED
FEB 01 2022
OWRD