

R42E
R43E



Quarter SE 1/4 SW 1/4
sec 31

Scale
1" = 1320'

RECEIVED

AUG 31 1998

WATER RESOURCES DEPT
SALEM, OREGON

LOSTIN

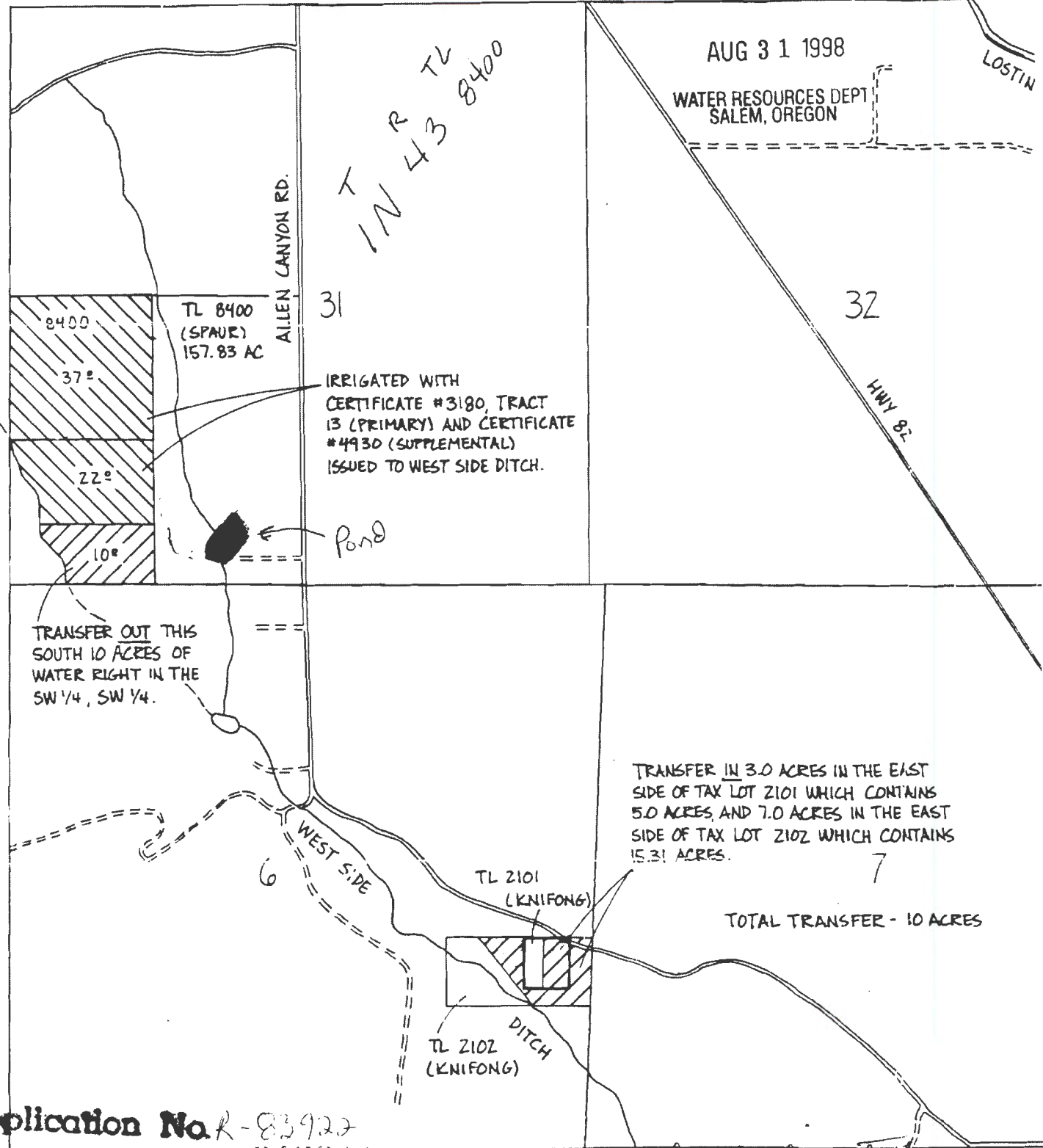

31

32

8400
37
22
10

TL 8400
(SPAUR)
157.83 AC

IRRIGATED WITH
CERTIFICATE #3180, TRACT
13 (PRIMARY) AND CERTIFICATE
#4930 (SUPPLEMENTAL)
ISSUED TO WEST SIDE DITCH.

Pond

TRANSFER OUT THIS
SOUTH 10 ACRES OF
WATER RIGHT IN THE
SW 1/4, SW 1/4.

TRANSFER IN 3.0 ACRES IN THE EAST
SIDE OF TAX LOT 2101 WHICH CONTAINS
5.0 ACRES, AND 7.0 ACRES IN THE EAST
SIDE OF TAX LOT 2102 WHICH CONTAINS
15.31 ACRES.

TOTAL TRANSFER - 10 ACRES

TL 2101
(KNIFONG)

TL 2102
(KNIFONG)

WEST SIDE
DITCH

Application No. R-83922

Permit No.

Small pond application
SFS of Ore. Vern Spaur
541-569-2352