

CLAIM of BENEFICIAL USE MAP

Transfer T-12397

In Name of
Glenn Chowning -
Terra Poma Land, LLC





T. 4N, R. 25 E.

Section 13

Morrow County

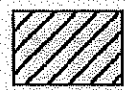
Scale 1" = 1320 Ft.

Legend: Acres Found Irrigated at The Following Locations

-  Permit #G-5952, Primary Irrigation
-  Permit #G-5953, Supplemental Irrigation
-  Permit #G-5953, Primary Irrigation
-  Permit #G-9811, Primary Irrigation (0.1 Only)

Hillview Well #4 - Located 3840 Ft. North & 2440 Ft. East from the South 1/4 of Section 13
SE 1/4 of NE 1/4 of Section 13, T. 4N, R. 25 E, WM
Lat. 45° 49' 53.037" North, Lon. 119° 37' 28.166" West (WGS84)

Hillview Sump #5 - Located 3800 Ft. North & 2460 Ft. East from the South 1/4 of Section 13
SE 1/4 of NE 1/4 of Section 13, T. 4N, R. 25 E, WM
Lat. 45° 49' 52.671" North, Lon. 119° 37' 27.242" West (WGS84)

Deep Well #2 - Located 330 Ft. North & 1310 Ft. East from the Center of Section 13
SW 1/4 of NE 1/4 of Section 13, T. 4N, R. 25 E, WM

Meter Located: North 72° East, 8.5' From Hillview Well #4,
North 55° 30' West, 70.0' From Hillview Sump #5
Lat. 45° 49' 53.062" North, Lon. 119° 37' 28.054" West (WGS84)

This Map is for the purpose
of identifying the location of
Water Rights only and is not
intended to provide the legal
dimensions or locations of
property ownership lines.

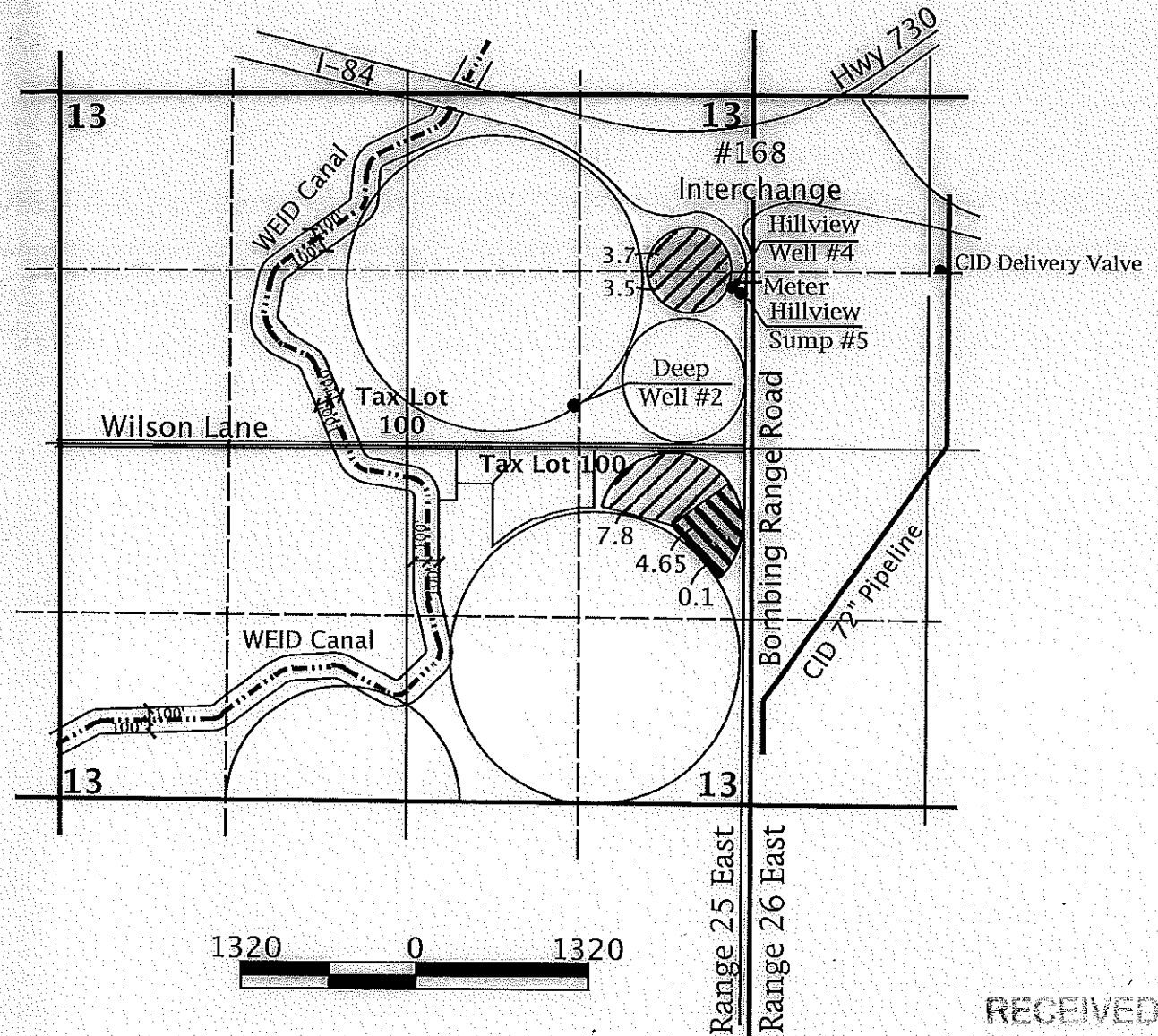

RECEIVED

JUL 16 2020

OWRD

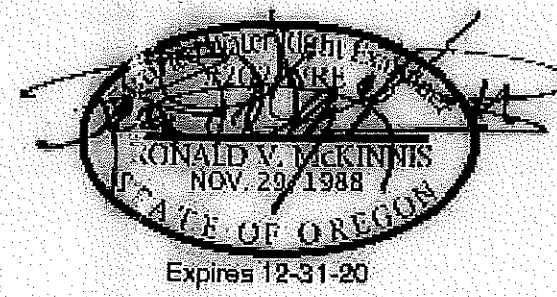

ENGINEERING - LAND SURVEYING - WATER RIGHTS

R. V. McKINNIS ENGINEERING

79980 Prindle Loop Road
Hermiston, Oregon 97838
(541) -567-2017

Rev. 07-12-2020