

CLAIM OF BENEFICIAL USE MAP

FOR: THOMAS & MARY MURPHY

MURPHY LIVING TRUST

BY: NATHAN R. REED, PE, CWRE

T28S, R7W, W.M. SECTION 34 DLC 53

APPLICATION NO. S-88083

PERMIT NO. S-54960

DATE SURVEYED: JUNE 9, 2020



RECEIVED

JUN 24 2020

OWRD

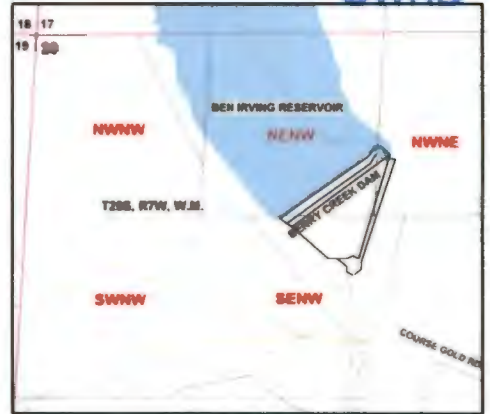
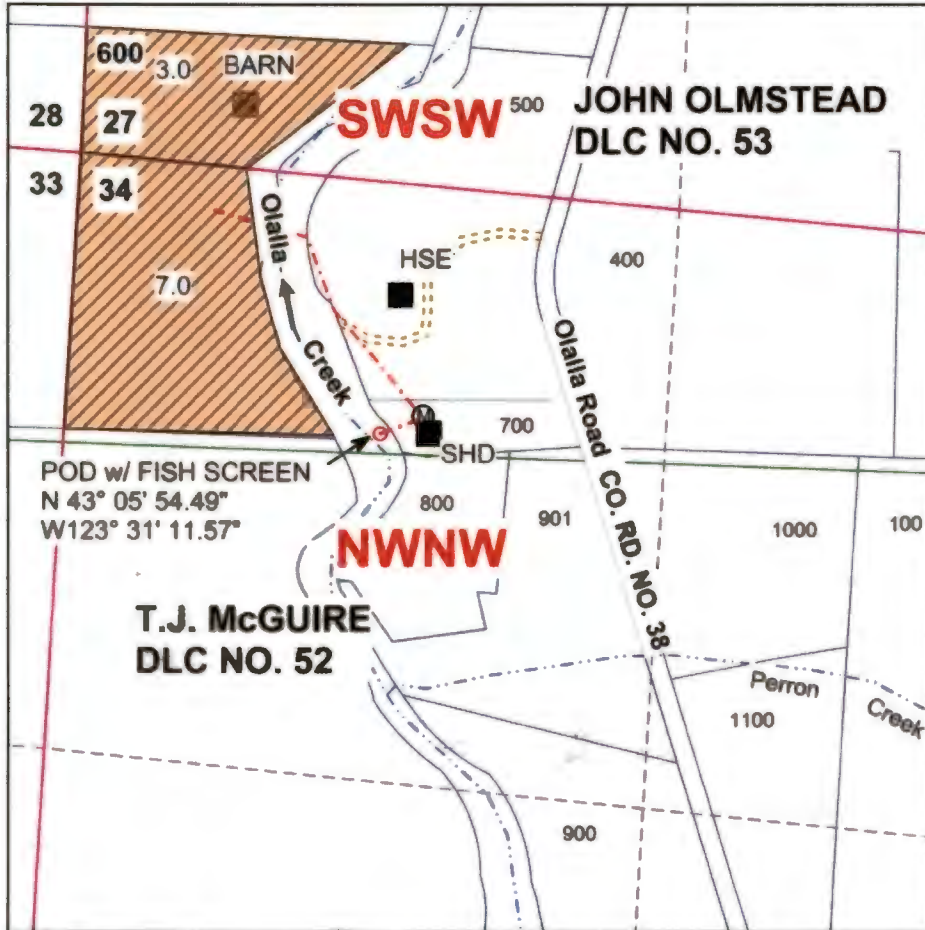

SCALE: 1" = 1320'

POD IS LOCATED 944 FEET NORTH AND 266 FEET WEST FROM THE C1/4 CORNER, SECTION 20.

RECEIVED

JUL 20 2020

OWRD

SCALE: 1" = 400'

POD IS RE-DIVERTED ON OLALLA CREEK, 593 FEET SOUTH AND 678 FEET EAST FROM NW CORNER, SECTION 34.

Legend

	Stream		Driveway		Section
	POD		Structures		Quarter
	Meter		Flow arrow		Sixteenth
	Pipeline		DLC		Parcels
			Irrigation		

THE PURPOSE OF THIS MAP IS TO IDENTIFY THE LOCATION OF THE WATER RIGHT. IT IS NOT INTENDED TO PROVIDE INFORMATION RELATIVE TO THE LOCATION OF PROPERTY OWNERSHIP BOUNDARY LINES.

MAP PREPARED FOR:
THOMAS & MARY MURPHY
1561 OLALLA ROAD
WINSTON, OR 97496



MAP PREPARED BY:
NATHAN R. REED, PE, CWRE
157 W. BODIE ST.
ROSEBURG, OR 97471