

CLAIM OF BENEFICIAL USE MAP

FOR: CHARLES & FRANCES ALLEN

RECEIVED BY OWRC

BY: NATHAN R. REED, CWRE

T27S, R6W, W.M. SECTION 16, DLC 50

APPLICATION NO. S-85198

PERMIT NO. S-53915

SEP 03 2015

SALEM, OR

DATE SURVEYED: AUGUST 29, 2015

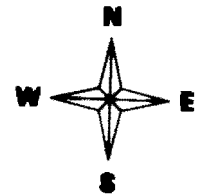

SCALE: 1" = 400'

POD IS LOCATED 1713 FEET NORTH AND 1059 FEET EAST FROM THE C 1/4, SECTION 16.

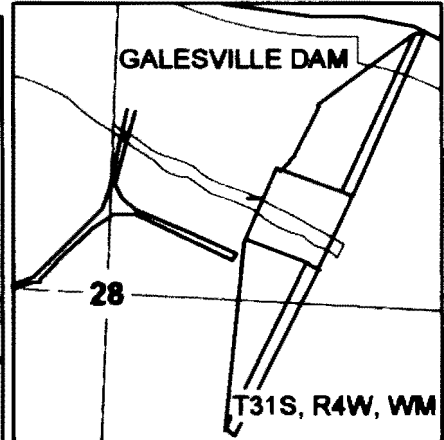
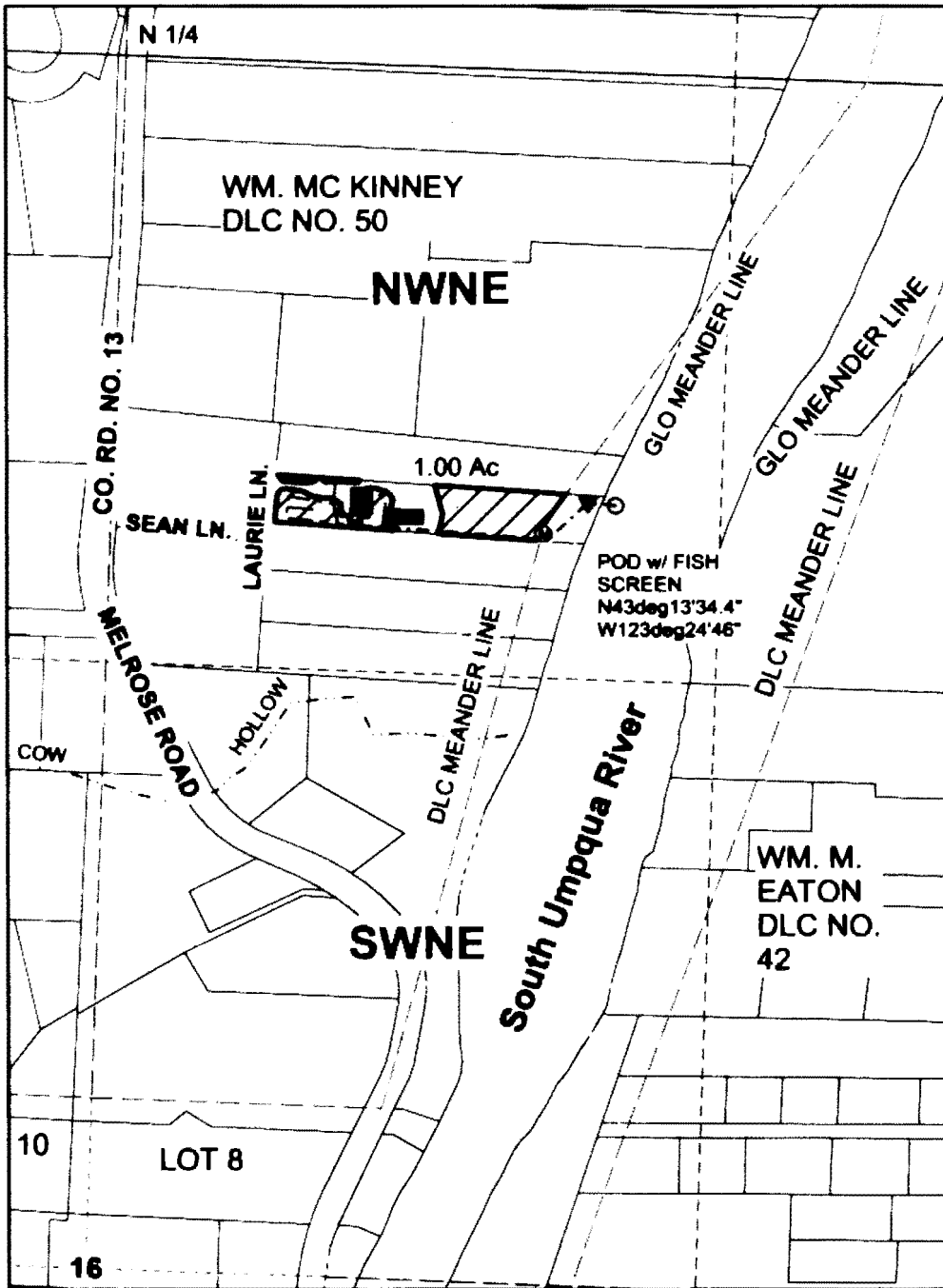

Legend

	POD		Flow Arrow
	PUMP		Meander
	Meter		Gov Lot
	1-1/2" PVC		DLC
	3/4" PVC		Section
	Irrigation		Quarter
	House & Shop		Sixteenth
	Stream		Parcels

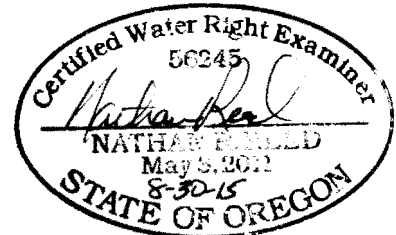

Expires Dec. 31, 2014

MAP PREPARED FOR:
CHARLES & FRANCES ALLEN
155 LAURIE LANE
ROSEBURG, OR 97471

MAP PREPARED BY:
NATHAN R. REED, P.E., CWRE
1113 SE CASS AV
ROSEBURG, OR 97470

THE PURPOSE OF THIS MAP IS TO IDENTIFY THE LOCATION OF THE WATER RIGHT. IT IS NOT INTENDED TO PROVIDE INFORMATION RELATIVE TO THE LOCATION OF PROPERTY OWNERSHIP BOUNDARY LINES.