

Portland\p:\0\0758077\00\Cad\Aleutian1.dwg SRB:MWJ 11/21/02

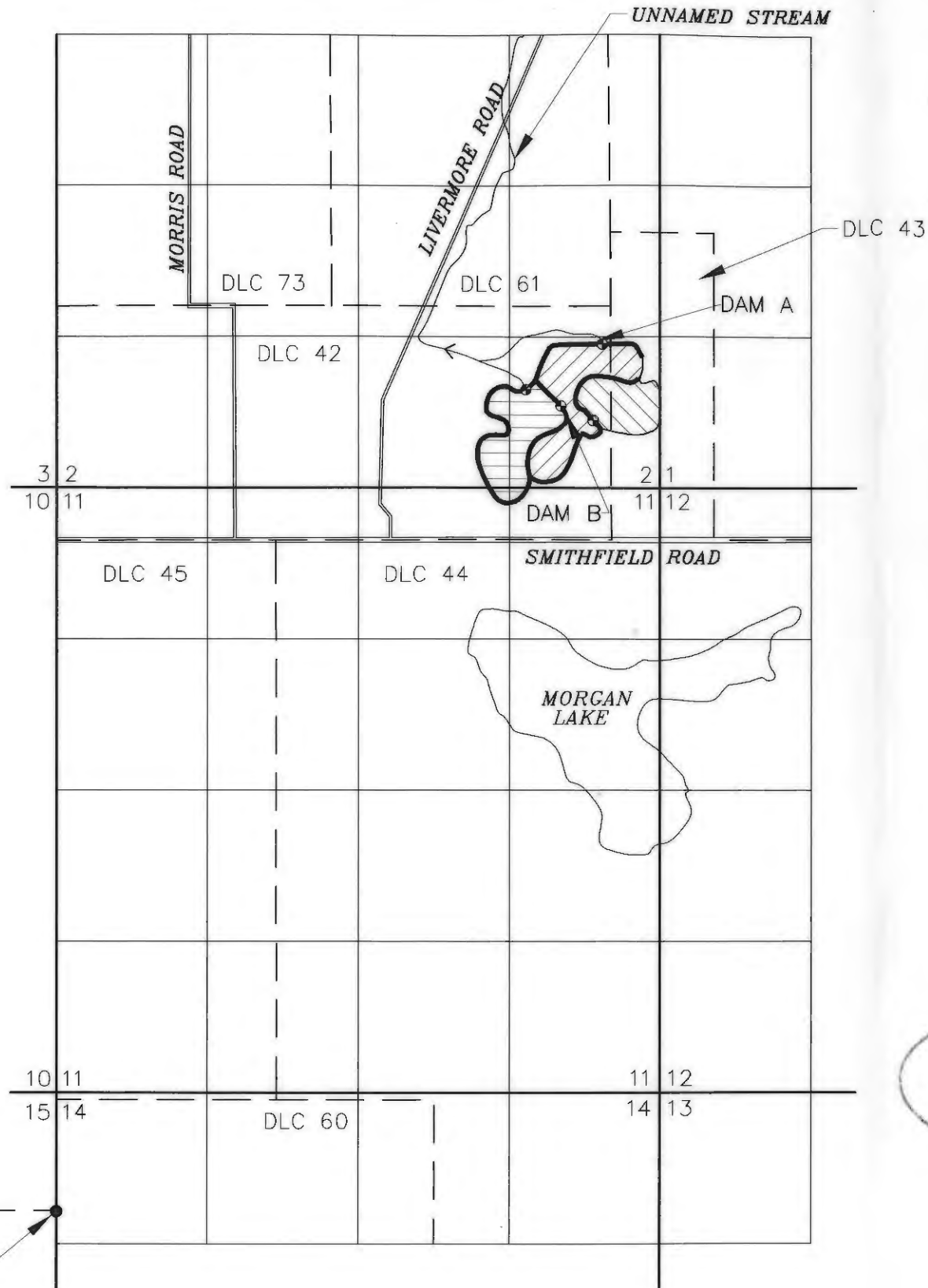







**TOWNSHIP 7 SOUTH, RANGE 5 WEST
SECTION 2**

**APPLICATION R-83770, PERMIT R-12546
APPLICATION R-83771, PERMIT R-12545
APPLICATION R-83772, PERMIT R-12544
ALEUTIAN MARSH I, II, III
BASKETT SLOUGH NATIONAL WILDLIFE REFUGE**



1 INCH = 1320 FEET

EXPLANATION:

-  ALEUTIAN MARSH I
(APPLICATION R-83770, PERMIT R-12546)
-  ALEUTIAN MARSH II
(APPLICATION R-83771, PERMIT R-12545)
-  ALEUTIAN MARSH III
(APPLICATION R-83772, PERMIT R-12544)
-  POINT OF DIVERSION (POD)
-  DLC BOUNDARY
-  DAM

RECEIVED

NOV 25 2002

WATER RESOURCES DEPT.
SALEM, OREGON

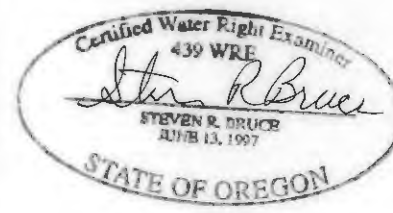

NOTES:

1. Aleutian Marsh I POD located 860 feet north and 1,170 feet west of southeast corner of Section 2.
2. Aleutian Marsh II POD at Dam A located 1,260 feet north 500 feet west of southeast corner of Section 2.
3. Aleutian Marsh II POD at Dam B located 720 feet north and 870 feet west of southeast corner of Section 2.
4. Aleutian Marsh III POD located 590 feet north and 580 feet west of southeast corner Section 2.
5. Survey completed on September 16 and 17, 2002.

THE PURPOSE OF THIS MAP IS TO IDENTIFY THE LOCATION OF THE WATER RIGHT. IT IS NOT INTENDED TO PROVIDE INFORMATION RELATIVE TO THE LOCATION OF PROPERTY OWNERSHIP BOUNDARY LINES.



**CLAIM OF BENEFICIAL USE MAP
U.S. FISH AND WILDLIFE SERVICE**

FIGURE 1