

FINAL PROOF SURVEY MAP

IN THE NAME OF DALE OR SONYA HAWORTH

SECTION 22, TOWNSHIP 29 SOUTH, RANGE 12 WEST, W.M.

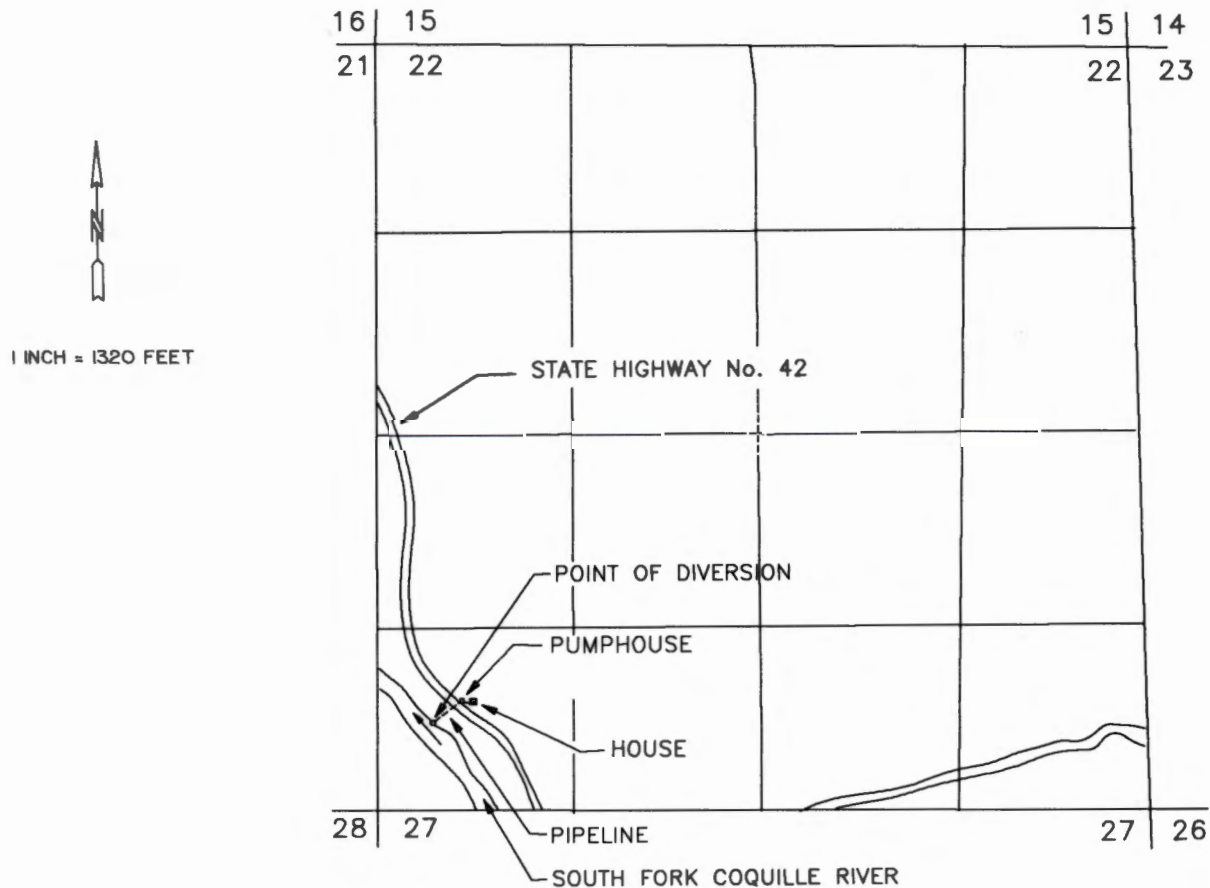

THE POINT OF DIVERSION IS LOCATED 580 FEET NORTH AND 390 FEET EAST FROM THE SOUTHWEST CORNER OF SECTION 22, BEING WITHIN THE SW 1/4 OF THE SW 1/4 OF SECTION 22, TOWNSHIP 29 SOUTH, RANGE 12 WEST, W.M., COOS COUNTY.

THE PURPOSE OF THIS MAP IS TO IDENTIFY THE LOCATION OF THE WATER RIGHT. IT IS NOT INTENDED TO PROVIDE INFORMATION RELATIVE TO THE LOCATION OF PROPERTY OWNERSHIP BOUNDARY LINES.

