

0431

**Beneficial Use Claim for  
Luckiamute Domestic Water Cooperative**

Application #: G-4938 Permit #: G-4480  
Well #1 is located 62.3'S & 3,346.9'E from SW corner DLC 40.

**Map Legend**

Scale in miles  
0 1 2 3

- State Highway
- Paved Road or Primary City Street
- Gravel Road
- Other Road or City Street
- Urban Growth Boundary
- City Limits
- Address Grid Numbers
- Rural Schools

Projection: Oregon State Plane NAD 83/91      Map Created: 08/01/01

These maps were produced from the Polk County roads, water, railroad, and section geographic databases. The data originally came from USGS quad maps, SPOT 1993 satellite imagery, and the County Road Index Map. The data is maintained by the county to support its governmental activities. The county is not responsible for any map errors, possible misuse, or misinterpretation. To report a map error, please call (503)623-0713.

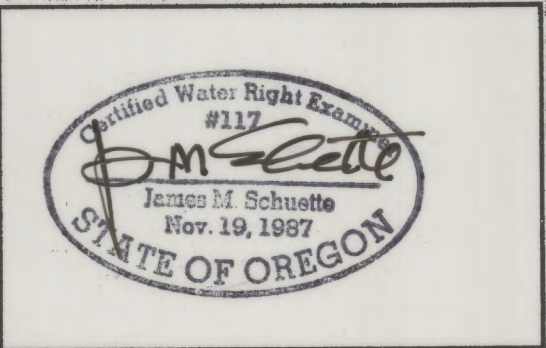

**This Map was Prepared for the Purpose of Identifying the Location of a Water Right Only and is Not Intended to Provide Legal Dimensions or Location of Property Ownership Lines.**

**LDWC Storage Reservoirs**

Reservoir	Size (gallons)	Name
● #1	60,000	Brateng Rd. Reservoir
● #2	50,000	W. Fern Corner Reservoir
● #3	300,000	Rolling Hills Reservoir
● #4	30,000	E. Fern Corner Reservoirs
● #5	50,000	Fisher Reservoir
● #6	50,000	Dixon Reservoir
● #7	50,000	Oak Hills Reservoir
● #8	125,000	Dilling (Smith) Reservoir
● #9	50,000	Gilliam Reservoir
● #10	20,000	Pedee Reservoir
● #11	20,000	Close Reservoir
● #12	250,000	Zumwalt Reservoir
● #13	250,000	Upper Fishback Reservoir
	<b>1,305,000</b>	

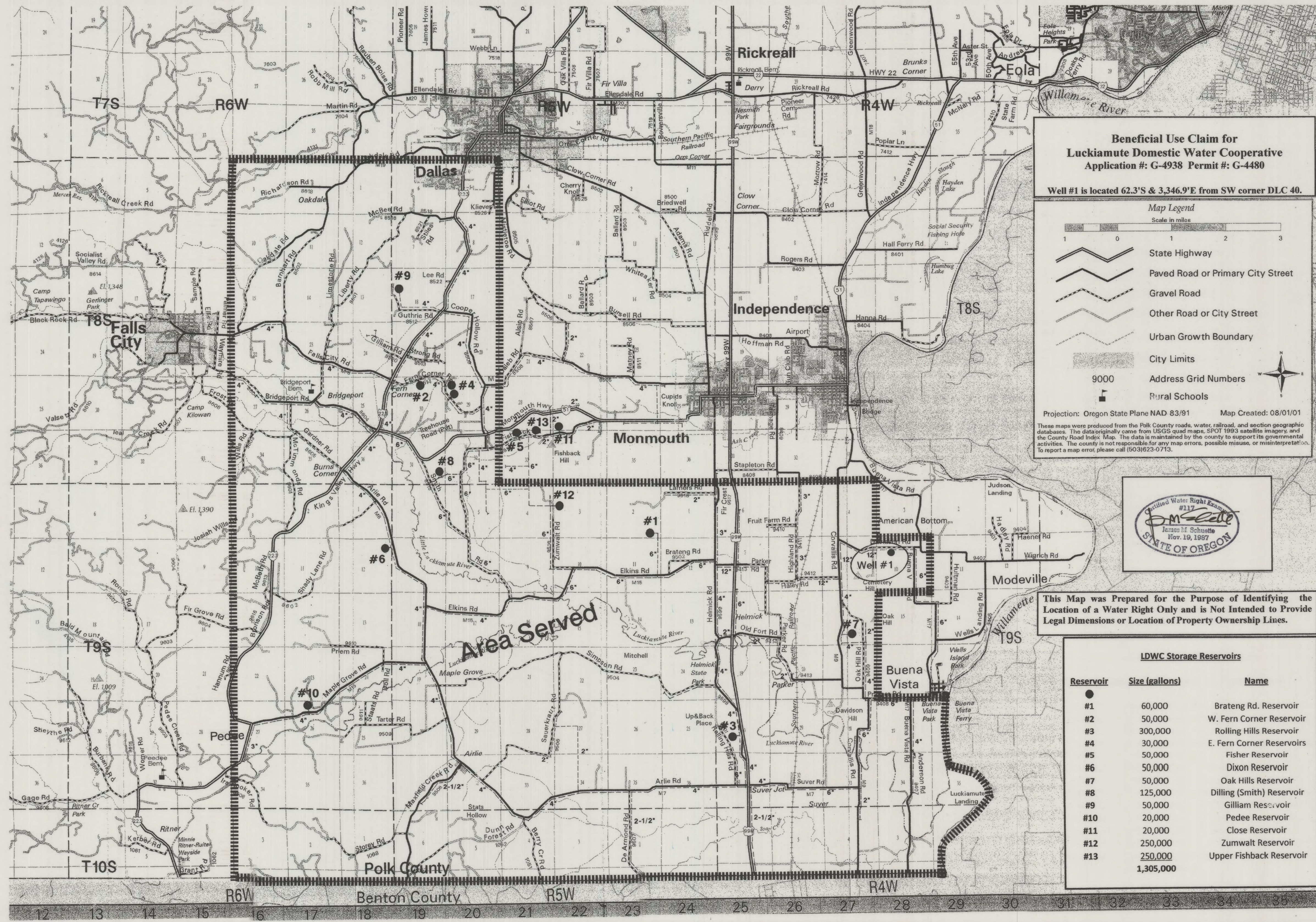

0431