

**Claim of Beneficial Use
Point of Diversion Map
Permit S-54973**

(Application S-88099)
A Water Right in the Name of Kylix
Vineyards Oregon LLC
Douglas County
Township 29 South, Range 7 West
(W.M.)

COBU MAP #2017(A)

LEGEND

- Point of Diversion
- Ben Irving Dam
- Government Lot (GL)
- Donation Land Claim (DLC)
- Tax Lot
- Railroad
- Watercourse
- Waterbody

RECEIVED

MAR 30 2022

OWRD

CERTIFIED WATER RIGHTS EXAMINER STAMP

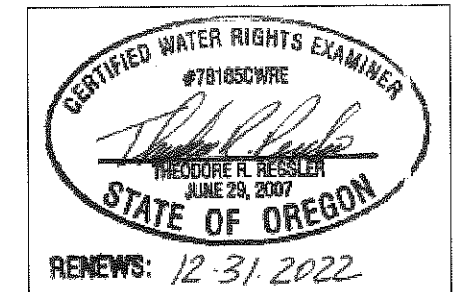

DISCLAIMER

This map was prepared for the purpose of identifying the location of a water right only and it is not intended to provide legal dimensions or location of property ownership lines.

LOCATION DESCRIPTION

Point of Diversion
Located 1,080 feet South and 2,080 feet East from the NW corner of Section 20, Township 29 South, Range 7 West (W.M.)

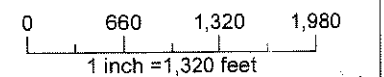
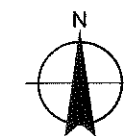

Date: August 4, 2021
Data Sources: BLM, ESRI, ODOT, USGS,
Douglas Co.



COBU MAP #2017(A)

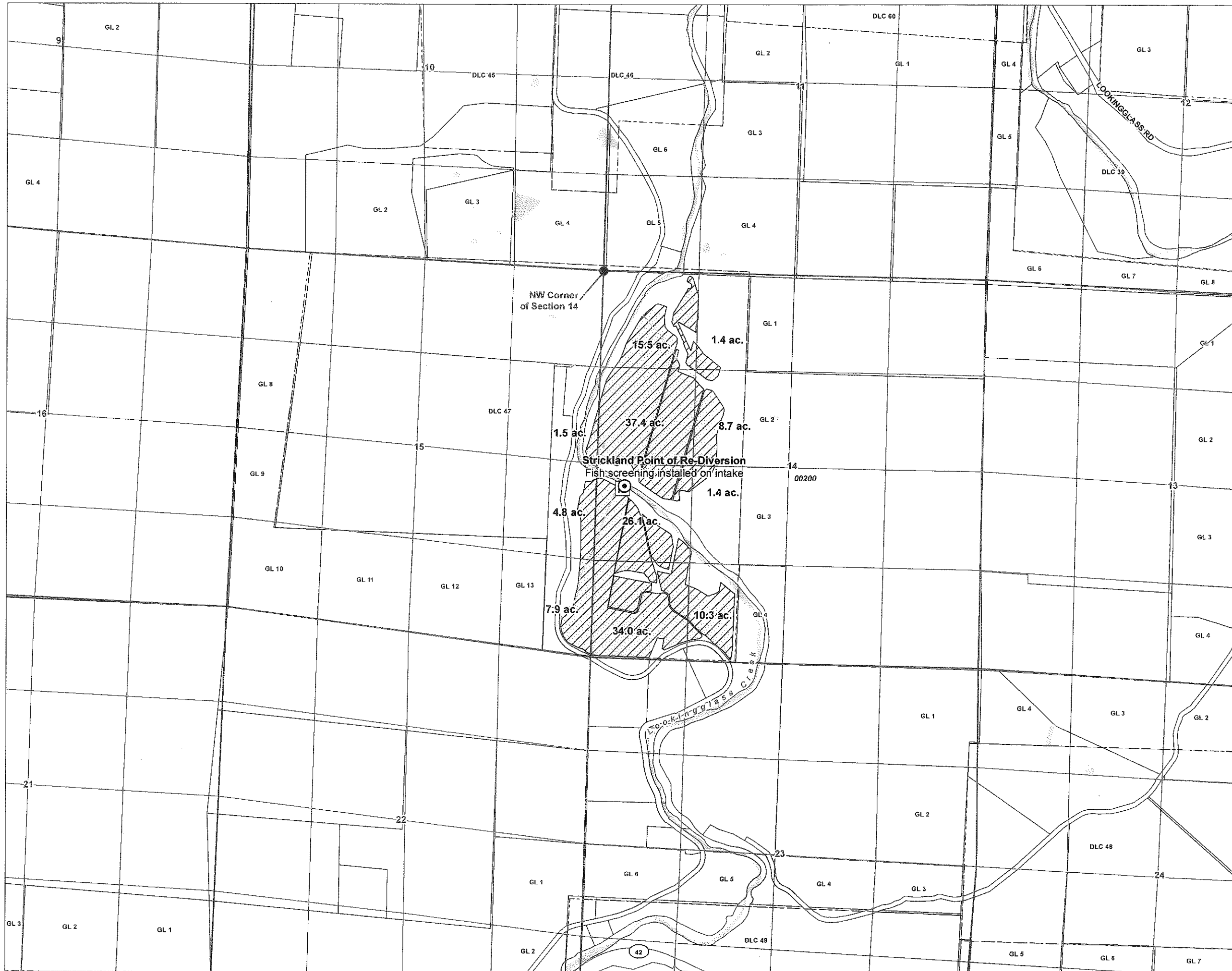

**Claim of Beneficial Use
Point of Re-Diversion and Place
of Use Map**
Permit S-54973
(Application S-88099)
A Water Right in the Name of Kylix
Vineyards Oregon LLC
Douglas County
Township 29 South, Range 7 West
(W.M.)

LEGEND *COBU MAP #2017(B)*

- Point of Re-Diversion
- Totalizing Flow Meter
- Place of Use (POU)
- Government Lot (GL)
- Donation Land Claim (DLC)
- Tax Lot
- Railroad
- Watercourse
- Waterbody

RECEIVED
MAR 30 2022
OWRD

CERTIFIED WATER RIGHTS EXAMINER STAMP

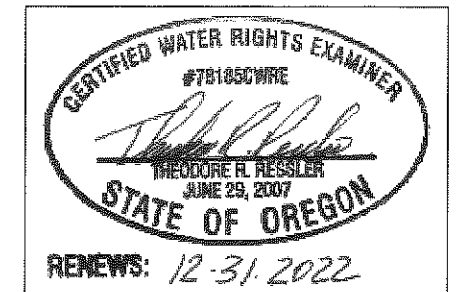

DISCLAIMER

This map was prepared for the purpose of identifying the location of a water right only and it is not intended to provide legal dimensions or location of property ownership lines.

LOCATION DESCRIPTION

Strickland Point of Re-Diversion
Located 2,910 feet South and 390 feet East from the NW corner of Section 14, Township 29 South, Range 7 West (W.M.)

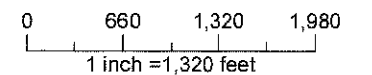
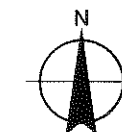

Date: August 4, 2021
Data Sources: BLM, ESRI, ODOT, USGS,
Douglas Co.



COBU MAP #2017(B)