

# T.5S. R.1W. Section 1, W.M.

Well 1 (CLAC 2012) is located 1,120 feet north and 585 feet east from the SW corner, Section 1.

Well 3 (CLAC 60252) is located 835 feet north and 895 feet east from the SW corner, Section 1.

 Area (12.7 Acres) of agricultural use (nursery use) and irrigation under Application G-14202, Permit G-12926.

RECEIVED

JUL 14 2022



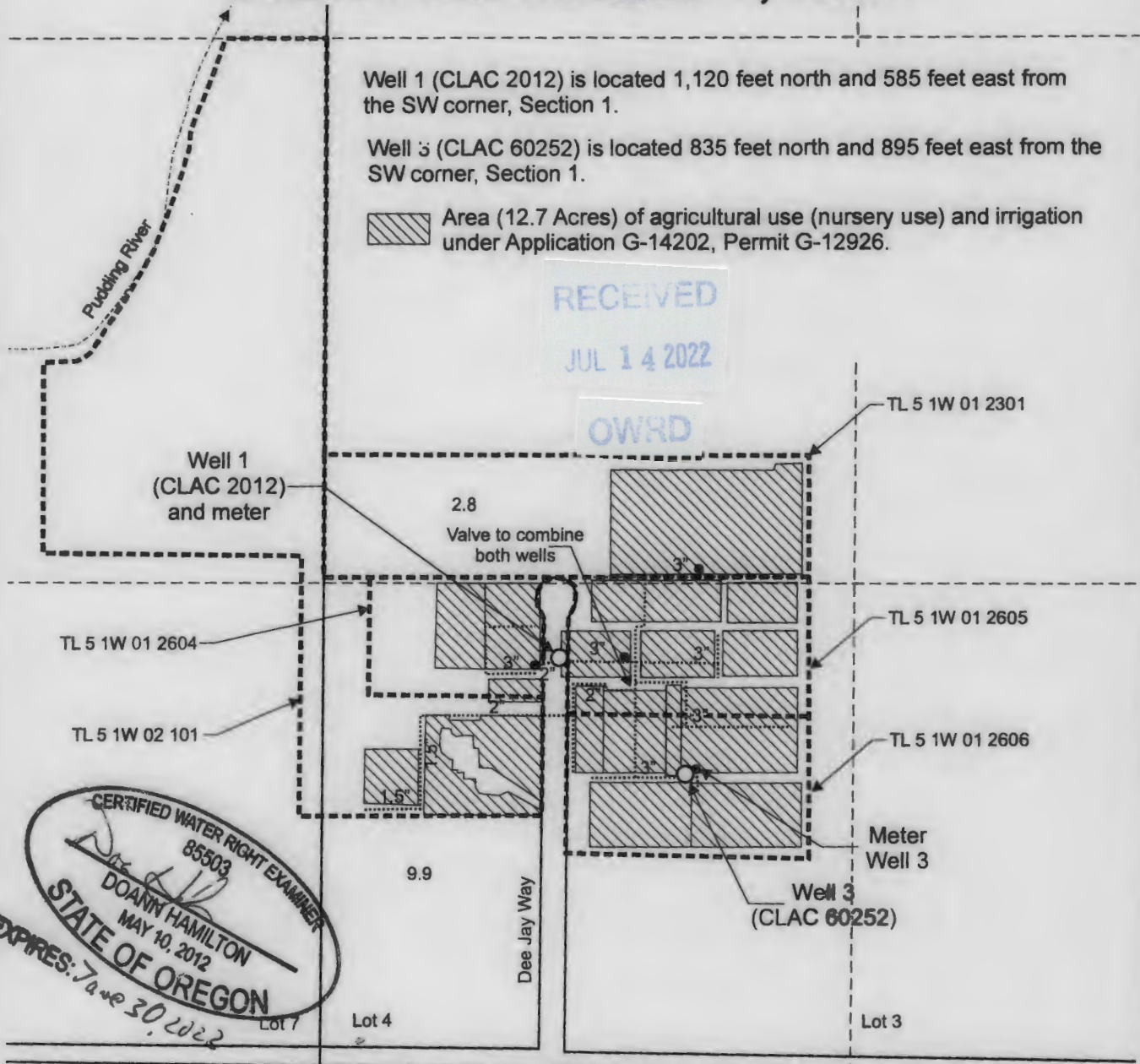

OWRD



CERTIFIED WATER RIGHT EXAMINER  
85503  
DOANN HAMILTON  
MAY 10, 2012  
STATE OF OREGON  
EXPIRES: June 30, 2022

2 1  
11 12

S. Sconce Rd

-  Donation Land Claim boundary
-  Tax lot boundary
-  Irrigation mainlines
-  Injection locations

Scale: 1" = 400'

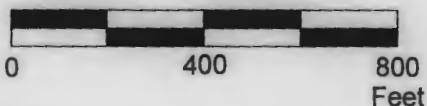

This map was prepared for the purpose of identifying the location of a water right only and is not intended to provide legal dimensions or location of property ownership lines.



Claim of Beneficial Use Map  
Application G-14202, Permit G-12926

Pacific Hydro-Geology Inc.

Al's Garden and Greenhouse, LLC  
T.5S. R.1W. Section 1, W.M.

07/2022