

T. 26 S., R. 16 E., W. M.

T. 26 S., R. 16 E., W. M.

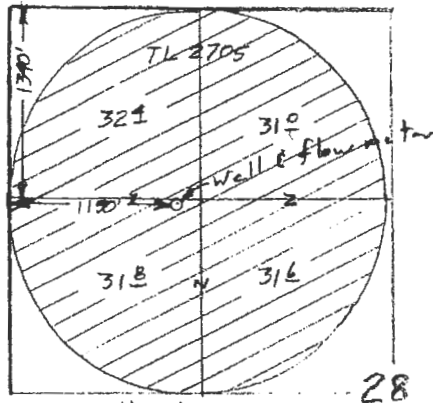

Horton

- ⊗ (C-54250) 126<sup>8</sup> acres + 32 acres
- ⊗ (C-76671) 19<sup>8</sup> acres + 25 acres  
(Eide) (Horton)
- ⊗ (C-76578) 20<sup>8</sup> acres  
(Eide)

Transfer T-938B



Scale 1" = 1320'  
(4" = 1 mile)

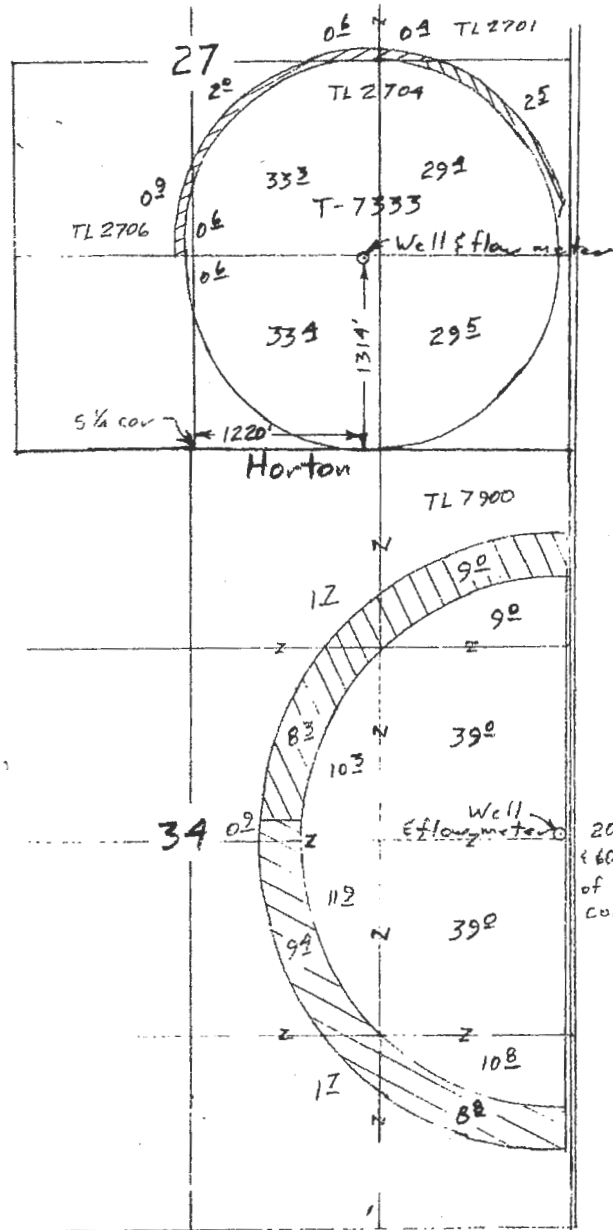

Horton

Eide

Surveyed July 3, 2009

Claim of Beneficial Use Map

for

Lee Roy Horton  
& Phil Eide

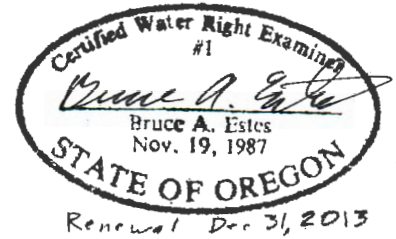

**ESTES SURVEYS, LLC**

~~PO Box 17519~~ 60382 Arnold Rd  
~~Salem, OR 97305-7519~~ Bend, OR 97702  
~~(503) 586-7600~~ (541) 382-7391

This map is for the purpose of  
 locating a water right only  
 and has no intent to provide  
 legal dimensions or the location  
 of property lines.