

T. 26S., R. 16E., W.M.

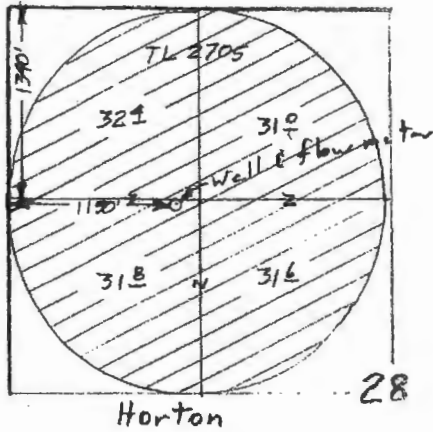

Horton

- ⊗ (C-54250) 126⁸ acres + 3² acres
- ⊗ (C-76671) 19⁸ acres + 2⁵ acres
(Eide) (Horton)
- ⊗ (C-76578) 20⁸ acres
(Eide)

Transfer T-938B



Scale 1" = 1320'
(4" = 1 mile)

T. 26S., R. 16E., W.M.

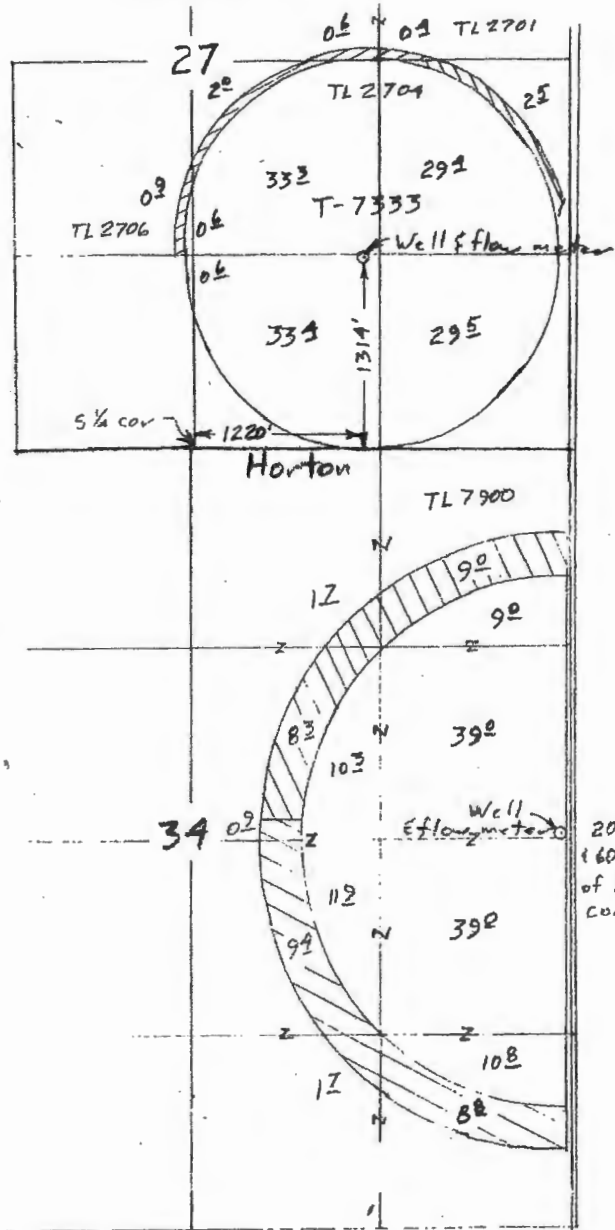

Horton

Eide

Surveyed July 3, 2009

Claim of Beneficial Use Map
for
Lee Roy Horton
& Phil Eide

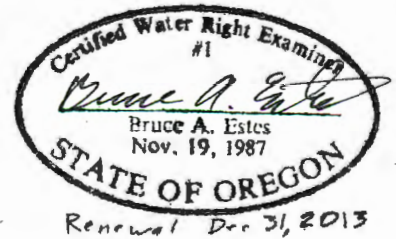

ESTES SURVEYS, LLC

~~PO Box 17519~~ 60382 Arnold Rd
Salem, OR 97305-7519 Bend, OR 97702
~~(503) 585-7699~~ (541) 382-7391

This map is for the purpose of locating a water right only and has no intent to provide legal dimensions or the location of property lines.