

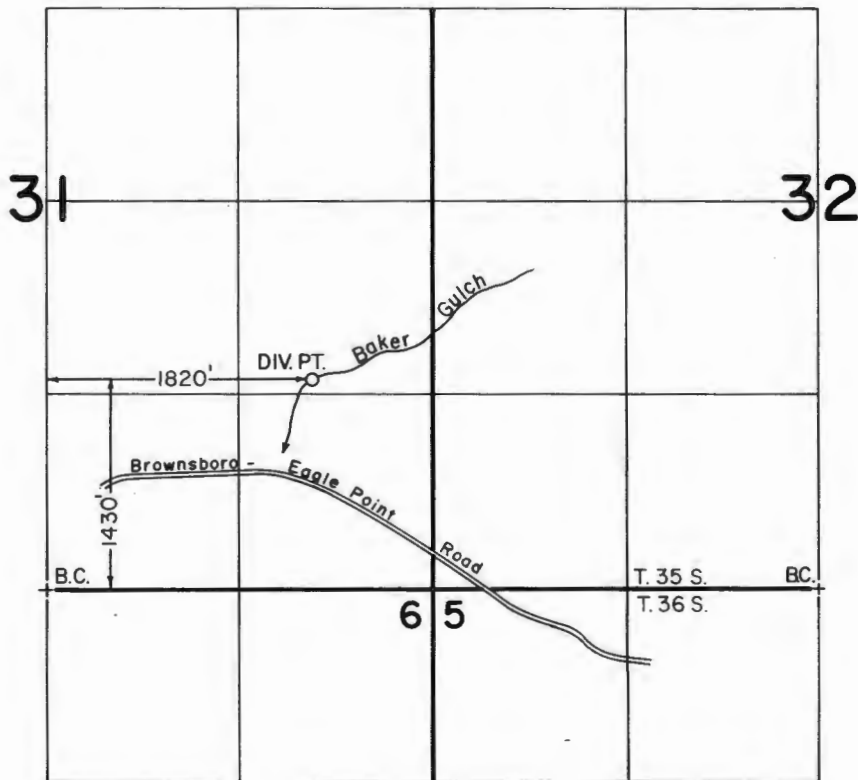

T. 35 & 36 S., R. 1 E., W.M.



SCALE: 1" = 1320'

FINAL PROOF SURVEY

UNDER

TRANSFER NO. 5170

TRANSFER NO. 4882

Application No. Permit No.

IN NAME OF

JIMMY LEE & JUDY E. DENNY - STEPHEN HARBISON

Surveyed AUG. 23, 1989, by B. S. JAMES.....