

- LEGEND**
- ⊙ Authorized Point of Diversion (POD)
  - Waterline
  - ▨ Portion of Authorized Place of Use Involved in the Allocation of Conserved Water (2,374.5 ac)
  - ▩ Remaining Portion of Authorized Place of Use (596.8 ac.)
  - Major Road
  - ▭ City Boundary
  - ▭ County Boundary
  - ▭ Government Lot (GL)
  - Watercourse
  - Waterbody

**LOCATION DESCRIPTION**  
**Amstad Diversion**  
 Located 2,270 feet North and 940 feet East from SW corner,  
 Section 13, Township 5 North, Range 27 East (WM)

**Allocation of Conserved Water**  
**Certificate 53731 (Permit S-37108)**  
**A Water Right held by Onyx Land Company, LLC**  
 Township 5 North, Range 27, 28 East (W.M.)  
 Umatilla County

**DISCLAIMER**  
 This map was prepared for the purpose of identifying the location of a water right only and it is not intended to provide legal dimensions or location of property ownership lines.

Date: November 23, 2021  
 Data Sources: BLM, ESRI, OWRD, USGS, Umatilla Co., Gimmway Enterprises

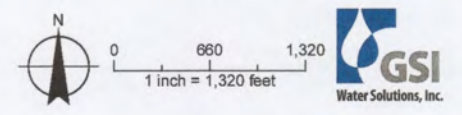

CW-126