

**T22S R32E, WM,
HARNEY COUNTY, OR**

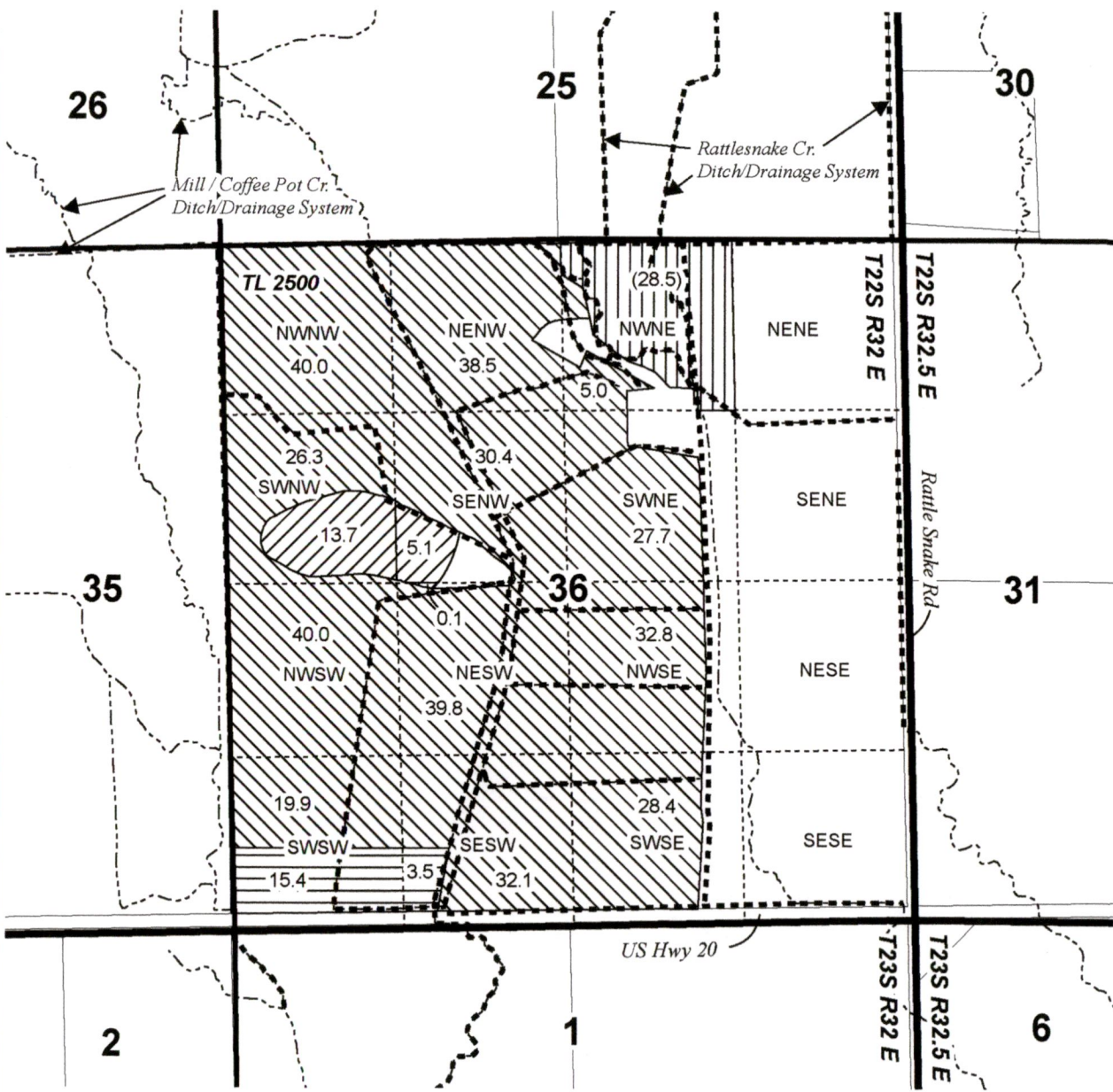

- Ditch
- Creek / Natural Drainage
- POU (IS) C-20699 12/31/1884 "NO CHANGE"
- POU IR C-20699 12/31/1884 "NO CHANGE"
- POU IR C-20699 12/31/1884 "ON"
- POU IR C-20699 12/31/1884 "OFF"
- Township
- Section
- Quarter Quarter
- Tax Lot

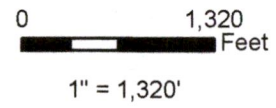
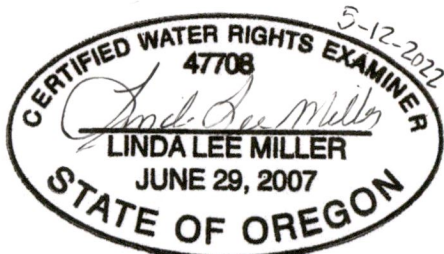

RECEIVED

RENEWAL DATE 12/31/2022

**PERMANENT TRANSFER MAP
SCHOTT**

Certificate 20699

Date: 5/12/2022

This map is not intended to provide legal dimensions or locations of property ownership lines.

ON 10 2022

OWRD

WATER RIGHT SERVICES, LLC

PO BOX 1830, BEND, OR 97709
WWW.OREGONWATER.US CCB # 197121
johnshort@usa.com 541-389-2837