



LEGEND

- Place of Use (POU)
- Donation Land Claim (DLC)
- Permanent Conveyance Line
- Temporary Conveyance Line
- Tax Lot
- Watercourse
- Waterbody

**Claim of Beneficial Use for Transfer T-8527
in the Name of City of Philomath**

Place of Use

Township 12 South, Range 5 & 6 West (W.M.)

CERTIFIED WATER RIGHTS EXAMINER STAMP

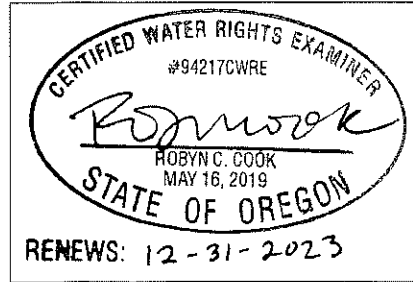

RECEIVED
NOV 07 2022
OWRD

DISCLAIMER
This map was prepared for the purpose of identifying the location of a water right only and it is not intended to provide legal dimensions or location of property ownership lines.

Date: October 19, 2022
Data Sources: BLM, ESRI, OWRD, USGS

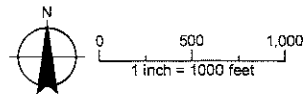

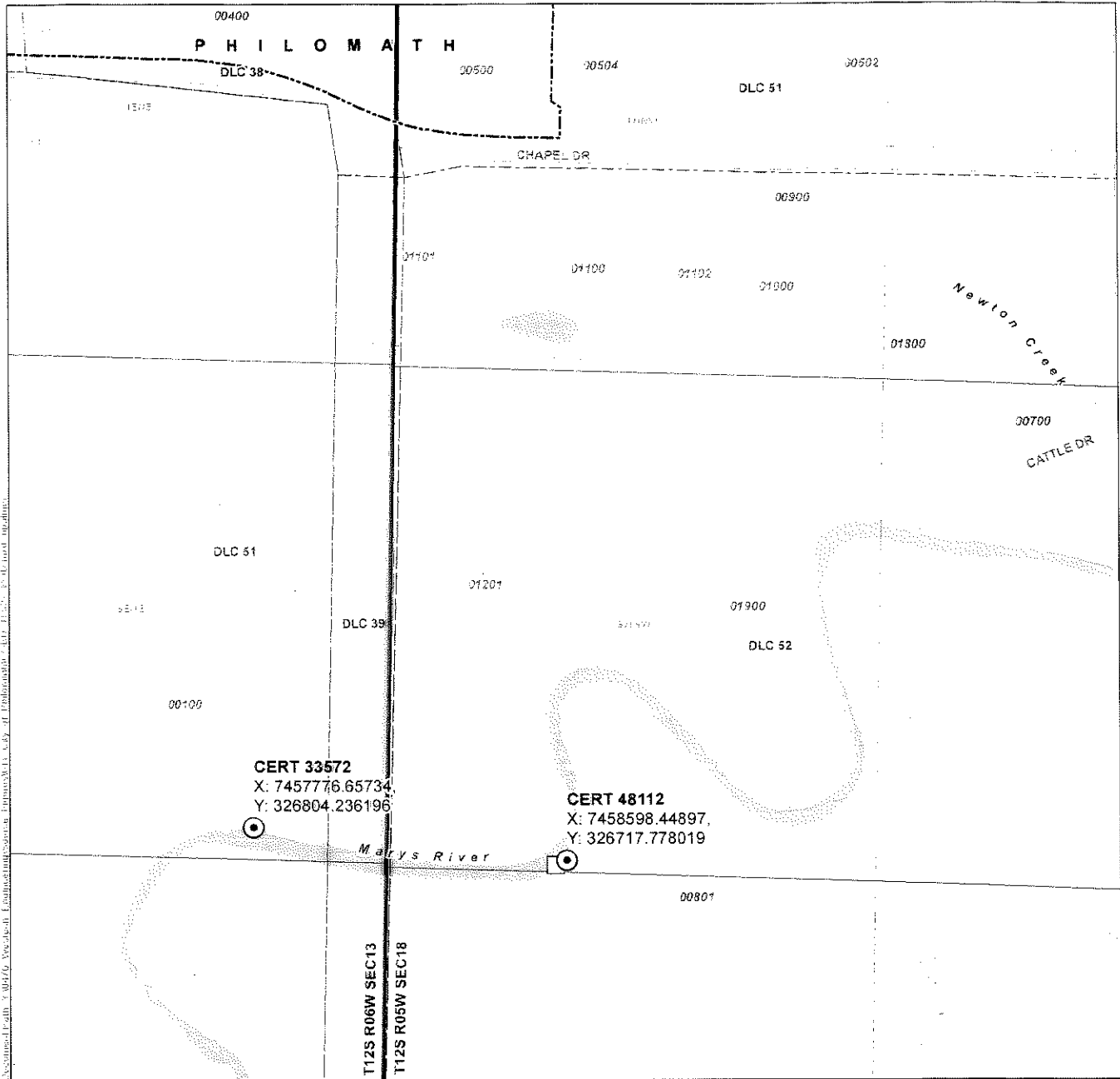

LEGEND

- Authorized Point of Diversion (POD) and Meter
- City Boundary
- Fish Screen
- Watercourse
- Tax Lot
- Waterbody
- Donation Land Claim (DLC)

**Claim of Beneficial Use for Transfer T-8527
in the Name of City of Philomath**

Point of Diversion

Township 12 South, Range 5 & 6 West (W.M.)

CERTIFIED WATER RIGHTS EXAMINER STAMP

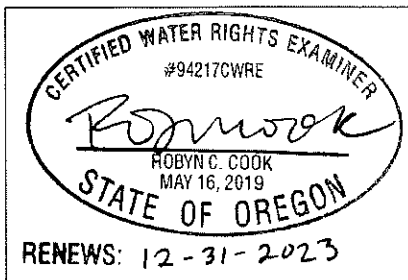

RECEIVED
NOV 07 2022
OWRD

LOCATION DESCRIPTION

Cert 48112
Located 1,840 feet South and 630 feet East from the NW corner of DLC 52, Township 12 South, Range 5 West (W.M.)
Cert 33572
Located 1,730 feet South and 330 feet West from the NW corner of DLC 52, Township 12 South, Range 6 West (W.M.)

DISCLAIMER
This map was prepared for the purpose of identifying the location of a water right only and it is not intended to provide legal dimensions or location of property ownership lines.

Date: October 17, 2022
Data Sources: BLM, ESRI, OWRD, USGS

