

# T6S R1E, WM

CLACKAMAS COUNTY

TAX LOT:  
6S 1E 5 1900

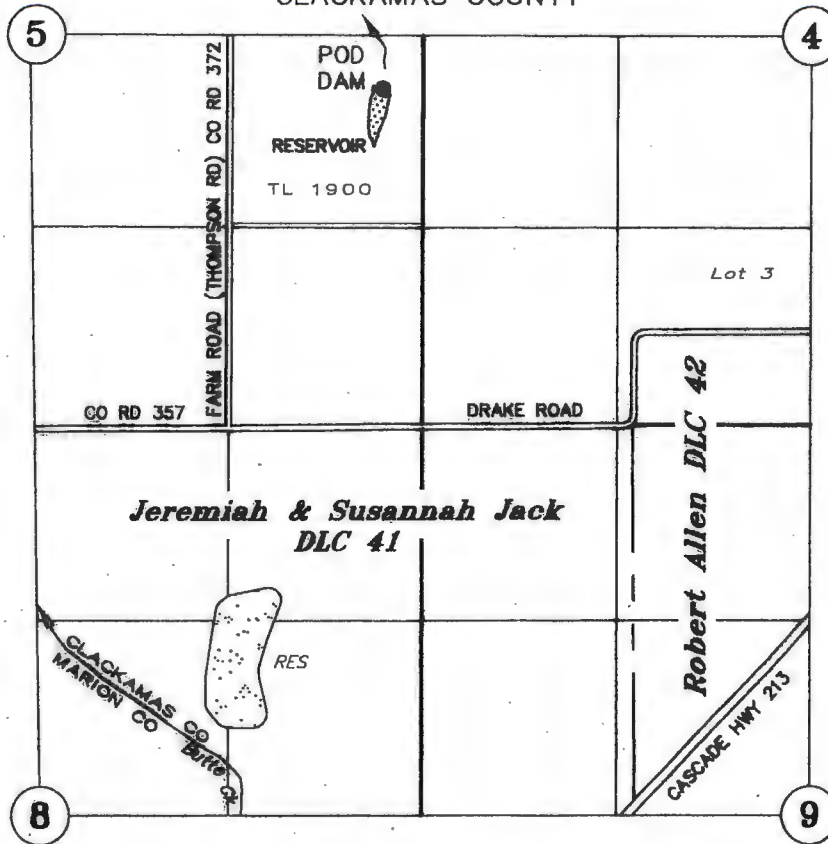

POD: 2293' N & 270' W OF SE COR SEC 5

## CLAIM OF BENEFICIAL USE

UNDER

Application No. R-85287

Permit No. R-13890

IN THE NAME OF

**VICTOR SCHNEIDER, JR**

September 24, 2010 & August 23, 2018

SCALE: 1" = 1320'

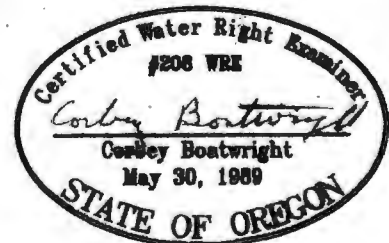

NOTE: This map is not intended to provide legal dimensions or locations of property ownership lines.

RENEWAL DATE: DECEMBER 31, 2021