

Application for an Allocation of Conserved Water
 Certificates 53090 and 66607

OWRD RECEIVED
 courchca, 10/10/2023, 1:16:53 PM

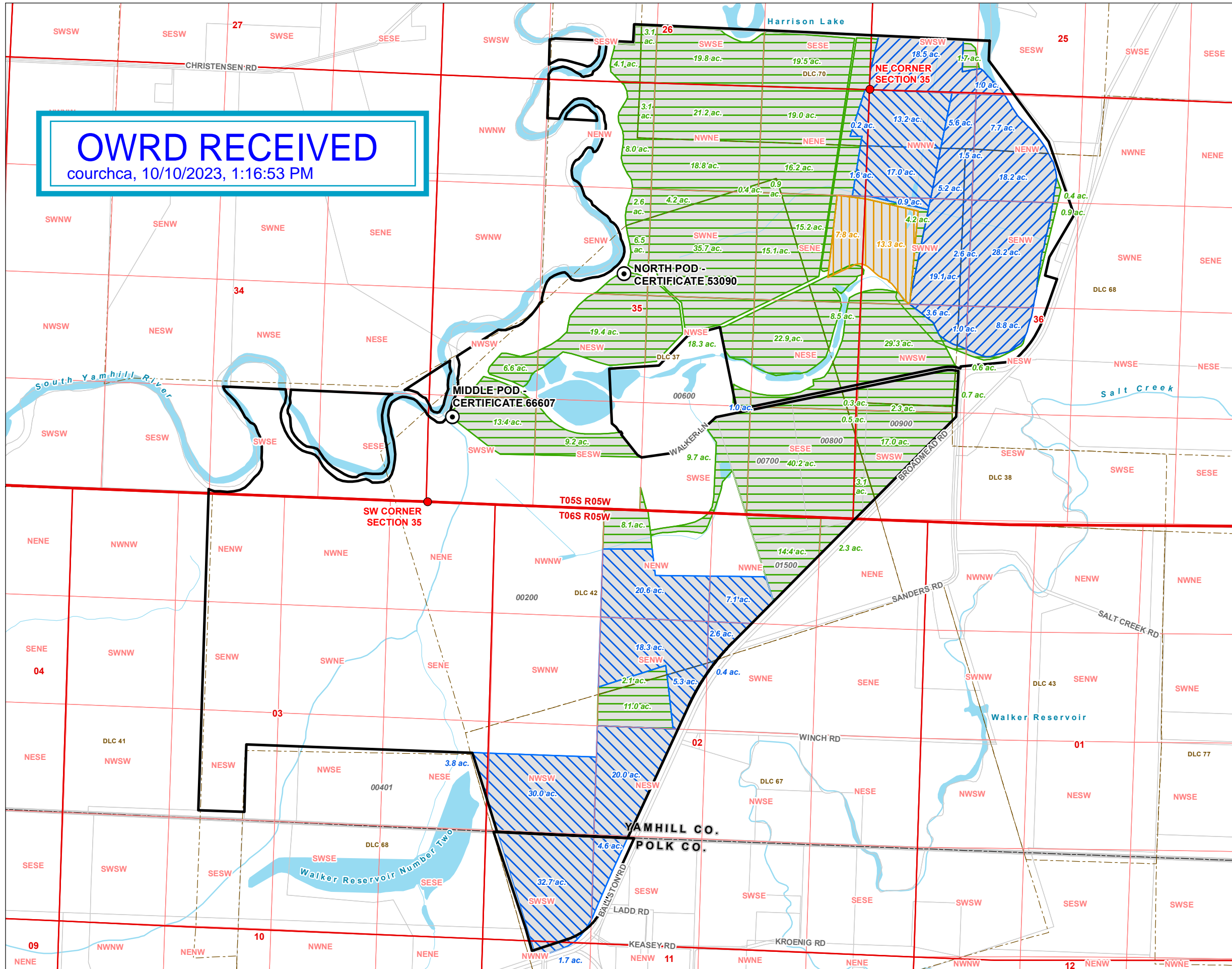

LEGEND

- Point of Diversion (POD)
 - Certificate 53090: To be Included in the Allocation of Conserved Water
 - Certificate 66607: Portion to be Included in the Allocation of Conserved Water
 - Certificate 66607: Portion Not Included in the Allocation of Conserved Water
 - Proposed New Out-of-Stream Use: Irrigation
- All Other Features**
- Amity Property
 - County Line
 - Tax Lot
 - Donation Land Claim (DLC)
 - Watercourse
 - Waterbody

LOCATION DESCRIPTION

North POD
 Located 2360 feet South and 2950 feet West from NE corner of Section 35, Township 5 South, Range 5 West (W.M.)

Middle POD
 Located 1050 feet North and 300 feet East from SW corner of Section 35, Township 5 South, Range 5 West (W.M.)

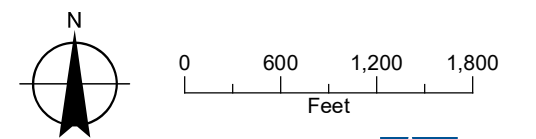

Date: October 10, 2023
 Data Sources: Maxar Photo 2019, ESRI, BLM, Yamhill Co., Polk Co., UGSG

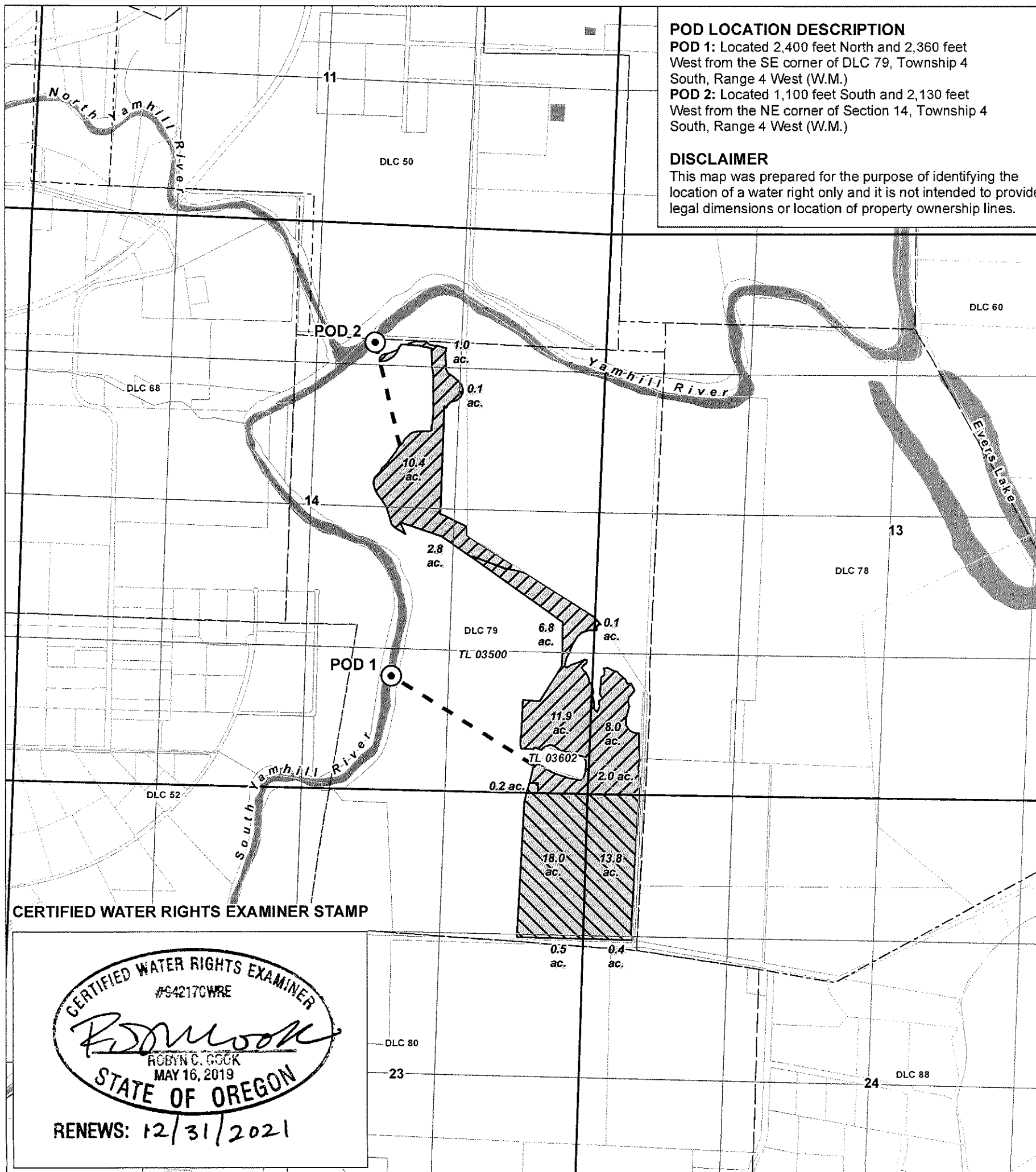

LEGEND

- Proposed Point of Diversion (POD)
 (Certificate 53093 and Certificate 66607)
- Conveyance Line
- Place of Use (POU)**
 - To Lands, 43.1 acres
 - Certificate 53093
 - To Lands, 32.9 acres
 - Certificate 66607
- All Other Features**
 - Tax Lot
 - Donation Land Claim (DLC)
 - Watercourse
 - Waterbody

Application for a Permanent Water Right Transfer
in the Name of Sarbanand Enterprises;
To Lands and Proposed Points of Diversion Map
 Township 4 South, Range 4 West (W.M.)

RECEIVED
 OCT 25 2021
 OWRD

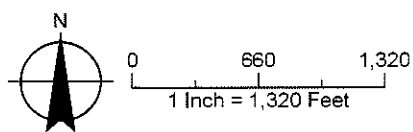

13854

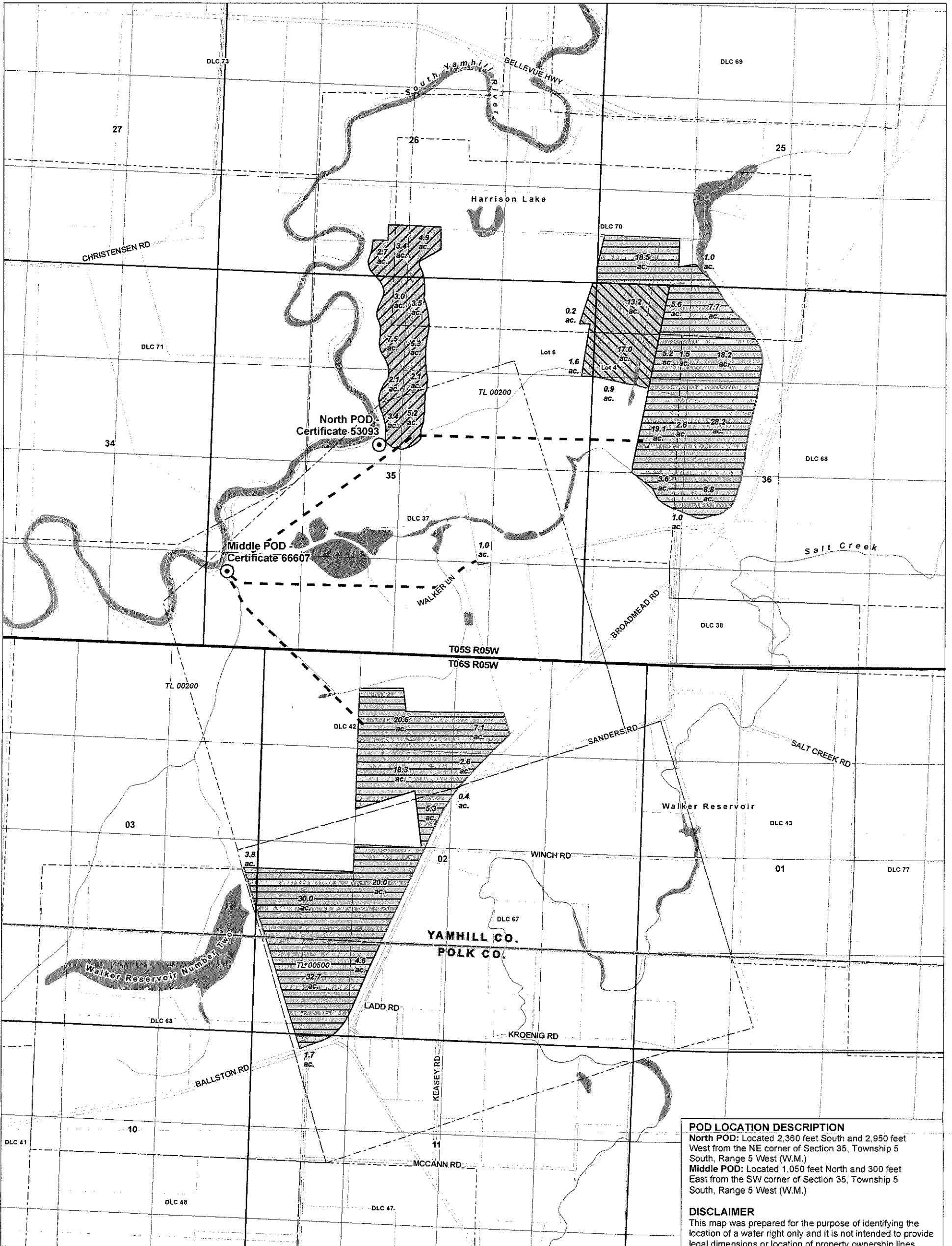

POD LOCATION DESCRIPTION
North POD: Located 2,360 feet South and 2,950 feet West from the NE corner of Section 35, Township 5 South, Range 5 West (W.M.)
Middle POD: Located 1,050 feet North and 300 feet East from the SW corner of Section 35, Township 5 South, Range 5 West (W.M.)

DISCLAIMER
 This map was prepared for the purpose of identifying the location of a water right only and it is not intended to provide legal dimensions or location of property ownership lines.

- LEGEND**
- ⊙ Authorized Point of Diversion (POD)
 - - - Conveyance Line
 - Place of Use (POU)**
 - ▨ From Lands, 43.1 acres - Certificate 53093
 - ▩ From Lands, 32.9 acres - Certificate 66607
 - ▧ Remaining Lands, 269.1 acres - Certificate 66607

- All Other Features**
- Tax Lot
 - Donation Land Claim (DLC)
 - Government Lot (GL)
 - County Line
 - ~ Watercourse
 - ☉ Waterbody

CERTIFIED WATER RIGHTS EXAMINER STAMP

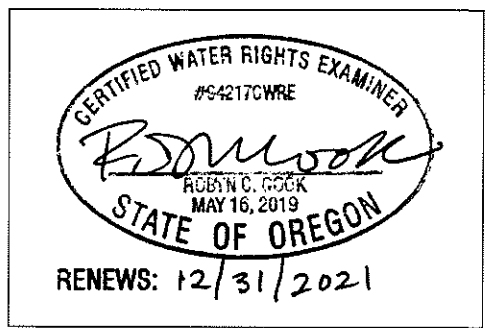

RECEIVED
 OCT 25 2021

Application for a Permanent Water Right Transfer in the Name of Sarbanand Enterprises; From Lands, Remaining Lands, and Authorized Points of Diversion Map Township 5 & 6 South, Range 5 West (W.M.)

MAP NOTES
 Date: July 28, 2021
 Data Sources: BLM, ESRI, Yamhill Co., Polk Co., USGS

