

**T24S R27E, WM,
HARNEY COUNTY, OR**

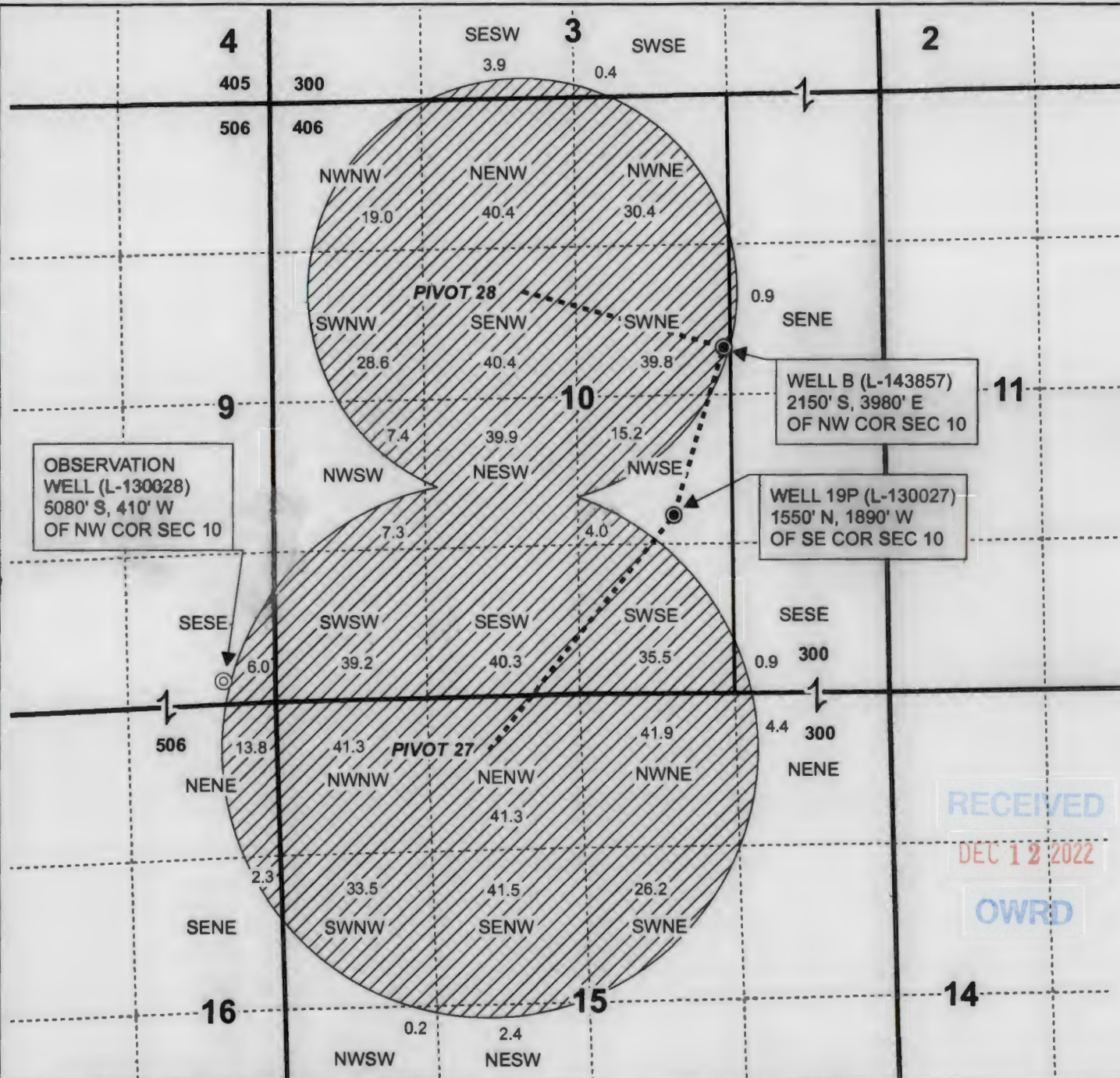

OBSERVATION
WELL (L-130028)
5080' S, 410' W
OF NW COR SEC 10

WELL B (L-143857)
2150' S, 3980' E
OF NW COR SEC 10

WELL 19P (L-130027)
1550' N, 1890' W
OF SE COR SEC 10

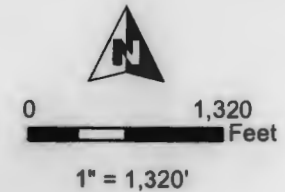

- Well & Meter
- Observation Well
- Pipeline
- ▨ POU IR
- Section
- Quarter Quarter
- Tax Lot



RECEIVED
DEC 12 2022
OWRD

RENEWAL DATE 12/31/2023



**CLAIM OF BENEFICIAL USE MAP
Phillip & Lorissa Singhose**

This map is not intended
to provide legal dimensions
or locations of property
ownership lines.

WATER RIGHT SERVICES, LLC
PO BOX 1830, BEND, OR 97709
WWW.OREGONWATER.US CCB # 197121
johnshort@usa.com 541-389-2837