

WORK COPY

APPROX  
SCALE

1" = 400 FEET

RECEIVED  
NOV 02 2004  
WATER RESOURCES DEPT  
SALEM, OREGON

SE 1/4 SEC 12 T3S R2E W.M.  
CLACKAMAS COUNTY



This map was prepared for  
assessment purposes only.

17500

7000

10000

SEE MAP 1 DE 124

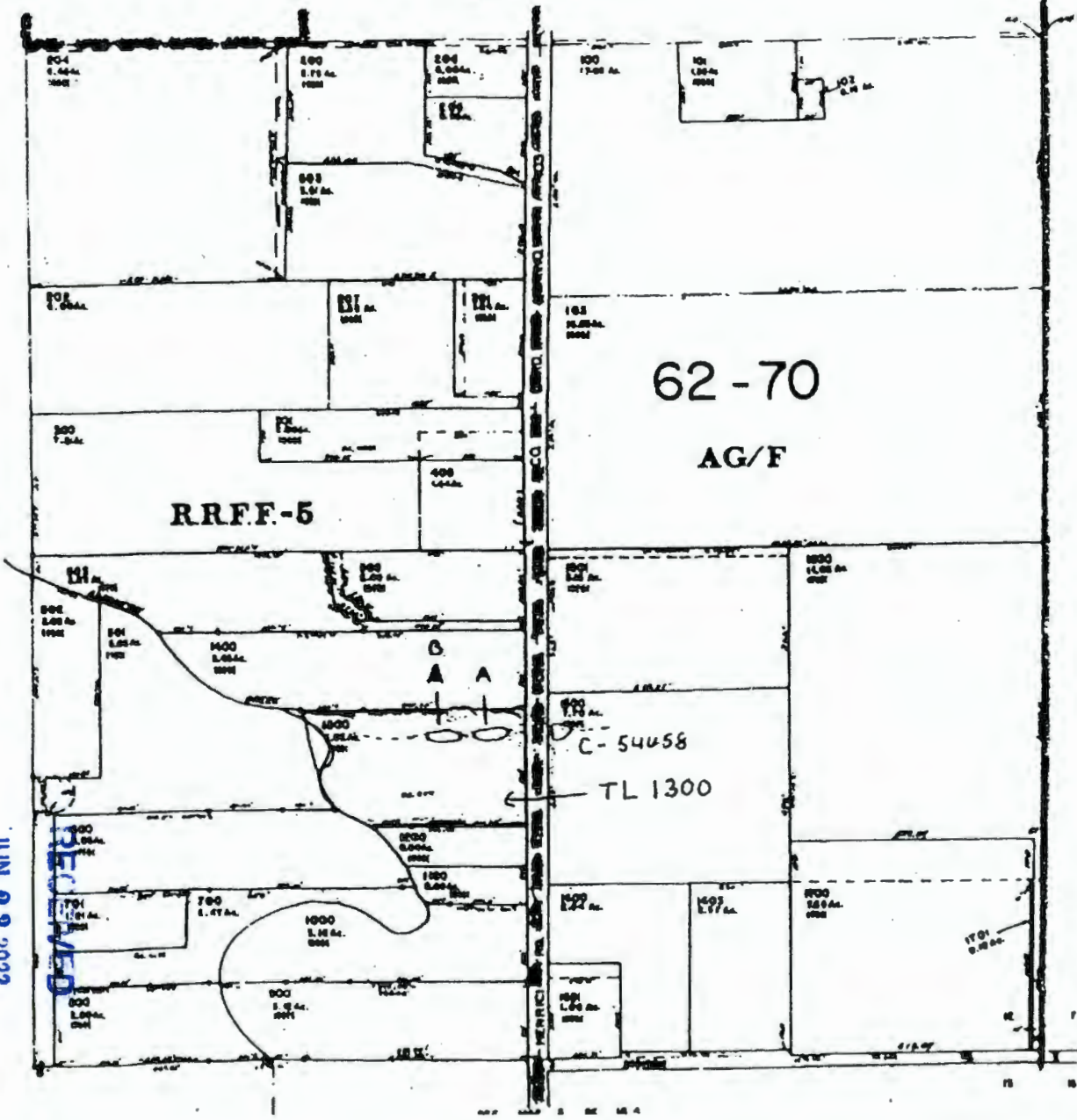

18500

19700

20000

3 2 E RD

OWRD

JUN 23 2022

Pond A - Dam Loc:  
835' N and 1145' E

Pond B - Dam Loc:  
835' N and 1035' E

SW Corner of the SE 1/4  
35, 2E, Sec 12

TL 1300 SEC 12 DC  
T 3 S R 2 E W.M.  
1" = 400'  
REVISED TO  
1" = 400 FEET