

Claim of Beneficial Use Map for T-7145
 T 38 S, R 4 W, W M, Jackson County
 Portions of Sections 7 and 8
 June 12, 2021

Map 5 of 5

OCT 31 2021

OWRD

N

1 inch = 1,320 feet

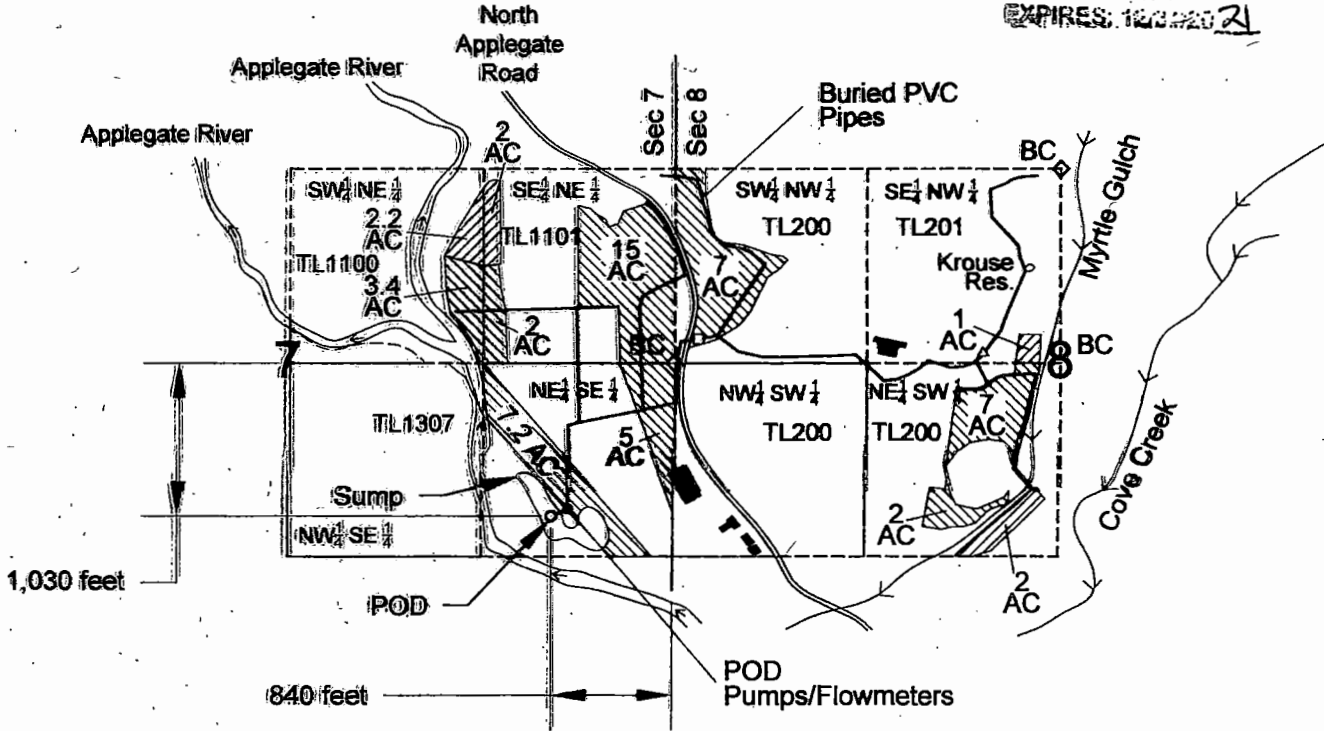
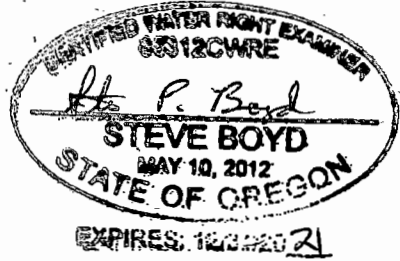

From Certificate #58913 with priority of July 29, 1981 for irrigation at a rate of 0.15 cfs from Applegate River and 42.0 AF from Applegate Reservoir at the POD.

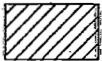

POU (Place of Use) - Total of 7.2 acres of primary irrigation.



POU (Place of Use) - Total of 48.6 acres of supplemental irrigation.



POD (Point of Diversion) - Located 1,030 ft S and 840 ft W of the E 1/4 corner of Sec. 7. Consists of 3 independent POD's: POD 1 (10 hp), POD 2 (25 hp), POD 3 (75 hp).



POD Pumps/Flowmeters - 3 independent pumps (10 hp, 25 hp, 75 hp) and 3 flowmeters.



40 hp Booster Pump



5 hp Booster Pump



Sump - 2.4 acre surface area and 4.0 acre-feet volume.



Buildings

This map was drawn by Steven P. Boyd (CWRE# 85312) for 15877 N. APPLGATE ROAD LLC (owner of Tax Lots 200, 201, 1100 and 1101) in support of their Claim of Beneficial Use under T-7145.

NOTE: This map is not intended to provide legal dimensions or locations of property ownership lines.