

Claim of Beneficial Use Map for T-7145
 T 38 S, R 4 W, W M, Jackson County
 Portions of Sections 7 and 8
 June 12, 2021

Map 4 of 5

N
 ↑
 1 inch = 1,320 feet

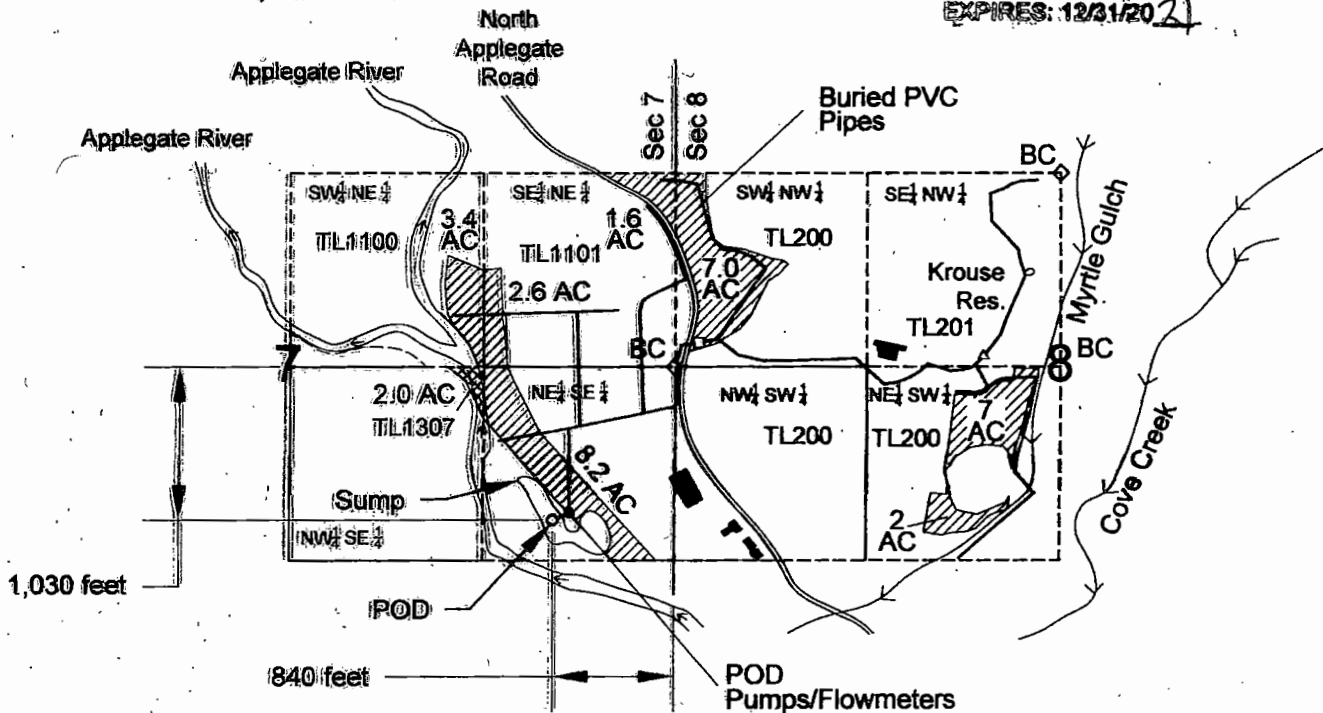

From Certificate #57369, priority of Nov. 21, 1961 for irrigation at rate of 0.88 cfs from POD.



POU (Place of Use) - Total of 31.8 acres of primary irrigation.



2.0 acres of POU in NW 1/4 - SE 1/4 of Section 7 (Tax Lot 1307) is no longer under same ownership. Change was not completed on these 2.0 acres.

- **POD (Point of Diversion)** - Located 1,030 feet S and 840 feet W of the E 1/4 corner of Section 7. Consists of 3 independent POD's: POD 1 (10 hp), POD 2 (25 hp), POD 3 (75 hp).
- **POD Pumps/Flowmeters** - 3 independent pumps (10 hp, 25 hp, 75 hp) and 3 flowmeters.
- **40 hp Booster Pump**
- △ **5 hp Booster Pump**
- 👉 **Sump** - 2.4 acre surface area and 4.0 acre-feet volume.
- **Buildings**

This map was drawn by Steven P. Boyd (CWRE# 85312) for 15877 N. APPLEGATE ROAD LLC (owner of Tax Lots 200, 201, 1100 and 1101) in support of their Claim of Beneficial Use under T-7145.

NOTE: This map is not intended to provide legal dimensions or locations of property ownership lines.