

Legend

-  Point of Diversion
-  Place of Use
-  Digitized Tax Lots

**T22S R45E W.M.
MALHEUR COUNTY
TAX LOTS 103 & 104**

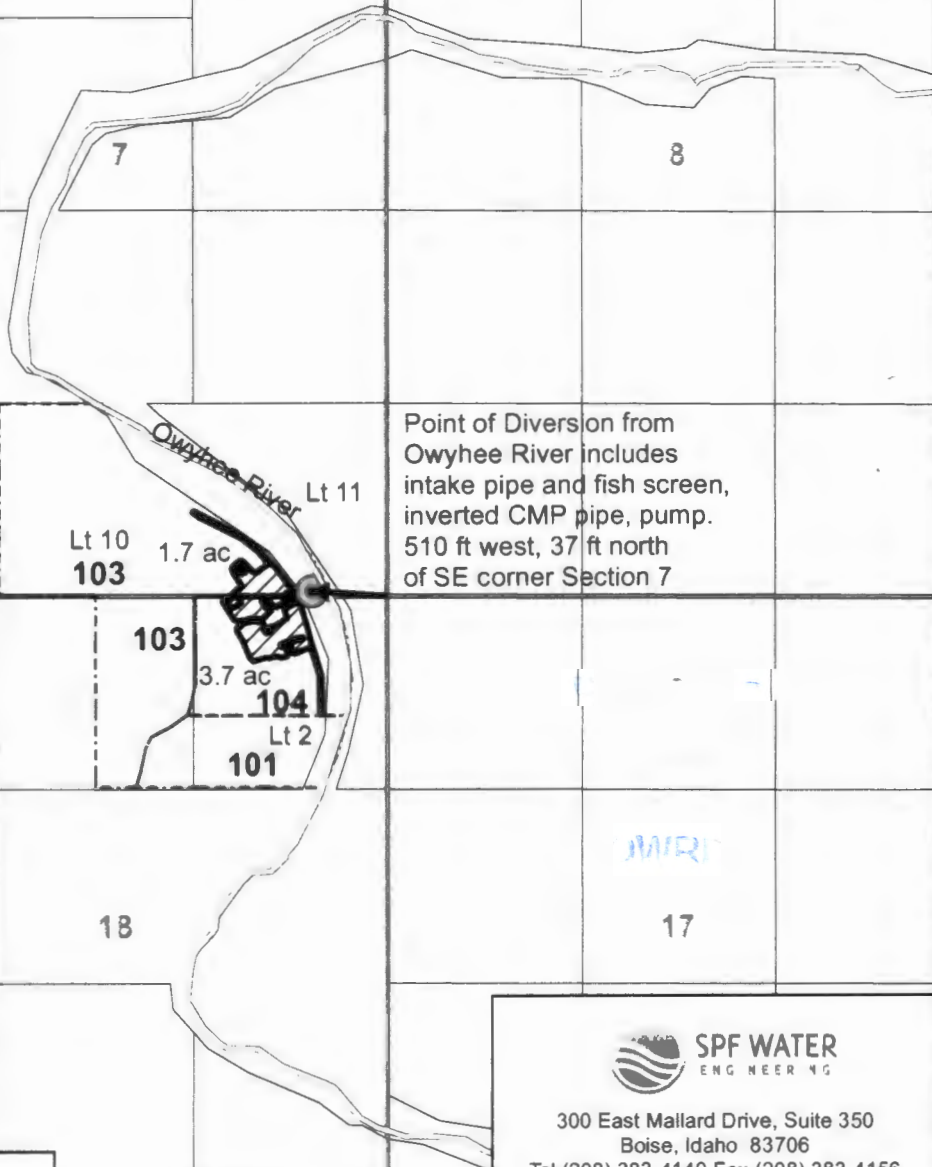

Point of Diversion from Owyhee River includes intake pipe and fish screen, inverted CMP pipe, pump. 510 ft west, 37 ft north of SE corner Section 7



SPF WATER
ENGINEERING

300 East Mallard Drive, Suite 350
Boise, Idaho 83706
Tel (208) 383-4140 Fax (208) 383-4156

T-10570
Claim of Beneficial Use Map

DATE: 1/15/2021
CREATOR: SKing
PROJECT: 212.0040



Absolute Scale: 1:15,840
0 330 660 1,320 1,980
Feet



Map Preparer's Statement:
This map is not intended to provide legal dimensions or locations of property ownership lines.

Path: S:\PROJECTS\Info L\Project\Sub\Projects\DS Church\212\0040\Camp\Hydrol\WR Exam\PROJECT\GIS\Map\Project\Hydrol.mxd