

RECEIVED

OCT 12 1998

WATER RESOURCES DEPT.
SALEM, OREGON

T3N R29E W.M.

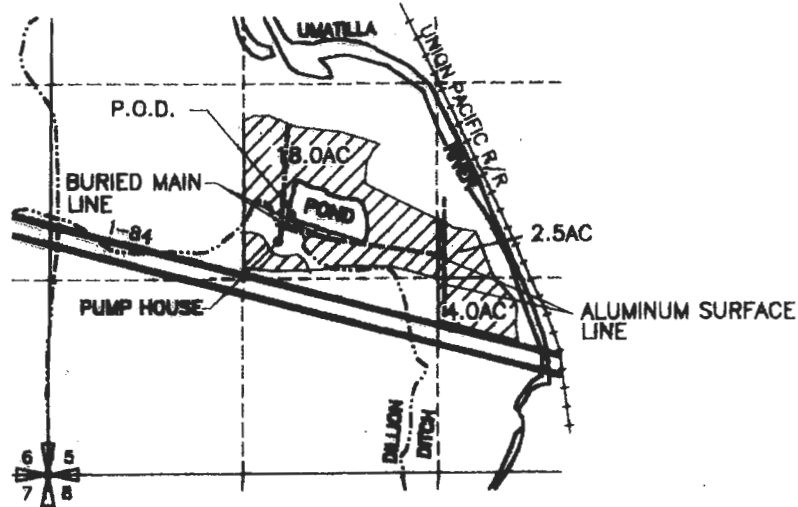

P.O.D. GRAVEL PIT LOCATED AT 1600'E & 1580'N
SW CORNER SECTION 5

FINAL PROOF SURVEY

UNDER
I-7766
IN NAME OF

DARWIN NETHERDA

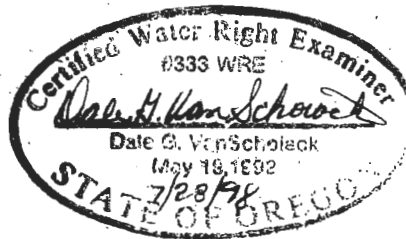

0 1320 2640

SCALE IN FEET

 AREA OF WATER RIGHTS CLAIMED
IRRIGATED BY NETHERDA

NOTE: THE PURPOSE OF THIS MAP IS TO IDENTIFY THE APPROXIMATE LOCATION
OF THE WATER RIGHT. IT IS NOT INTENDED TO PROVIDE INFORMATION
RELATIVE TO THE LOCATION OF PROPERTY OWNERSHIP BOUNDARY LINES.

DARWIN NETHERDA TRANSFER MAP FOR ADDITIONAL POINTS OF DIVERSION T 3N R 29E W M

T 7766

RECEIVED

JUL - 9 1997

WATER RESOURCES DEPT.
SALEM, OREGON

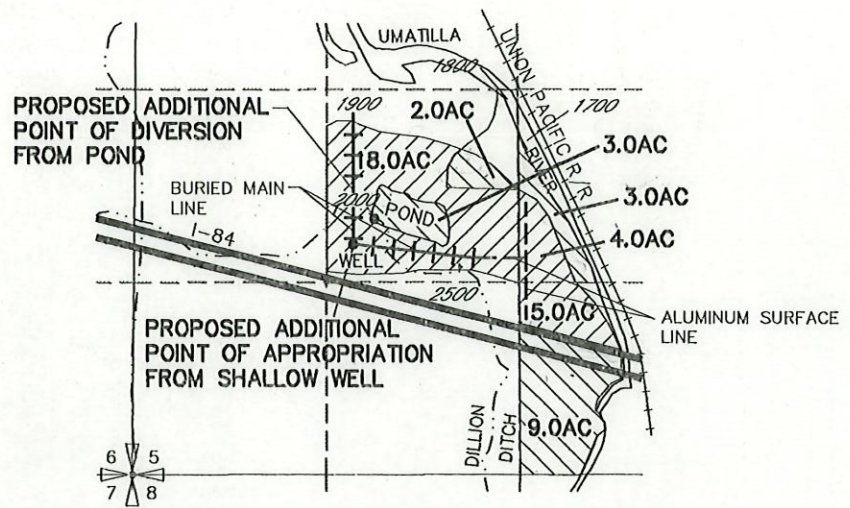

PROPOSED ADDITIONAL POINT OF DIVERSION LOCATED 1760 FEET NORTH AND 1650 FEET EAST FROM THE SW CORNER SEC 5
 PROPOSED ADDITIONAL POINT OF APPROPRIATION LOCATED 1580 FEET NORTH AND 1510 FEET EAST FROM THE SW CORNER SEC 5

- AREA OF C.J. WARD DECREED VESTED WATER RIGHTS INVOLVED IN THIS TRANSFER
- AREA OF C.J. WARD DECREED VESTED WATER RIGHTS NOT INVOLVED IN THIS TRANSFER

AUTHORIZED POINT OF DIVERSION T.3N., R.29E., W.M.

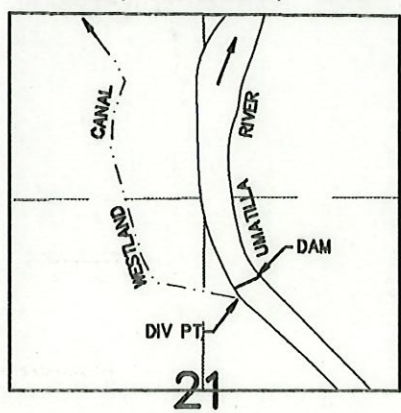

DIV PT LGT N.76°45'56"E. 2013.19' FROM W.1/4 COR. SEC 21

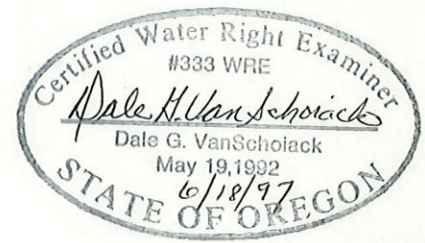
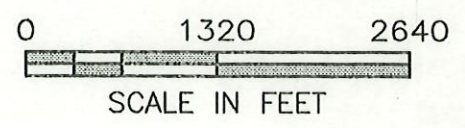
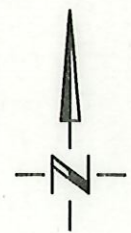

NOTE: THE PURPOSE OF THIS MAP IS TO IDENTIFY THE APPROXIMATE LOCATION OF THE WATER RIGHT. IT IS NOT INTENDED TO PROVIDE INFORMATION RELATIVE TO THE LOCATION OF PROPERTY OWNERSHIP BOUNDARY LINES.

3522.057
3522NETH.DWG
6/18/97