

Claim of Beneficial Use Point of Appropriation and Place of Use Map K-J Ranch

Application G-18462, Permit G-18267

Deschutes County

Township 22 South, Range 10 East, Section 10 (W.M.)

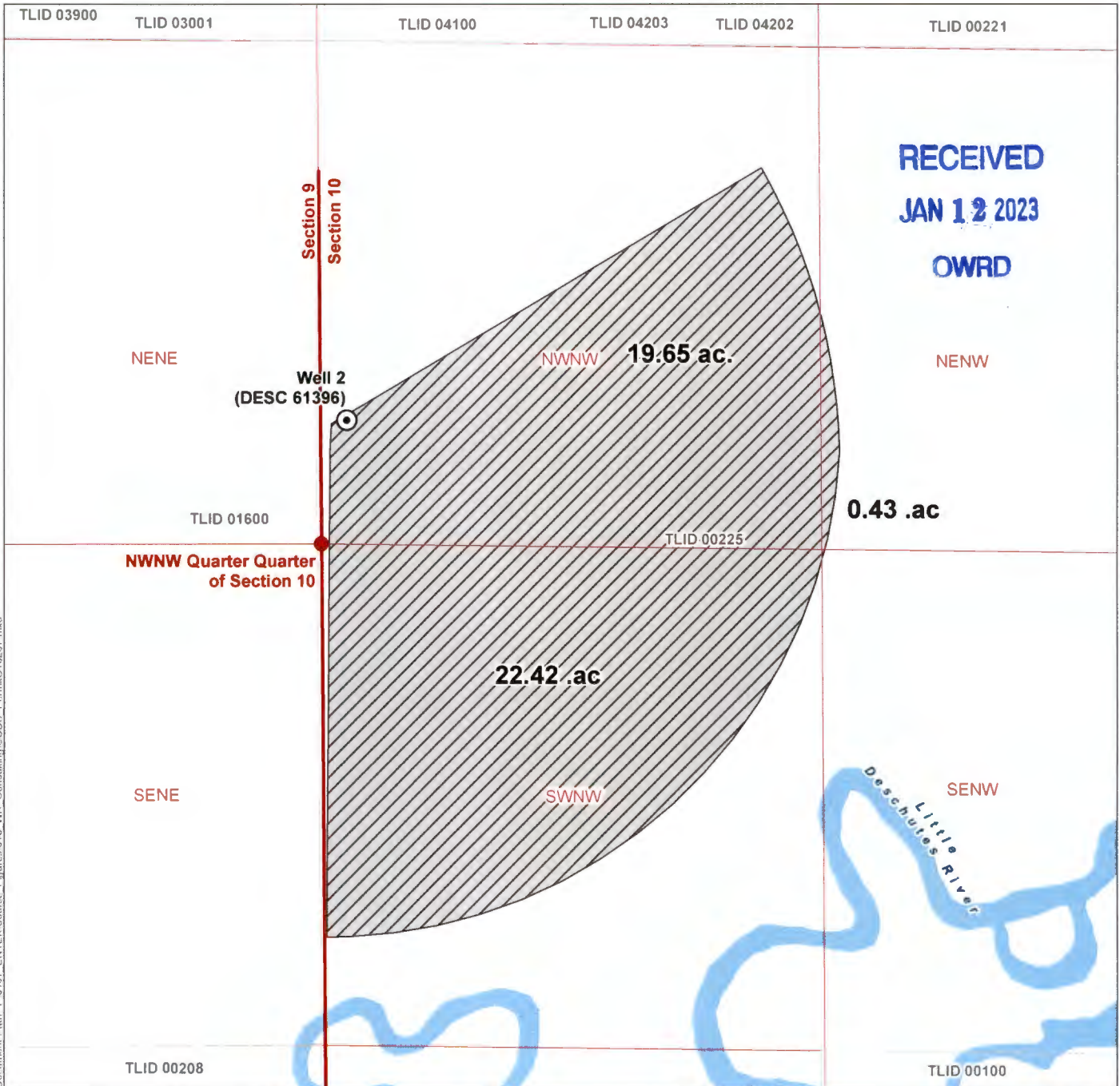

D:\work\Path_Y_0167\ENTER\Source_Expire\016_VPR_Consulting\COBU_PermitG-18267.mxd

LEGEND

-  Point of Appropriation (POA)
-  Authorized Place of Use (POU)
- All Other Features**
-  Tax Lot
-  Waterbody

POA LOCATION DESCRIPTION

Point of Appropriation (DESC 61396)
Well location located 320 feet North and 65 feet East from the SW corner of the NWNW Quarter Quarter of Section 10, Township 22 South, Range 10 East (W.M.)
Meter Location: Well meter located 15 feet west of the wellhead on the discharge line.

CERTIFIED WATER RIGHTS EXAMINER STAMP



DISCLAIMER

This map was prepared for the purpose of identifying the location of a water right only and it is not intended to provide legal dimensions or location of property ownership lines.

MAP NOTES

Date: December 29, 2022
Data Sources: Deschutes County, BLM, USGS

