

T6N, R34E, WM
Sections 21 & 22
Umatilla County

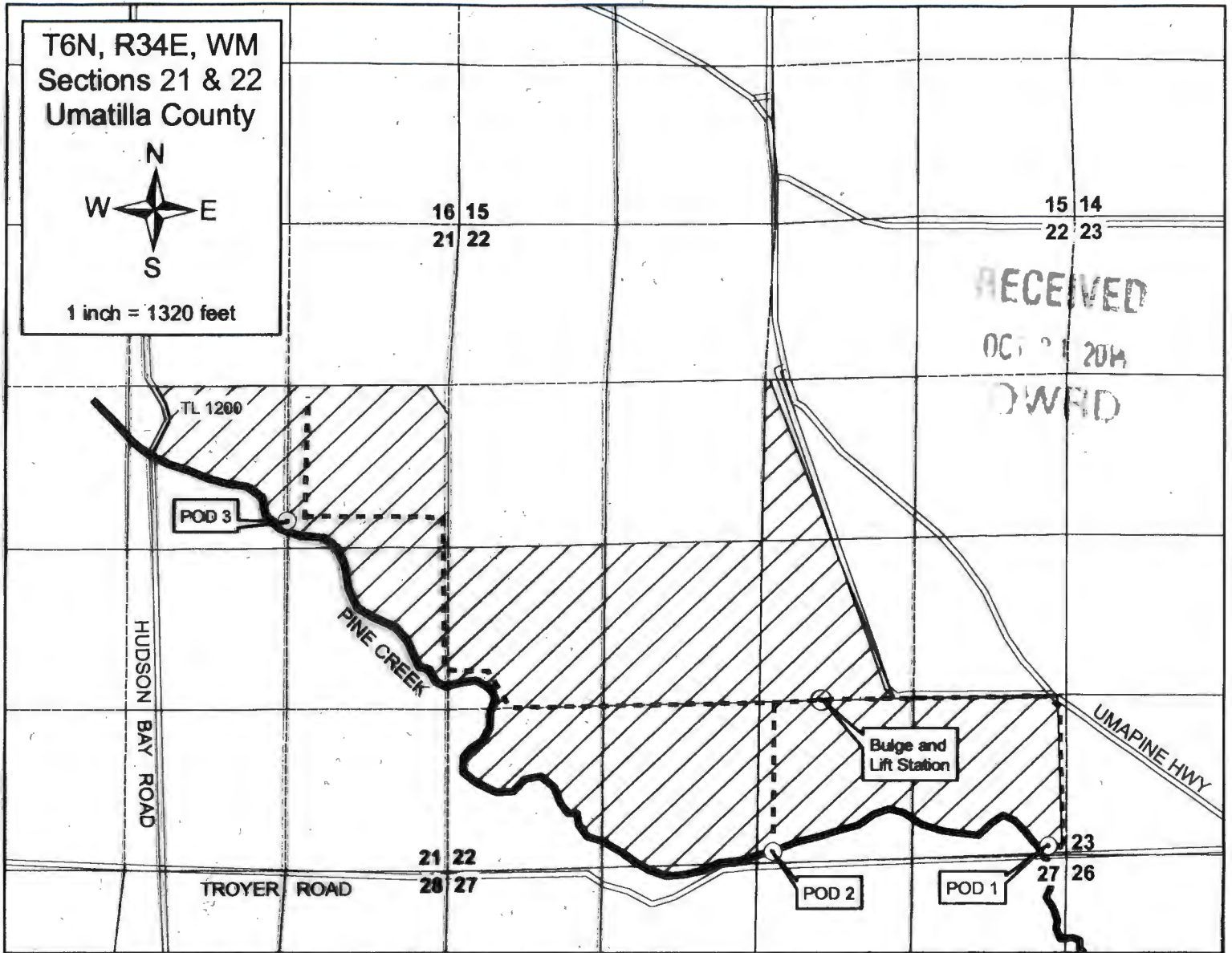

1 inch = 1320 feet



⊙ **Authorized PODs**

POD 1 located 40 feet N and 275 ft W from SE Corner of Section 22. Fish screen in same location.

POD 2 located 2590 feet W from SE Corner of Section 22. Fish screen in same location.

POD 3 located 2750 feet N and 1100 feet W from SE Corner of Section 21. Fish screen in same location.

 **Place of Use**

302.3 acres
14.6 primary and 287.7 supplemental
SW NE S21 4.6 ac (P) + 14.7 ac (S)
SE NE S21 7.4 ac (P) + 30.0 ac (S)
NE SE S21 0.0 ac (P) + 11.4 ac (S)
SW NE S22 1.0 ac (P) + 10.0 ac (S)
NE SW S22 1.6 ac (P) + 40.0 ac (S)
NW SW S22 0.0 ac (P) + 37.8 ac (S)
SW SW S22 0.0 ac (P) + 15.8 ac (S)
SE SW S22 0.0 ac (P) + 40.0 ac (S)
NW SE S22 0.0 ac (P) + 25.0 ac (S)
SW SE S22 0.0 ac (P) + 33.0 ac (S)
SE SE S22 0.0 ac (P) + 30.0 ac (S)

----- **Conveyance**

POD 1 discharges into open ditch that flows by gravity to bulge and lift pump station, then into common buried mainline system. POD 2 discharges into buried mainline that flows under low pressure to bulge and lift pump station. POD 3 discharges into common buried mainline system. Water applied to broadacre crops with aluminum handline laterals equipped with brass impact sprinklers with flow control nozzles.

The purpose of this map is to identify the location of a water right. It is not intended to provide information regarding the location of property ownership boundary lines.

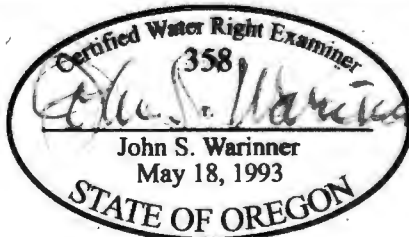

FOUNTAINHEAD
19552 E Campbell Rd
Bend, OR 97702
541.815.4103 phone

CLAIM OF BENEFICIAL USE

Transfer 8722

in the name of
CALVIN N. BLESSINGER

Revised 31 AUG 2014