

# T.7S. R.2.W, W.M

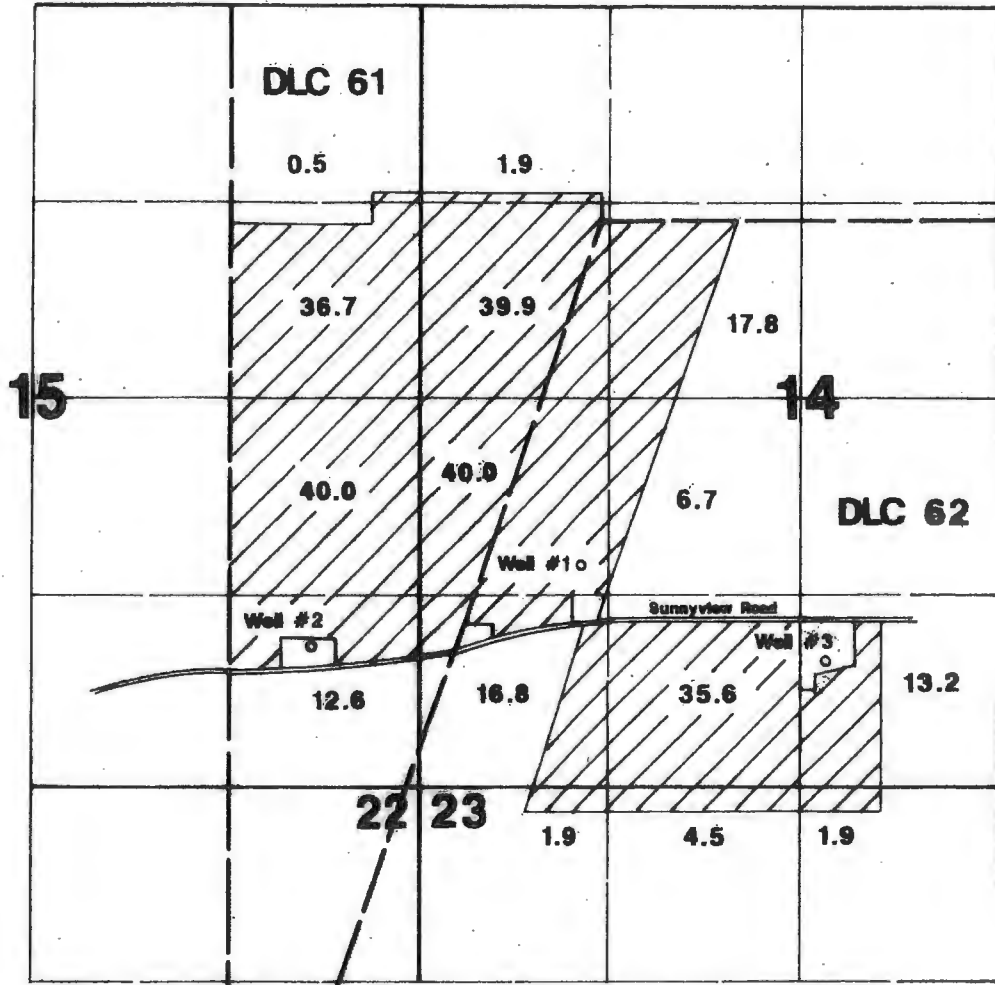

1" = 1320'



Well #1 is located 1520'N & 1140'E from the SW corner of Section 14.  
 Well #2 is located 960'N & 760'W from the SE corner of Section 15.  
 Well #3 is located 860'N & 150'E from the S1/4 corner of Section 14.

## Final Proof Survey

Application #: G-13454 Permit #: G-11804

In Name Of

### Billy Gydesen

Surveyed on September 25, 1998 by JM Schuette

This Map Was Prepared For The Purpose Of Identifying The Location Of A Water Right Only And Is Not Intended To Provide Legal Dimensions Or Location Of Property Ownership Lines.



WATER RESOURCES DEPT.  
 SALEM, OREGON

OCT 01 1998

RECEIVED