

T. 5S., R. 5W., W. M.

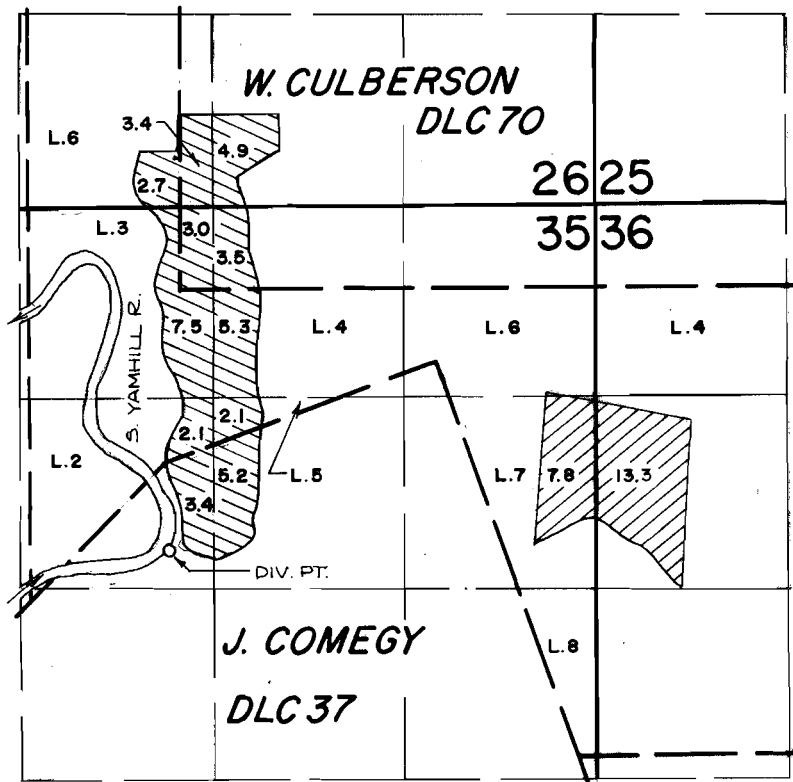

DIV. PT. IS LOCATED 2360 FT. S. AND 2950 FT. W. FROM THE N.E. CORNER OF SECTION 35.

 PERMIT NO. 46660

 PERMIT NO. 45353

N

SCALE: 4" = 1 MILE

FINAL PROOF SURVEY
UNDER

Application No. 63113 Permit No. 46660
60790 Permit No. 45353
IN NAME OF

R. L. WALKER FARMS, INC.

Surveyed OCT. 3, 1984, by P. Patten