

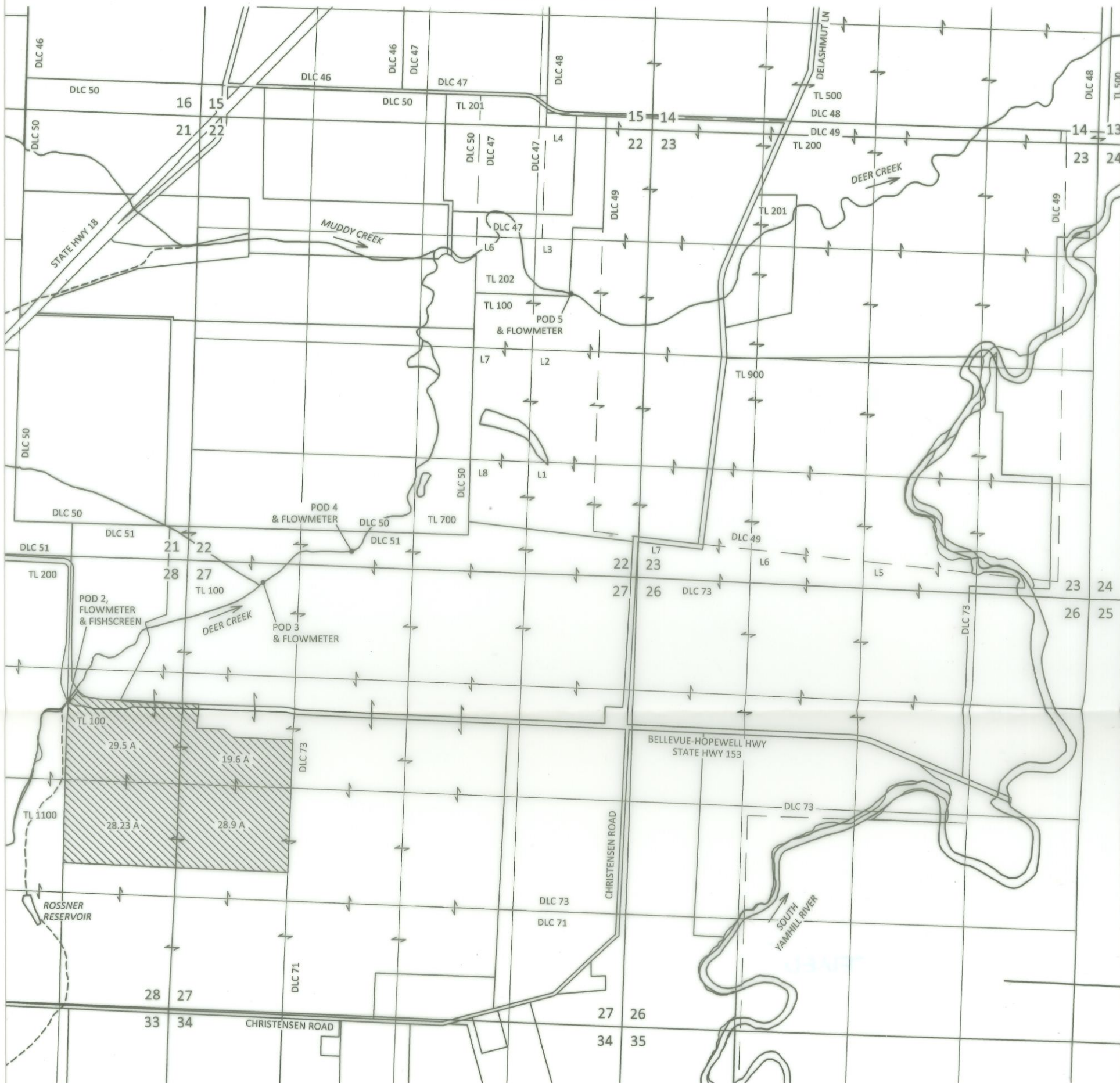

Sections 22, 27 & 28, T5S, R5W, W.M.,
Yamhill County, Oregon

Transfer T-13448
CLAIM OF BENEFICIAL USE MAP
K.A. Berger Farms Inc.



EXPLANATION

-  PLACE OF USE IRRIGATION - 106.23 ACRES PRIORITY: 3/19/1951
- POINT OF DIVERSION (POD)

RECEIVED

JAN 23 2023

OWRD

Site Inspection Conducted
12/12/2022

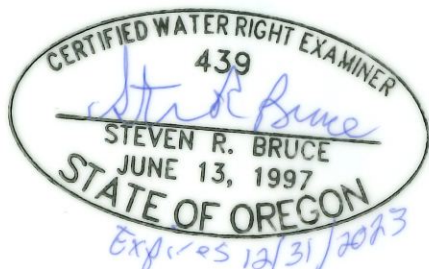

- POD 2 LOCATION: 1690 FT S AND 1420 FT W FROM NE CORNER OF SECTION 28, T5S, R5W, W.M.
- POD 3 LOCATION: 260 FT S AND 890 FT E FROM NW CORNER OF SECTION 27, T5S, R5W, W.M.
- POD 4 LOCATION: 110 FT N AND 1930 FT E FROM SW CORNER OF SECTION 22, T5S, R5W, W.M.
- POD 5 LOCATION: 1940 FT S AND 960 FT W FROM NE CORNER OF SECTION 22, T5S, R5W, W.M.



December 28, 2022

This map is not intended to provide legal dimensions or locations of property ownership lines

Figure 1

KPFF 1700014.75

SKOOKUM
WATER ASSOCIATES INC

1626 VICTORIAN WAY
EUGENE, OR 97401
(503) 319-8926