

**T29S R12W &
T30S R12W, WM,
COOS COUNTY, OR**

**POD LOCATION:
845' N, 750'W of S 1/4 Cor Sec 32**



0 400
Feet

1" = 400'

- POD & Meter
- Pipeline
- POU IR
- Township
- Section
- Quarter Quarter
- Tax Lot

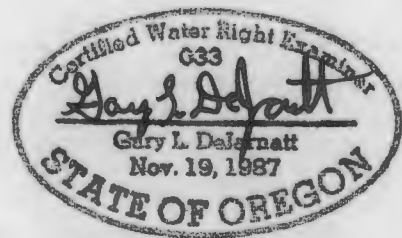

RENEWAL DATE 12/31/2023

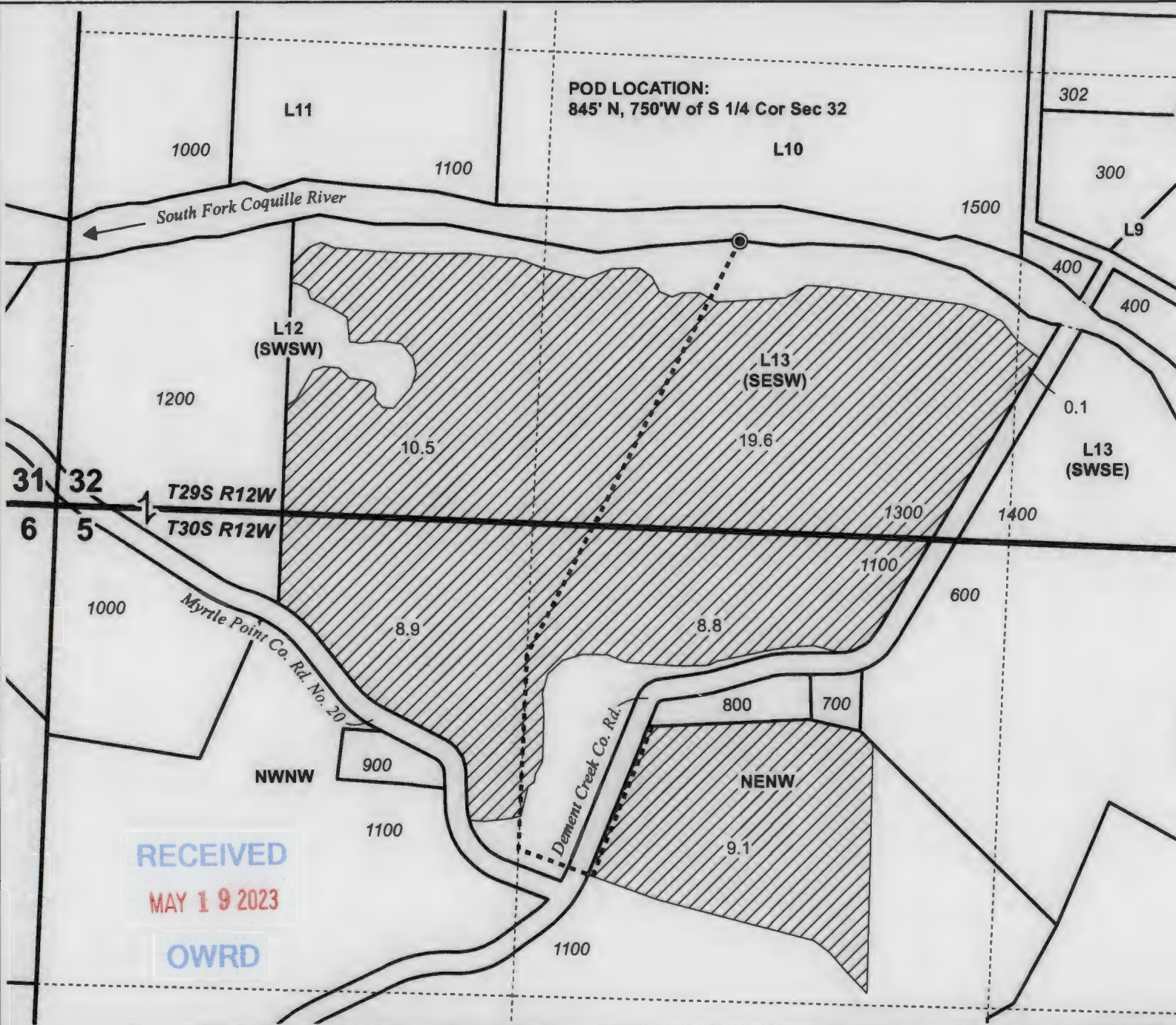

RECEIVED
MAY 19 2023
OWRD

**CLAIM OF BENEFICIAL USE MAP
Beau Allen**

Date: 3/8/2023

Ap S-69189 / Permit S-50114

Project #22075

This map is not intended to provide legal dimensions or locations of property ownership lines.

WATER RIGHT SERVICES, LLC
PO BOX 1830, BEND, OR 97709
WWW.OREGONWATER.US CCB # 197121
johnshort@usa.com 541-389-2837