

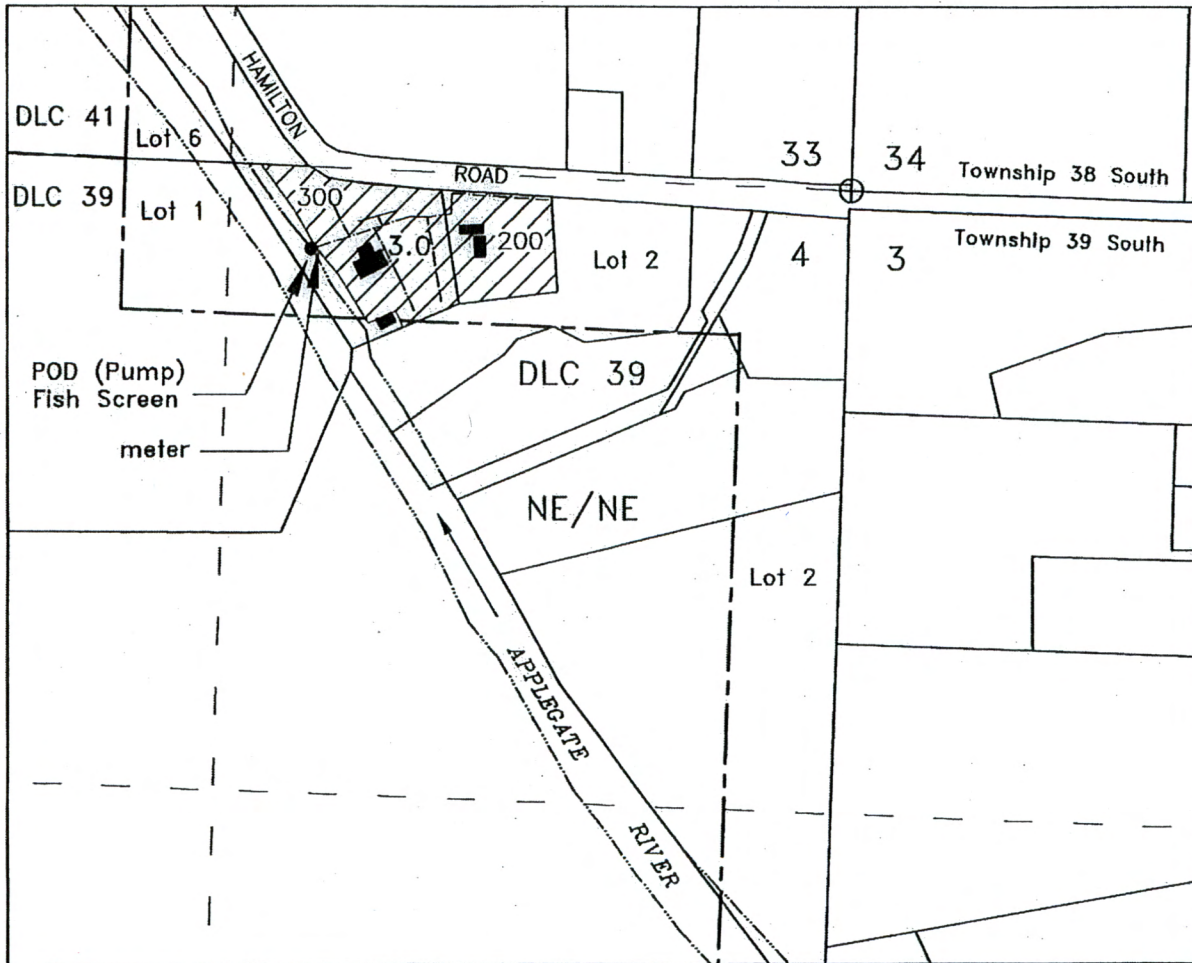

**CLAIM OF BENEFICIAL USE (Partial)**  
**Application S-87796 Permit S-55017**  
**IN THE NAME OF: APPLGATE IRRIGATION CORPORATION**  
**PUMP GROUP 3C**  
**TOWNSHIP 39 SOUTH, RANGE 3 WEST, W.M.**  
**JACKSON COUNTY, OREGON**



**POINT OF RE-DIVERSION**

POD - NE/NE, Lot 2, 175 feet South & 1160 feet West from the NE corner of Section 4, Township 39S Range 3W, WM

Place of Use 3.0 Acres - Irrigation  
Tax Lot 200 & 300

SOURCE - Applegate Lake Reservoir (Permit R-7810)

TL-200 -Martina H. & James W. Christopherson, Jr.  
TL-300 - Christopherson Family Joint Rev Trust

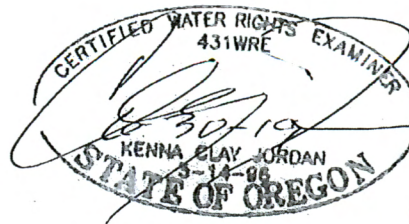

Scale  
1" = 400'

This map is not intended to provide legal dimensions or locations of property ownership lines

Base map - COBU-T-8948

JORDAN ENGINEERING  
460 JORDAN LANE  
ROSEBURG, OR 97471  
(541) 673-1931

Drawn 9/17/2018 n.e.d.