

A-24

Transfer FROM Map

Section 33, T5S, R1W, Marion County Certificate 87974

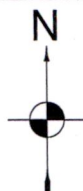

1 IN = 1320 FT
0 660 1320

RECEIVED
JUL 24 2023
OWRD

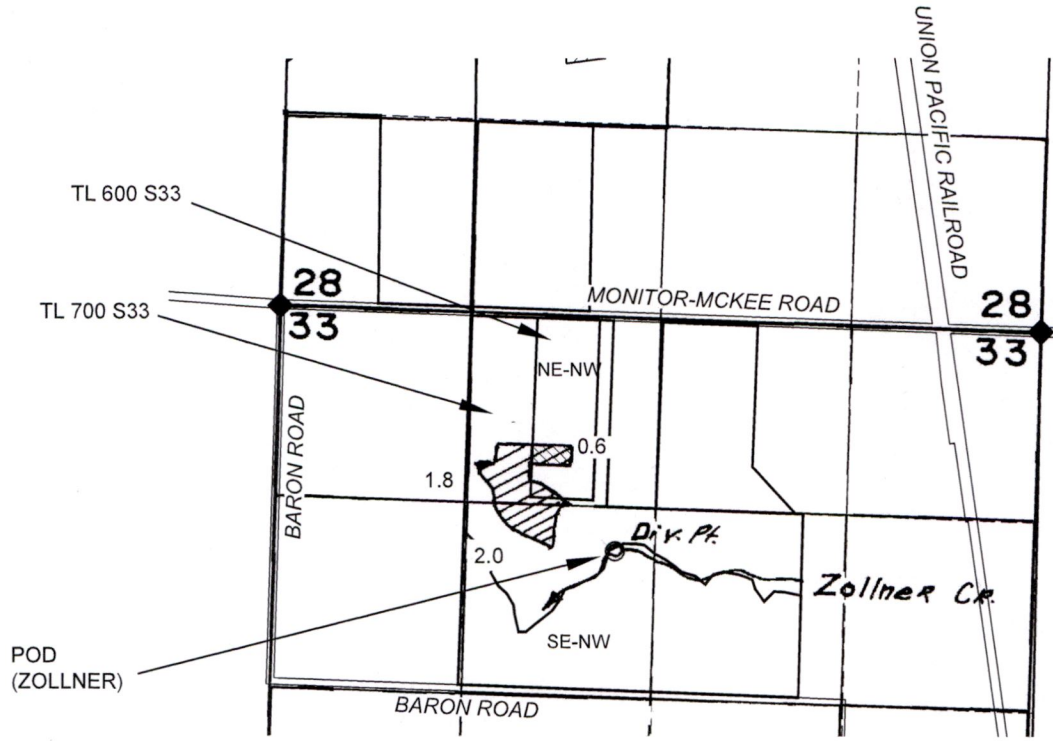

LOCATION OF POINT OF DIVERSION (POD):
POD (ZOLLNER) IS 1630' SOUTH AND 2340' EAST OF NW S33 (PER CERT. 87974)

- NOTES:
- THIS MAP IS NOT INTENDED TO PROVIDE LEGAL DIMENSIONS OR LOCATIONS OF PROPERTY OWNERSHIP LINES.
 - PROPERTY LINES AND QUARTER-QUARTER LINES ARE BASED ON THE TAX ASSESSOR MAP FOR SECTION 33, T5S, R1W.
 - THE BASIS OF THIS MAP IS THE FINAL PROOF MAP FOR CERTIFICATE 87974.



- LEGEND
- ◆◆ DONATION LAND CLAIM (DLC) CORNER
 - ◆ SECTION CORNER
 - POINT OF DIVERSION OR APPROPRIATION
 - STREAM OR SURFACE DRAINAGE
 - TAX LOT LINE
 - SECTION LINE
 - QUARTER-QUARTER LINE
 - DLC LINES (NONE)
 - ~ CONVEYANCE PIPELINES.
 - ▨ FROM ACRES 87974
 - ▨ REMAIN ACRES 87974

14288

MAP BY:
ASPEN RURAL LAND CONSULTING
 ERIC URSTADT, PE, PLS
 971-250-1520
 JUN 2023
 FesslerJoeBeyer7S