

T39S, R35E, Sections 23, 24 and 25, Willamette Meridian

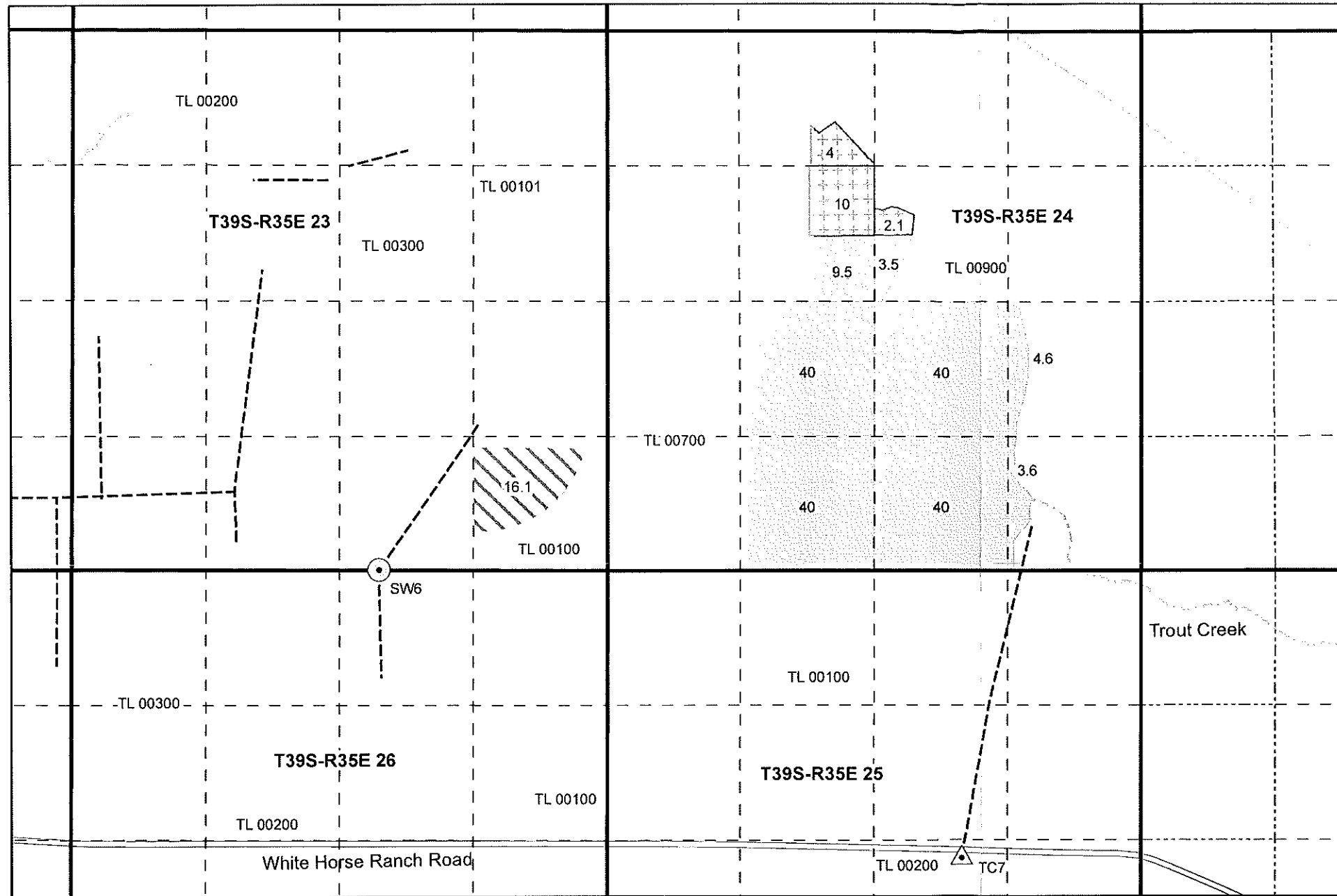

- △ Well - Old POA
- Well - New POA
- pipeline_revised
- Government lot line
- - - Quarter quarter
- Section line
- Perennial stream
- Seasonal stream
- ==== Roads
- Tax lots (updated)
- Transfer**
- ▨ 51251, Supplemental, To
- +++ 51251, Supplemental, From
- ▨ 51251, Supplemental, Stay

RECEIVED
JUL 29 2021
OWRD

New POA - Well SW6 (HARN 1798) is located in SW 1/4 SE 1/4, Section 23, T39S, R35E, WM; 5 feet North and 2,250 feet West from SE Corner, Section 23.

Old POA - HARN 1806 located in T39S, R35E, NW SE OF Section 25; 2,500 feet North and 1,830 feet West from SE Corner, Section 25.

This map is not intended to provide legal dimensions or locations of property ownership lines.

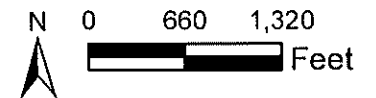

Transfer Map
Certificates 51251, Priority 1968
Oregon Desert Land Trust
Pueblo Mountain Land Company
Harney County

Map prepared by Nancy Rorick Consulting

T.39S.R.35E.W.M.

Permit G-4156

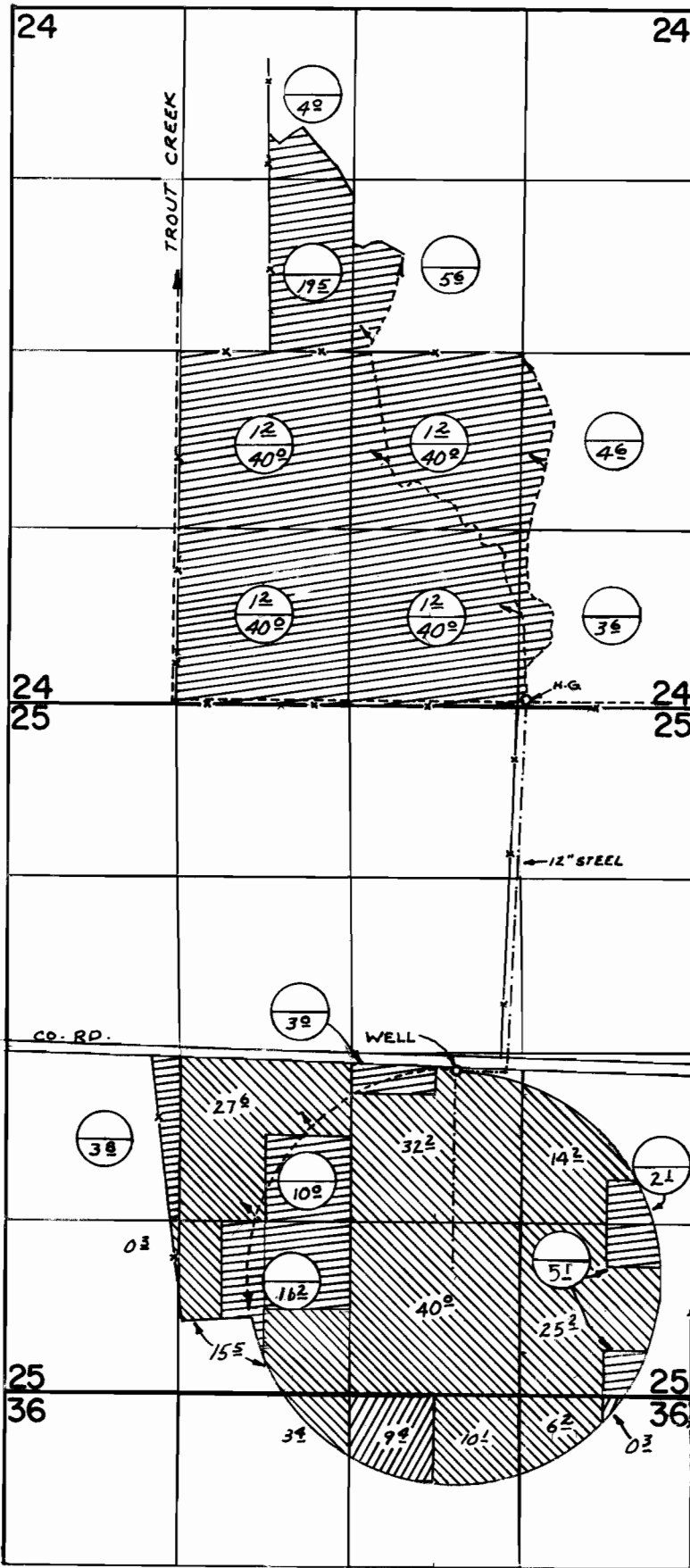

WELL LOC: 2500' N. & 1830' W. FROM S.E. COR. SEC. 25

Permit G-4155

FINAL PROGRESS SURVEY

UNDER

Application No. ~~G-4409~~ ~~G-4410~~ Permit No. ~~G-4155~~ ~~G-4156~~

IN NAME OF

DON S. ORLANDO - TROUT CR. RANCH

Surveyed JUNE 16 1976 by R. MUCKEN