

# CLAIM OF BENEFICIAL USE MAP

TO ADD PLACE OF USE AND POINTS OF APPROPRIATION  
PER APPLICATION G-17644  
FOR TOELLE RANCH, LLC

TOWNSHIP 22 SOUTH, RANGE 32.5 EAST, SECTIONS 25 & 26, W.M.  
TAX LOT 400

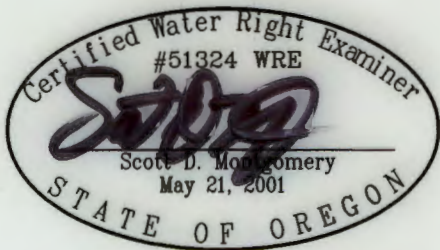
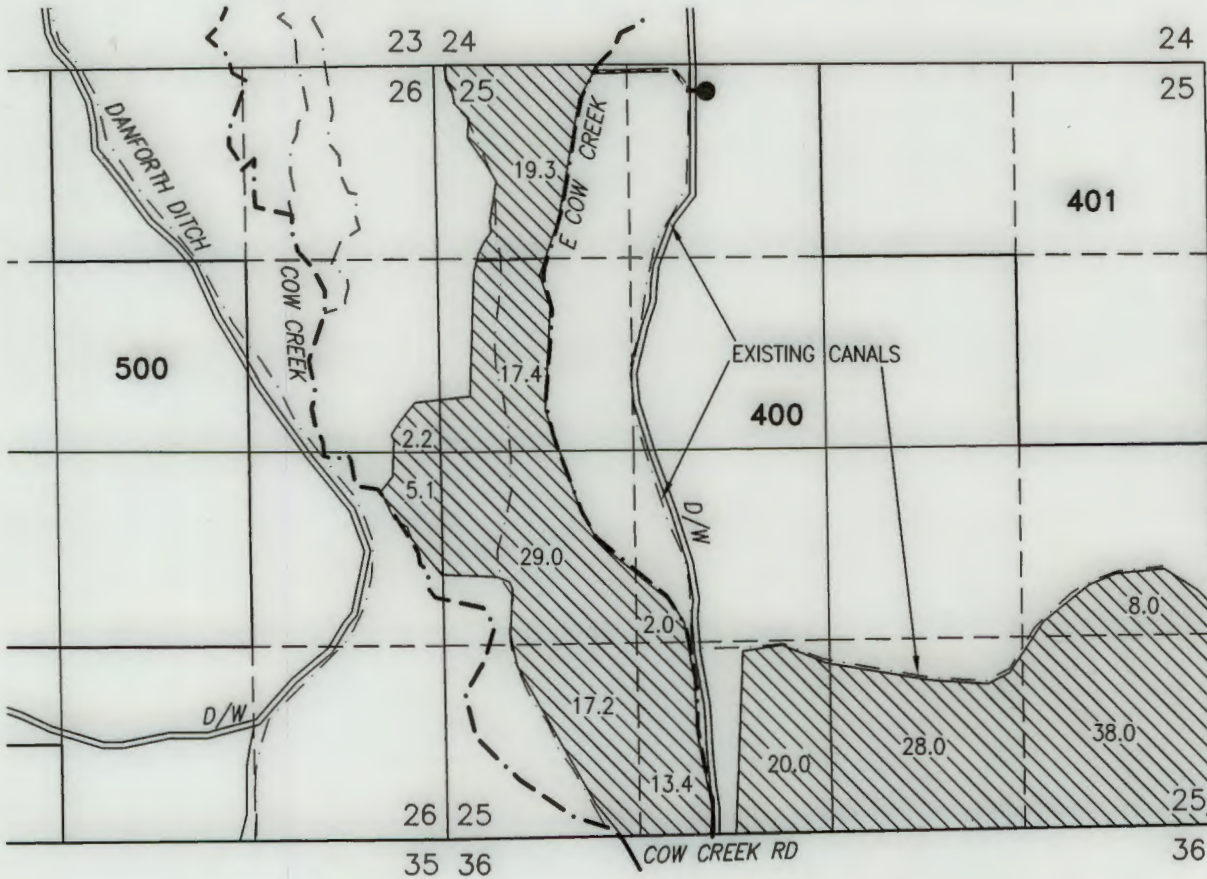

RENEWAL DATE: 12/31/2024

THIS MAP IS FOR THE PURPOSE OF LOCATING A  
WATER RIGHT ONLY AND HAS NO INTENT TO  
PROVIDE LEGAL DIMENSIONS OR THE LOCATION OF  
PROPERTY LINES

- CANAL/DITCH -----
- BURIED CONDUIT =====
- CREEK/STREAM - - - - -

● POA 3 (HARN 52770)

APPROVED WELL IN THE NE 1/4 NW 1/4 SECTION 25,  
T22S R32.5E, W.M. LOCATED 4990 FEET NORTH AND  
3520 FEET WEST FROM THE SE CORNER OF SECTION 25.  
METER IS APPROXIMATELY 8.0 FEET W'LY ALONG  
DELIVERY PIPE FROM WELL.



199.6 ACRES IS FROM  
PERMIT G-17244, AS SHOWN.

RECEIVED  
AUG 16 2023  
OWRD

PREPARED FOR:

TOELLE RANCH, LLC  
72702 COW CREEK ROAD  
BURNS, OR 97720

PREPARED BY:



ALL POINTS ENGINEERING AND SURVEYING, INC.  
P.O. BOX 767 TERREBONNE, OR 97760  
(541) 548-5833 www.APEandS.com