



**T33S R1E, WM,
JACKSON COUNTY, OR**

- POD, Meter, & Fish Screen
- Channel Bank
- Rogue River
- Quarter Quarter
-  POU IR
-  Tax Lot
- Lease Area Property Line



**POD (Re-Diversion) Location:
422' S, 675' E of Cen 1/4 Cor Sec 33**

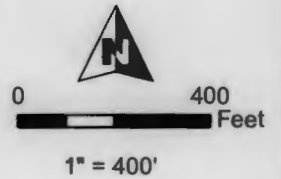
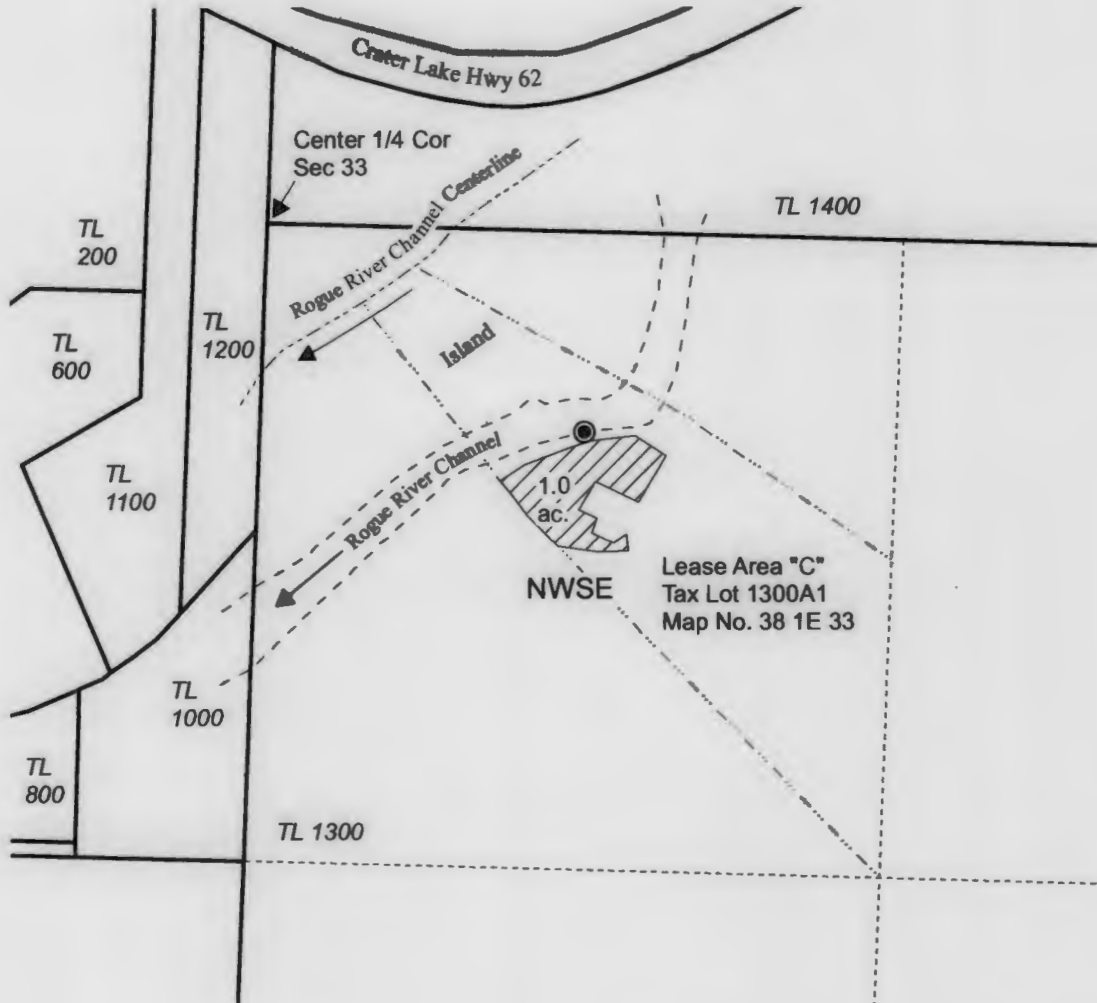

RECEIVED
JUL 06 2023
OWRD



RENEWAL DATE 12/31/2023

<p>CLAIM OF BENEFICIAL USE MAP Project #23012 Shipley Date: 5/15/2023 Ap S-87783 / Permit S-54789</p>	<p>This map is not intended to provide legal dimensions or locations of property ownership lines.</p>	<p>WATER RIGHT SERVICES, LLC PO BOX 1830, BEND, OR 97709 WWW.OREGONWATER.US CCB # 197121 johnshort@usa.com 541-389-2837</p>
---	---	---