

Walla Walla River Irrigation District

3201 Water Rights Map modified by T-12610

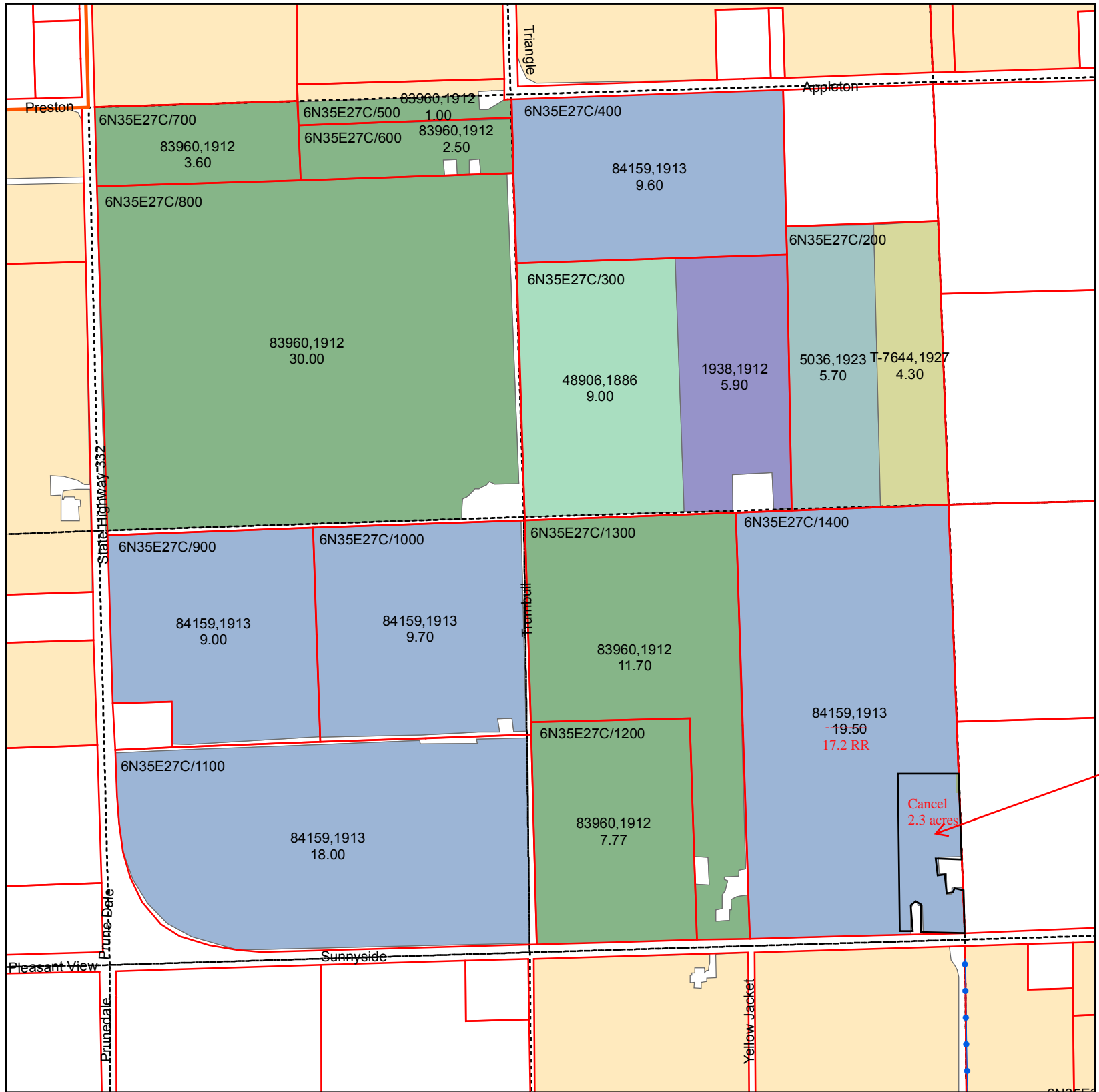

T6N R35E WM Section 27 SW Quarter



ASSESSORMAP	CERTIFICATE	PRIORITY	QQ	WR ACRES
6N35E27C/1000	84159	1913	SWSW	9.70
6N35E27C/1100	84159	1913	SWSW	18.00
6N35E27C/1200	83960	1912	SESW	7.77
6N35E27C/1300	83960	1912	SESW	11.70
6N35E27C/1400	84159	1913	SESW	19.50
6N35E27C/200	5036	1923	NESW	5.70
6N35E27C/200	T-7644	1927	NESW	4.30
6N35E27C/300	48906	1886	NESE	9.00
6N35E27C/300	1938	1912	NESE	5.90
6N35E27C/400	84159	1913	NESE	9.60
6N35E27C/500	83960	1912	NWSW	1.00
6N35E27C/600	83960	1912	NWSW	2.50
6N35E27C/700	83960	1912	NWSW	3.60
6N35E27C/800	83960	1912	NWSW	30.00
6N35E27C/900	84159	1913	SWSW	9.00

2.3 cancelled T-12610 RR 17.2 acres on 93544

Primary Certificates

CERTIFICATE, PRIORITY

- 1938, 1912
- 48906, 1886
- 5036, 1923
- 83960, 1912
- 84159, 1913
- T-7644, 1927

Water Rights Not Within Quarter

Legend

- PIPE
- Parcel
- QCDB
- WWRID Boundary

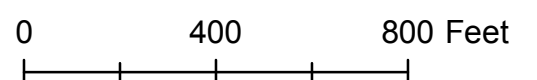

Date March 2011

Walla Walla River Irrigation District

3201 Water Rights Map modified by T-14387

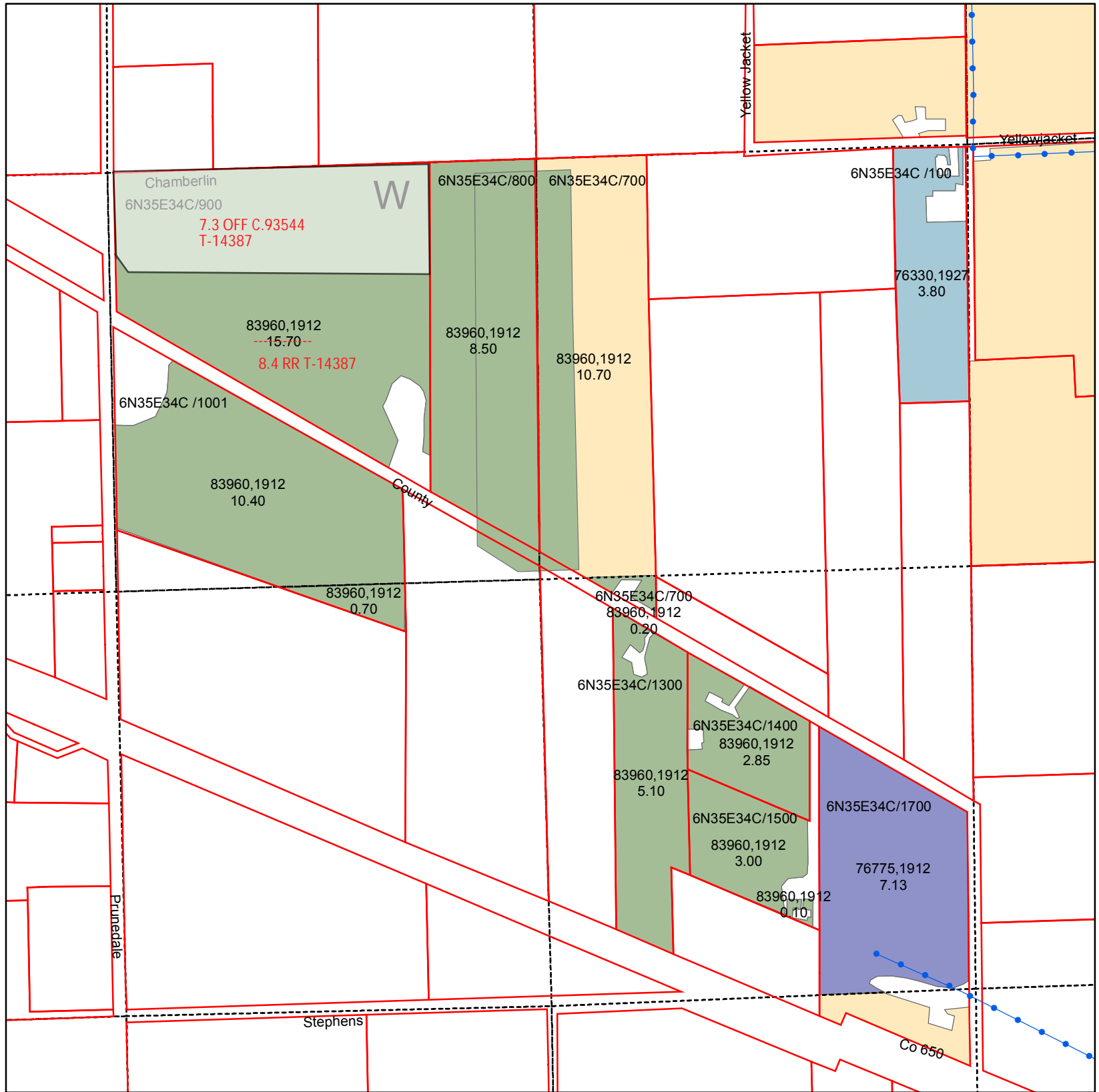

T6N R35E WM Section 34 SW Quarter



ASSESSORMAP	CERTIFICATE	PRIORITY	QQ	WR ACRES
6N35E34C/100	76330	1927	NESW	3.80
6N35E34C/1001	83960	1912	NWSW	10.40
6N35E34C/1001	83960	1912	NWSW	0.70
6N35E34C/1300	83960	1912	SESW	5.10
6N35E34C/1400	83960	1912	SESW	2.85
6N35E34C/1500	83960	1912	SESW	0.10
6N35E34C/1500	83960	1912	SESW	3.00
6N35E34C/1700	76775	1912	SESW	7.13
6N35E34C/700	83960	1912	NESW	10.70
6N35E34C/700	83960	1912	SESW	0.20
6N35E34C/800	83960	1912	NWSW	8.50
6N35E34C/900	83960	1912	NWSW	-15.70 8.4

Primary Certificates

CERTIFICATE, PRIORITY

- 76330, 1927
- 76775, 1912
- 83960, 1912
- Water Rights Not Within Quarter

Legend

- PIPE
- Parcel
- QCDB
- WWRID Boundary

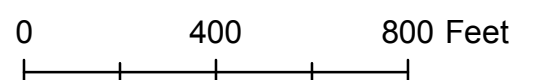

Date March 2011