

RECEIVED **T.5S. R.4W. Sec. 6, 7, & 8, W.M.**

OCT 30 2025

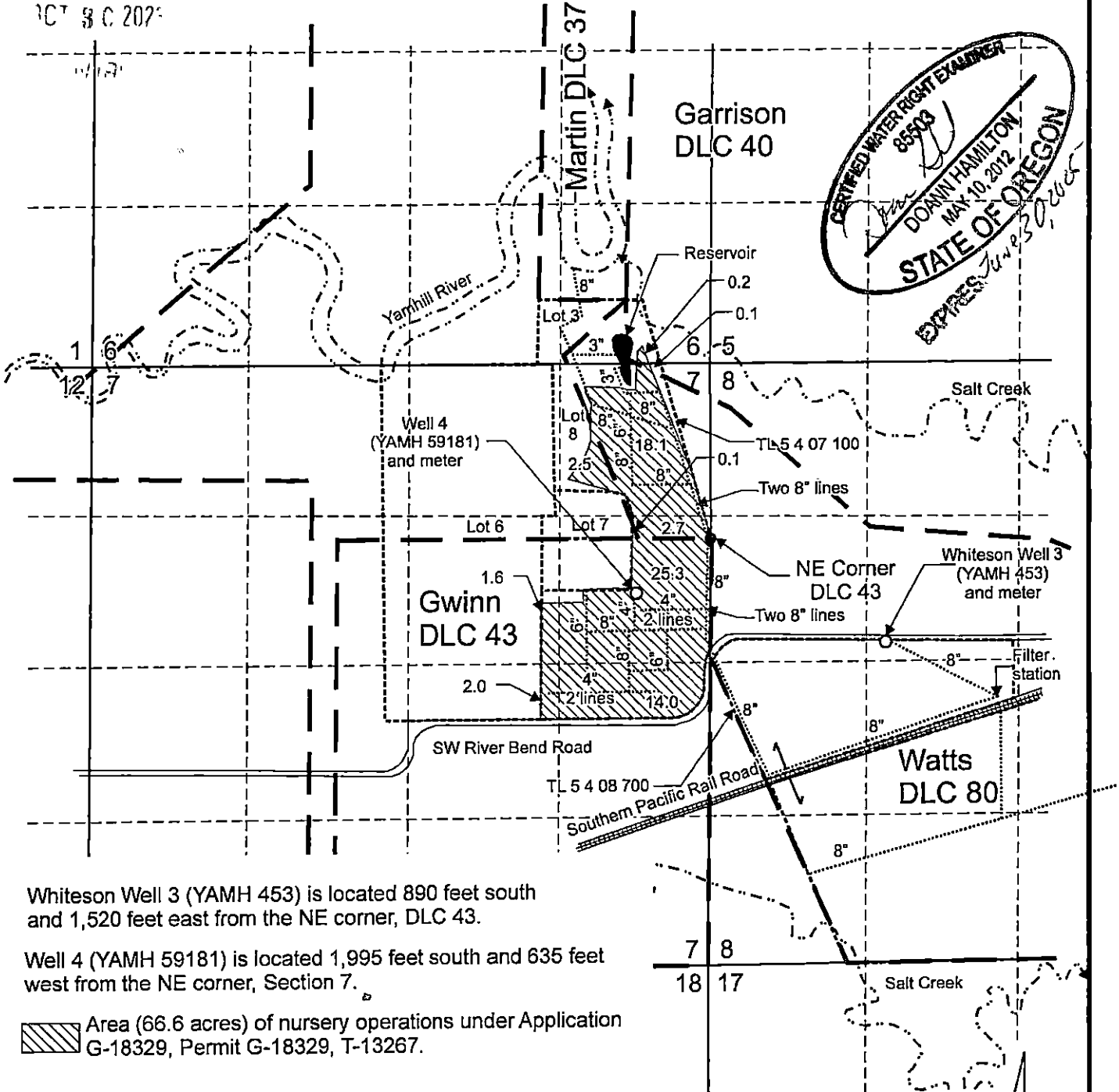

Whiteson Well 3 (YAMH 453) is located 890 feet south and 1,520 feet east from the NE corner, DLC 43.

Well 4 (YAMH 59181) is located 1,995 feet south and 635 feet west from the NE corner, Section 7.

Area (66.6 acres) of nursery operations under Application G-18329, Permit G-18329, T-13267.

----- Tax lot boundary      - - - - - Donation Land Claim boundary      ——— Water main line

Scale: 1" = 1,320'



This map was prepared for the purpose of identifying the location of a water right only and is not intended to provide legal dimensions or location of property ownership lines.

**Claim of Beneficial Use Map**  
Application G-18329, Permit G-18329, T-13267

Robinson Farm LLC  
T.5S. R.4W. Sec. 6, 7, & 8, W.M.

Pacific Hydro-Geology Inc.

10/2023

RobinsonG-18329COBUMap.cdr