

RECEIVED

SEP 16 1999

WATER RESOURCES DEPT.
SALEM, OREGON

T.3 & 4S. R.1W., W.M

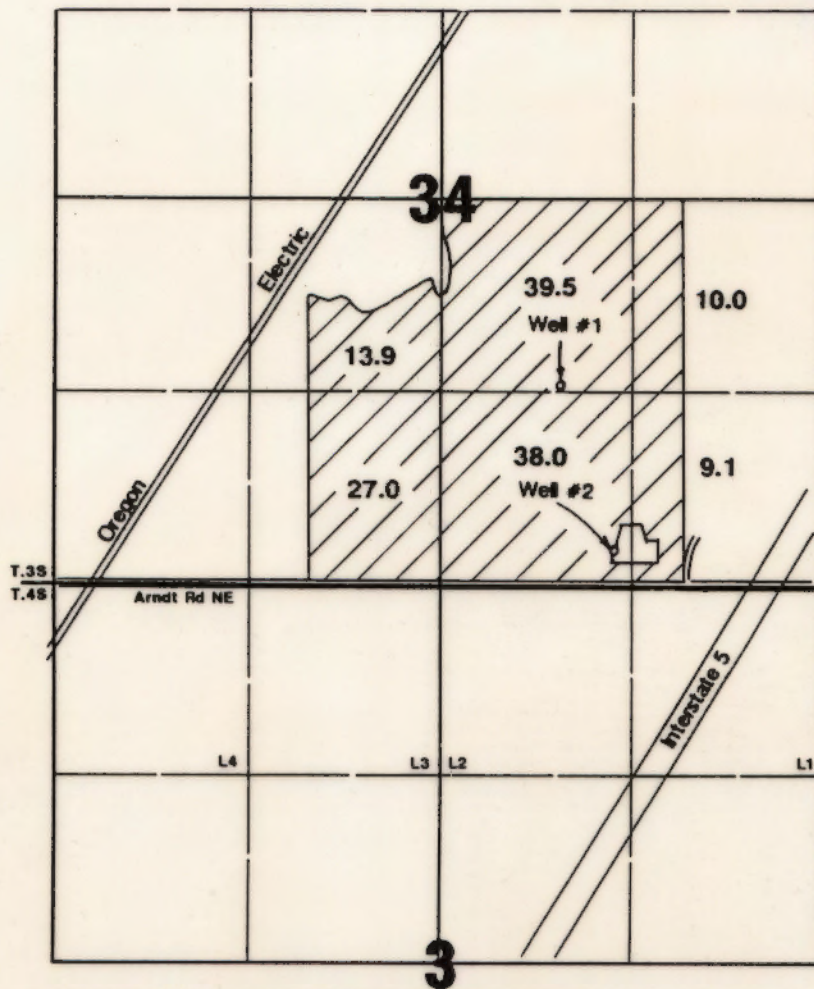

Area Irrigated

Well #1 is located 1340'N & 3470'E from the SW corner of Section 34.
Well #2 is located 250'N & 3850'E from the SW corner of Section 34.

Final Proof Survey

Application #: G-14107 Permit #: G-12933

In Name Of

Doug Femrite-Femrite Nursery

Surveyed on August 28, 1999 by JM Schuette

This Map Was Prepared For The Purpose Of Identifying The
Location Of A Water Right Only And Is Not Intended To Provide
Legal Dimensions Or Location Of Property Ownership Lines.

