

# T37S R4W & T38S R4W WM, JACKSON COUNTY, OR

RECEIVED  
DEC 28 2023  
OWRD

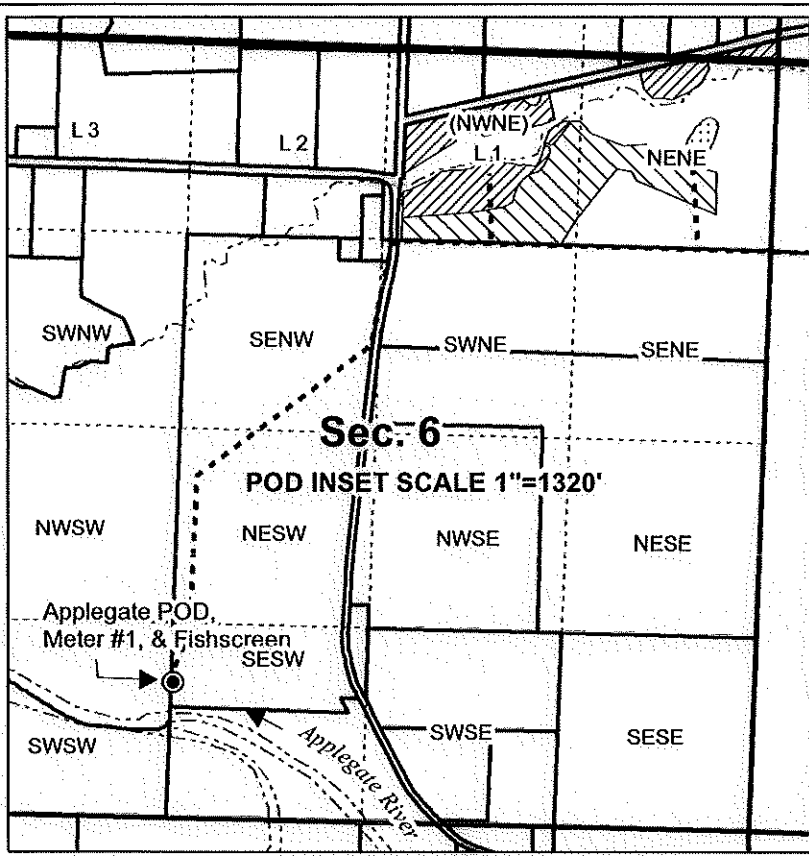

- POD & Fishscreen
- Meter
- Creek/River Bank
- Pipeline
- ▨ POU IR S-54863
- ▩ POU (IS) S-54863
- ⊕ Reservoir
- ▭ Township
- ▭ Section
- DLC
- Quarter Quarter
- ▭ Tax Lot

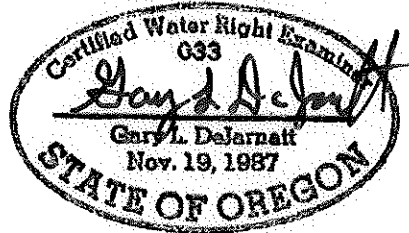
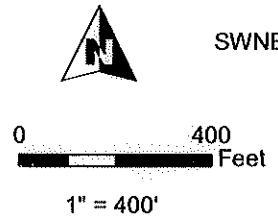
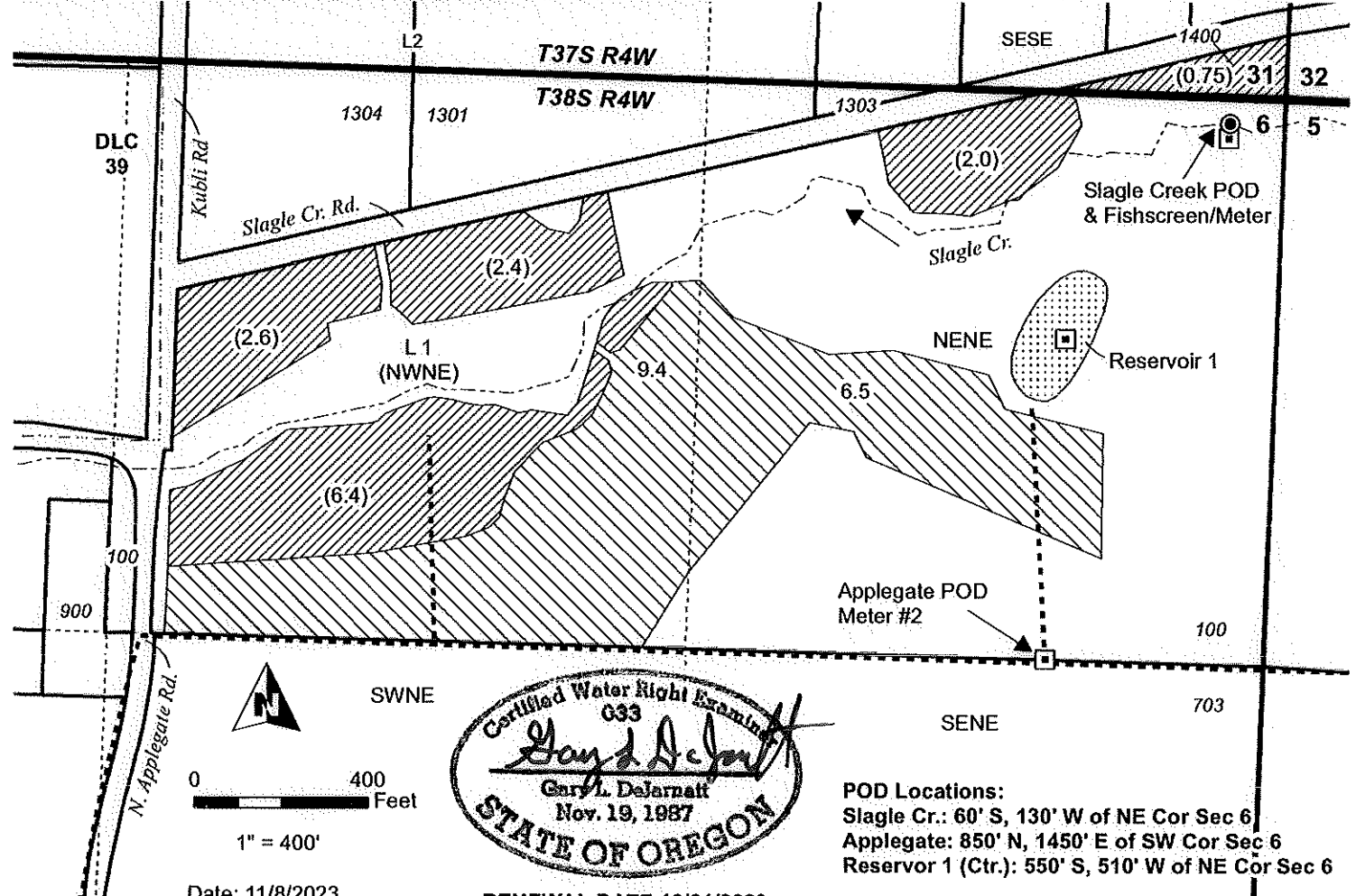

**POD Locations:**  
 Slagle Cr.: 60' S, 130' W of NE Cor Sec 6  
 Applegate: 850' N, 1450' E of SW Cor Sec 6  
 Reservoir 1 (Ctr.): 550' S, 510' W of NE Cor Sec 6

Date: 11/8/2023 RENEWAL DATE 12/31/2023

**CLAIM OF BENEFICIAL USE MAP**  
**Ressler**  
 Project #23053 / Ap R-87640 / Permit R-15024  
 Project #23054 / Ap S-87641 / Permit S-54863

This map is not intended to provide legal dimensions or locations of property ownership lines.

**WATER RIGHT SERVICES, LLC**  
 PO BOX 1830, BEND, OR 97709  
**WWW.OREGONWATER.US** CCB # 197121  
 johnshort@usa.com 541-389-2837