

CLAIM OF BENEFICIAL USE MAP

FOR: HAROLD & LORETTA FASIG
 BY: NATHAN REED, PE, CWRE
 T27S, R6W, W.M. SECTION 16 DLC 50
 APPLICATION NO. S-87909
 PERMIT NO. S-54838

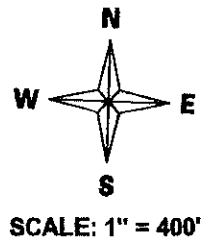

DATE SURVEYED: APRIL 7, 2021

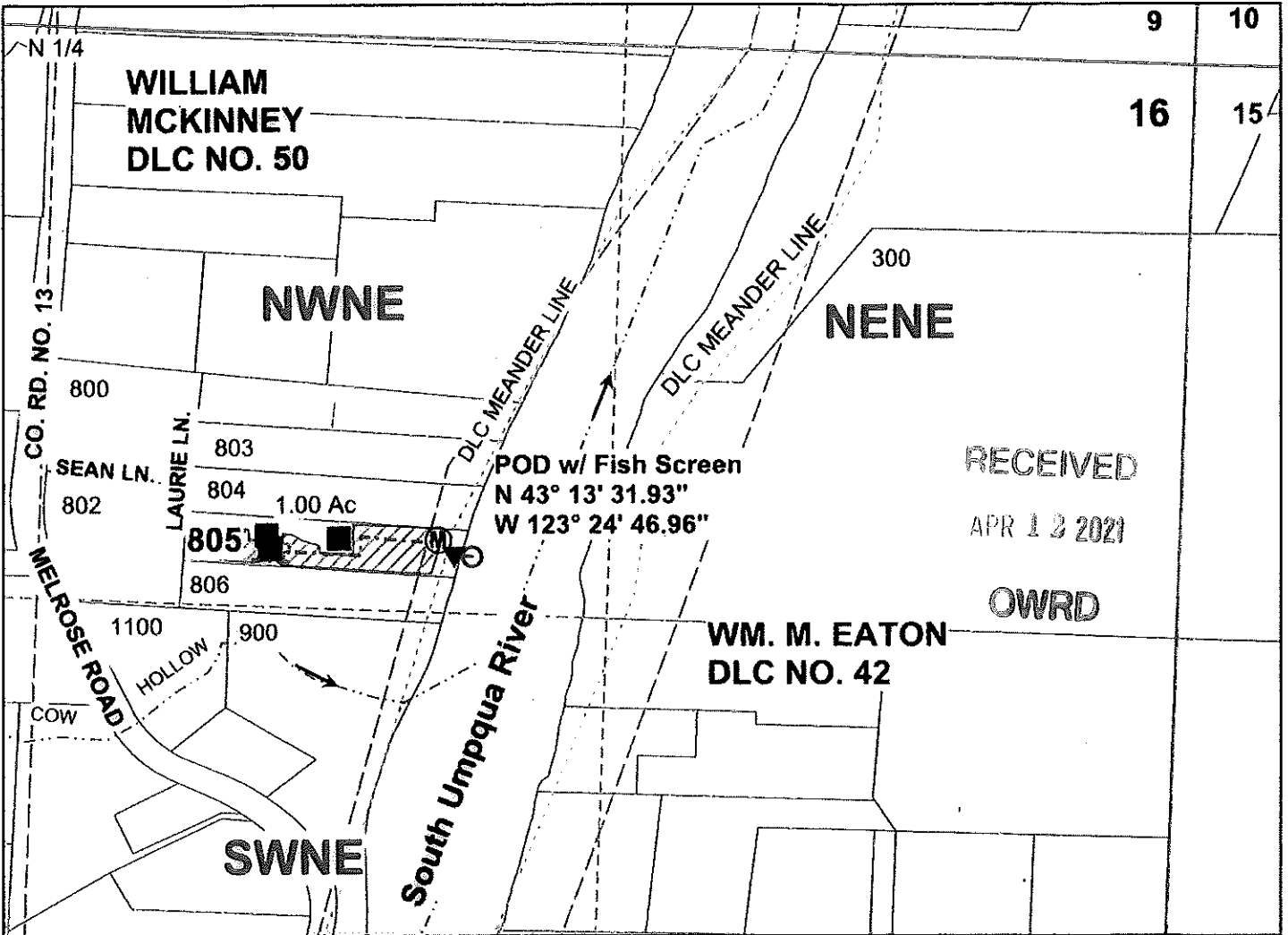

POD IS LOCATED 1151 FEET SOUTH AND 1646 FEET WEST FROM THE NE CORNER, SECTION 16 AS PROJECTED IN DLC NO. 50.

Legend

- | | | | | | |
|-------|------------|-------|------------|-------|-----------|
| ----- | Stream | ▼ | PUMP | ----- | DLC |
| → | Flow arrow | (M) | Meter | ----- | Quarter |
| ○ | POD | ■ | Structures | ----- | Sixteenth |
| ----- | Pipeline | ----- | Meander | ----- | Parcels |

MAP PREPARED FOR:
 HAROLD & LORETTA FASIG
 121 LAURIE LANE
 ROSEBURG, OR 97471

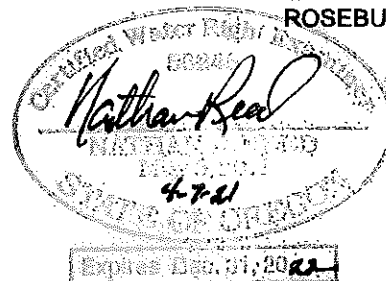

THE PURPOSE OF THIS MAP IS TO IDENTIFY THE LOCATION OF THE WATER RIGHT. IT IS NOT INTENDED TO PROVIDE INFORMATION RELATIVE TO THE LOCATION OF PROPERTY OWNERSHIP BOUNDARY LINES.

MAP PREPARED BY:
 NATHAN R. REED, PE, CWRE
 157 WEST BODIE STREET
 ROSEBURG, OR 97471