

**POINT OF DIVERSION:**

DATE OF PRIORITY: OCTOBER 31, 1996

POD 1 - 1010' WEST AND 4560' NORTH FROM SOUTHWEST CORNER OF SECTION 5, T40S, R14E, W.M., LOCATED IN THE NE 1/4 NE 1/4 OF SECTION 5.

**DAM LOCATION:**

DAM - 1400' SOUTH AND 800' EAST FROM THE NORTHWEST CORNER OF SECTION 16, T40S, R14E, W.M., LOCATED IN THE SW 1/4 NW 1/4 OF SECTION 16.

**NOTES**

1. THE PURPOSE OF THIS MAP IS TO IDENTIFY THE LOCATION OF THE WATER RIGHT ONLY, AND IS NOT INTENDED TO PROVIDE DIMENSIONS OR LOCATION OF PROPERTY LINES.
2. FOR TAX LOT INFORMATION, SEE TAX MAPS INCLUDED WITH THIS APPLICATION.
3. THIS MAP WAS PREPARED FROM FIELD MEASUREMENTS, NAIP 2018 AERIAL PHOTOGRAPH, AND KLAMATH COUNTY TAX MAP 40 14.

**LEGEND**

- SECTION LINES
- 1/4 1/4 LINES
- TAX LOT BOUNDARY
- DITCH LINE
- CREEK LINE
- LAKE BOUNDARY
- GRAVEL/DIRT ROADWAY
- TL 500 TAX LOT NUMBER
- POINT OF DIVERSION
- PUMP
- STORAGE AREA IN SMITH RESERVOIR
- SECTION CORNER
- FLOW DIRECTION

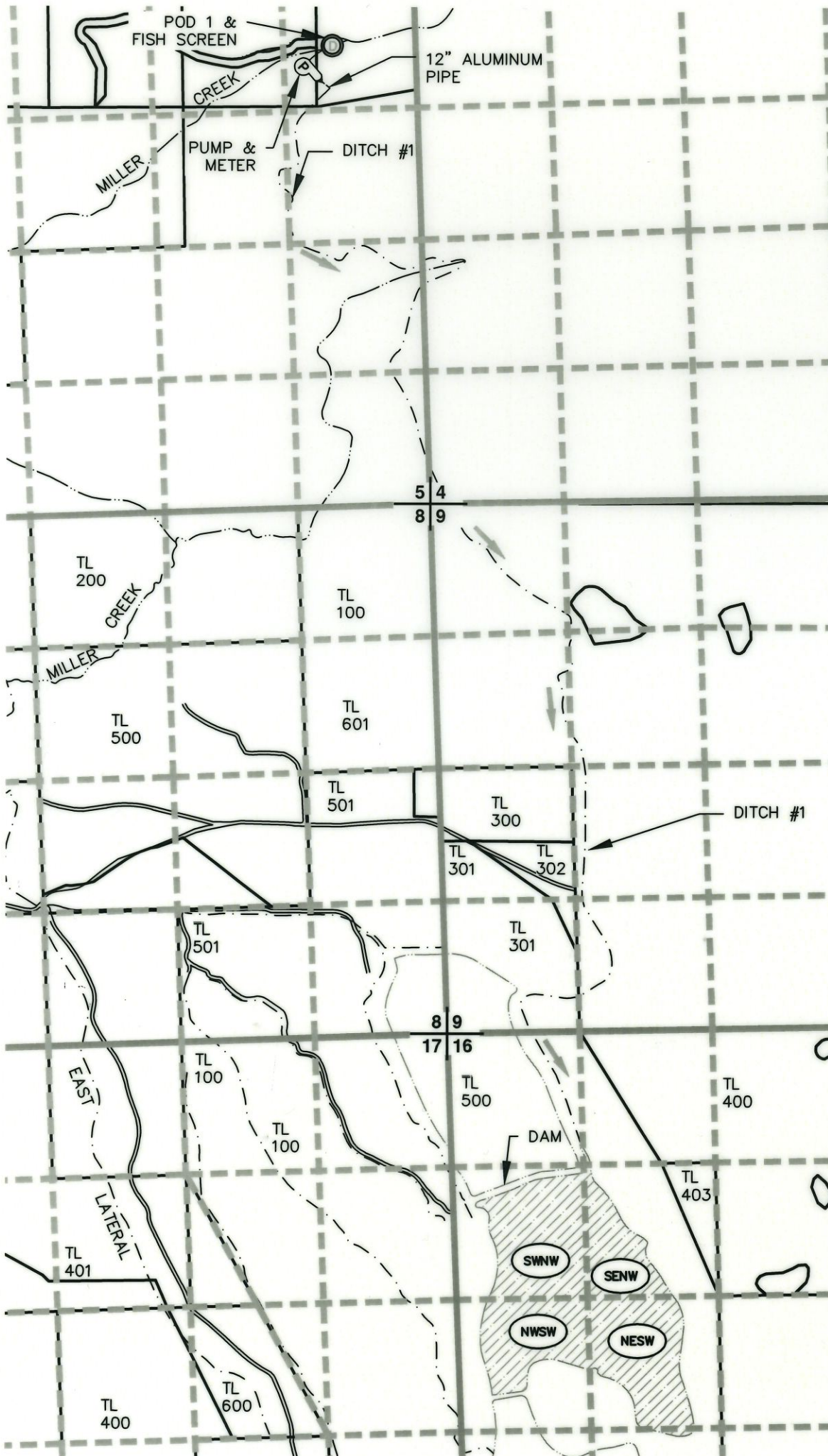

Received by OWRD  
 APR 23 2015  
 Salem, OR

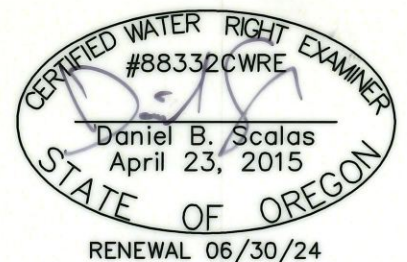

**AL ADKINS** ENGINEERING & SURVEYING  
 o / 541.884.4666  
 w / AdkinsEngineering.com

1435 ESPLANADE AVENUE, KLAMATH FALLS, OR 97601

SERVING S. OREGON & N. CALIFORNIA

ENGINEERING • SURVEYING • PLANNING • TESTING

4/17/2024

1413-0201

**CLAIM OF BENEFICIAL USE AND FINAL PROOF MAP**

FOR  
 MICHAEL & DIANE TYRHOLM  
 T40S, R14E, SEC. 16, W.M.  
 KLAMATH COUNTY, OREGON  
 PERMIT R-12503  
 APPLICATION R-81630

CORR MAP # 1299