

RECEIVED
MAY 6 2024
OWRD

Application for a Water Right Transfer - Point of Diversion Map

Certificate 83682 (Permit S-27610)

Water Right in the Name of City of Brookings
Curry County

SUPERSEDING

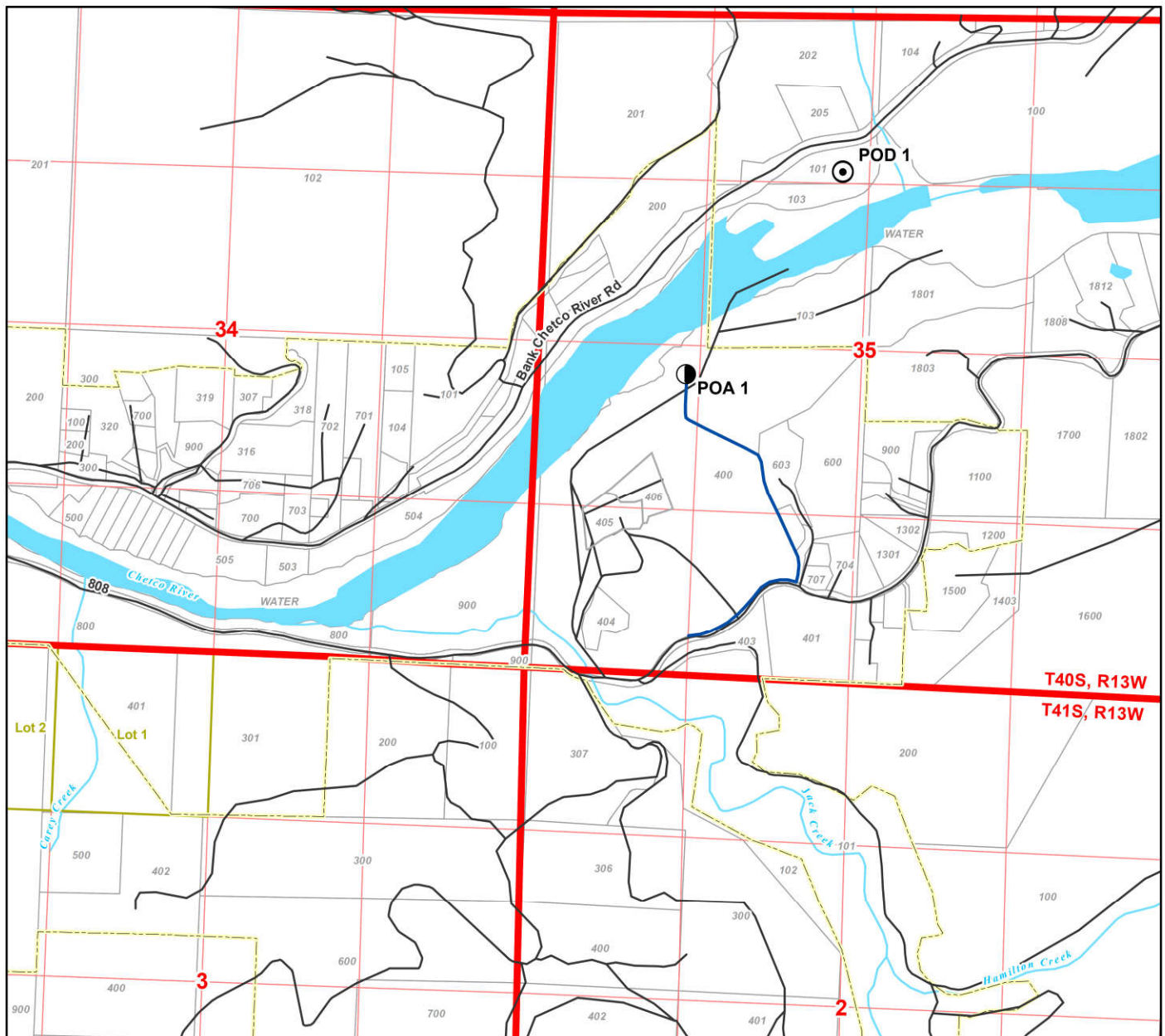

LEGEND

- ⊙ Authorized Point of Diversion (POD)
- Proposed Point of Appropriation (POA)
- Water Mainline to Place of Use
- Government Lot
- ⊕ City Urban Growth Boundary
- ⊕ Tax Lots
- Major Roads
- Streams
- Water Bodies

POD LOCATION DESCRIPTION

POD 1 Located 1,290 feet South and 2,415 feet East from the NW corner of Section 35 (NENW), Township 40 South, Range 13 West, W.M.

POA 1 Located 2,570 feet North and 1,380 feet West from the S1/4 corner of Section 35 (NWSW), Township 40 South, Range 13 West, W.M.



Date: 3/25/2024

Data Sources: OWRD, Oregon Geospatial Data Clearinghouse, BLM
Disclaimer: This map is not intended to provide legal dimensions or property ownership lines.



Scale

0 600 1,320
1 inch = 1,320 feet



RECEIVED
MAY 6 2024
OWRD

Application for a Water Right Transfer - Place of Use Map

Certificate 83682 (Permit S-27610)

Water Right in the Name of City of Brookings
Curry County

SUPERSEDING

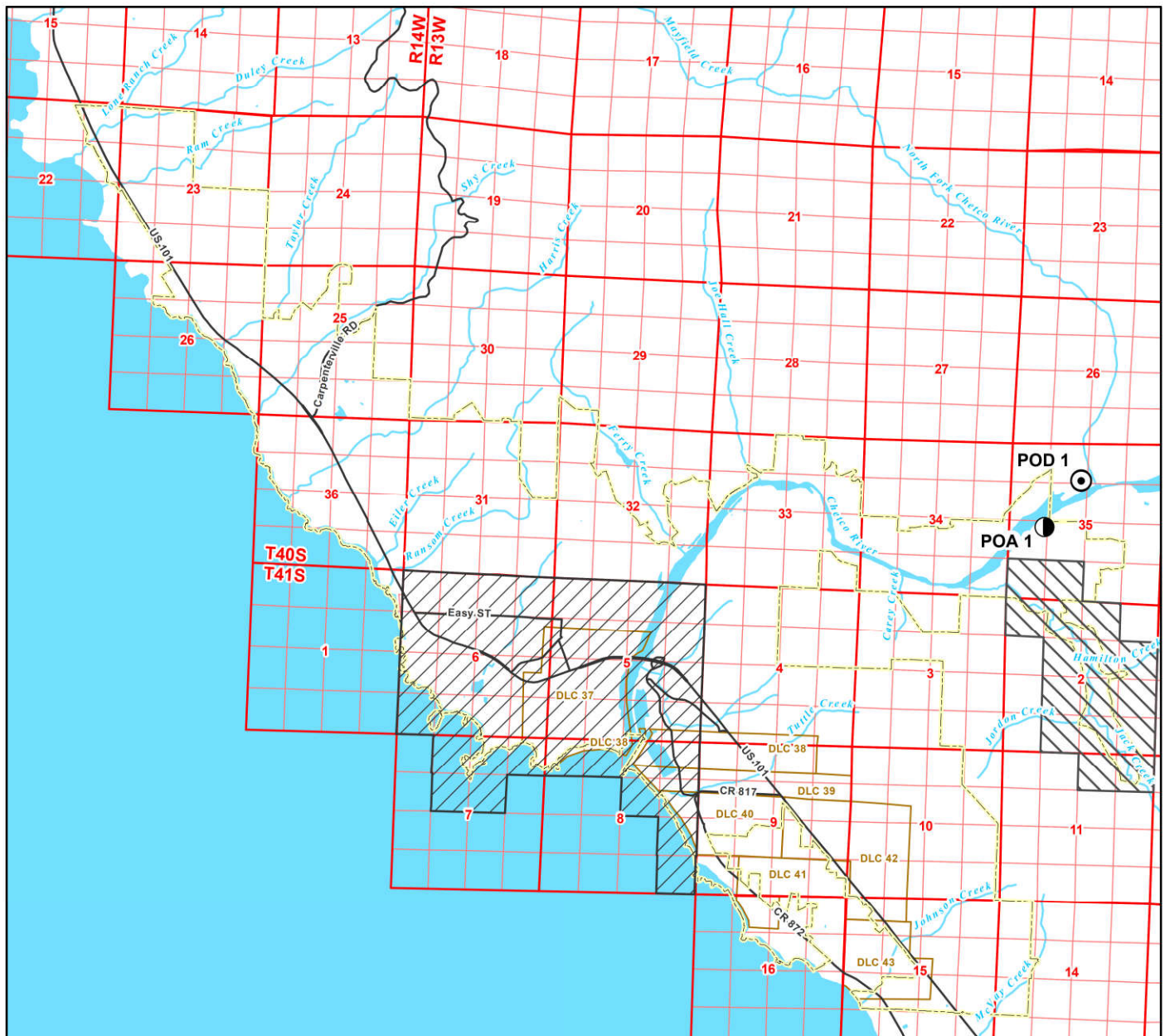

LEGEND

- Authorized Point of Diversion (POD)
- Proposed Point of Appropriation (POA)
- Authorized Place of Use Served by Authorized POD
(3 cfs Portion Not Involved in Transfer)
- Proposed Place of Use to be Served by Proposed POA
(1 cfs Portion Involved in Transfer)
- Donation Land Claim (DLC)
- City Urban Growth Boundary
- Major Roads
- Streams
- Water Bodies

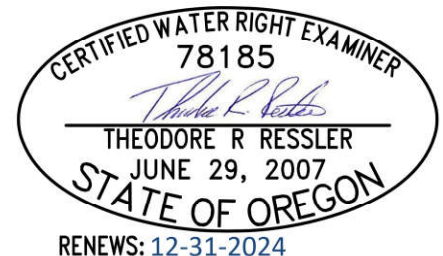

RENEWS: 12-31-2024

Date: 3/25/2024
Data Sources: OWRD, Oregon Geospatial Data Clearinghouse, BLM
Disclaimer: This map is not intended to provide legal dimensions or
property ownership lines.



Scale
0 2,800 5,600
1 inch = 5,600 feet



Application for a Water Right Transfer - Point of Diversion Map Certificate 83682 (Permit S-27610)

Water Right in the Name of City of Brookings
Curry County

SUPERSEDED

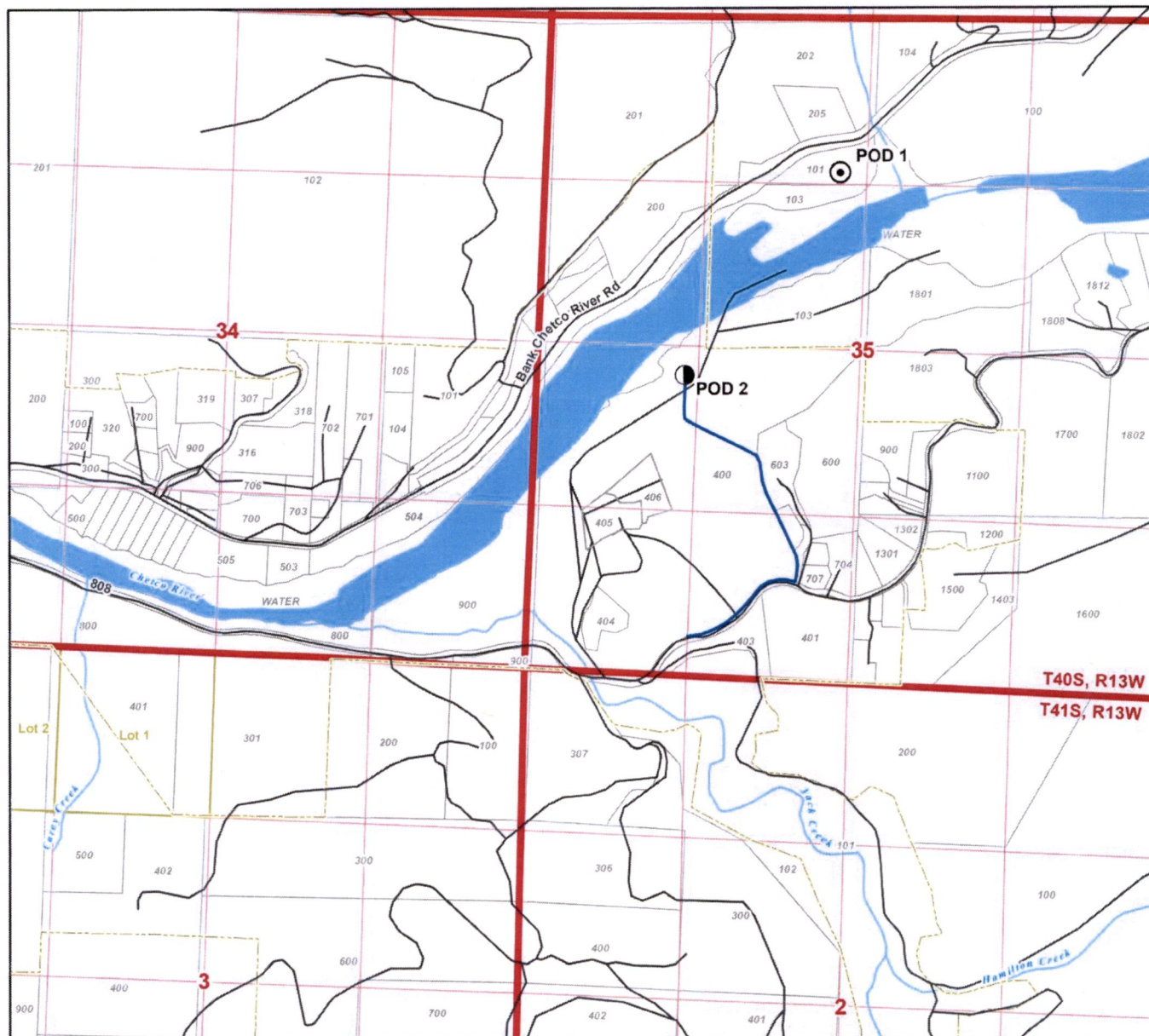

LEGEND

- ⊙ Authorized Point of Diversion (POD)
- Proposed Additional POD
- Proposed Water Line
- Government Lot
- City Urban Growth Boundary
- Tax Lots
- Major Roads
- Streams
- Water Bodies

POD LOCATION DESCRIPTION

POD 1 Located 1,290 feet South and 2,415 feet East from the NW corner of Section 35 (NENW), Township 40 South, Range 13 West, W.M.

POD 2 Located 2,570 feet North and 1,380 feet West from the S1/4 corner of Section 35 (NWSW), Township 40 South, Range 13 West, W.M.

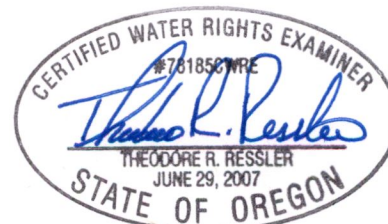

RENEWS: 12-31-2024

Date: 6/13/2023

Data Sources: OWRD, Oregon Geospatial Data Clearinghouse, BLM
Disclaimer: This map is not intended to provide legal dimensions or property ownership lines.



Scale

0 600 1,320
1 inch = 1,320 feet



RECEIVED

JUL 03 2023

OWRD

Application for a Water Right Transfer - Place of Use Map Certificate 83682 (Permit S-27610)

Water Right in the Name of City of Brookings
Curry County

SUPERSEDED

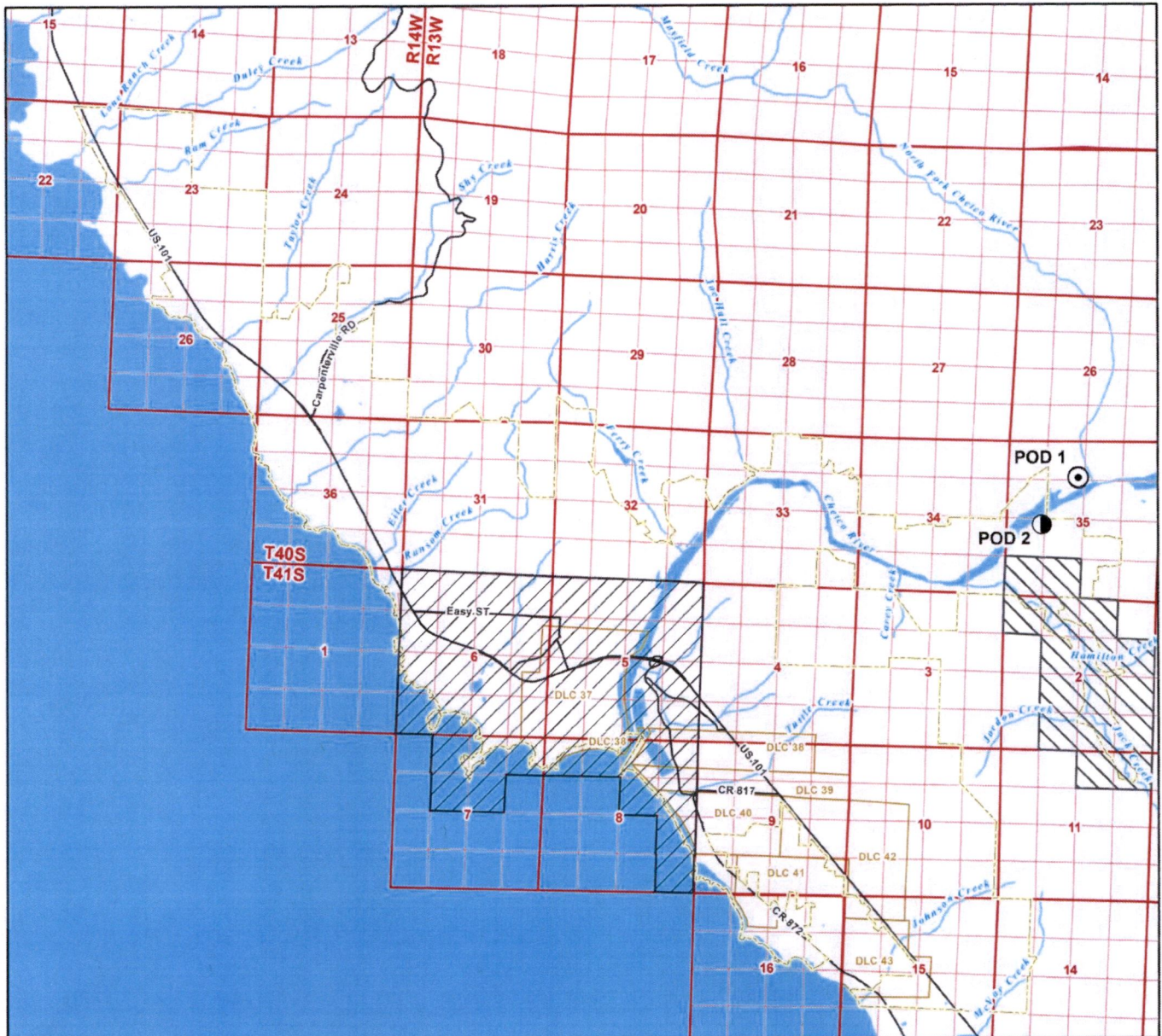

LEGEND

- Authorized Point of Diversion (POD)
- Proposed Additional POD
- Authorized Place of Use Served by Authorized POD (3 cfs Portion Not Involved in Transfer)
- Proposed Place of Use to be Served by Existing POD and Proposed Additional POD (1 cfs Portion Involved in Transfer)
- Donation Land Claim (DLC)
- City Urban Growth Boundary
- Major Roads
- Streams
- Water Bodies

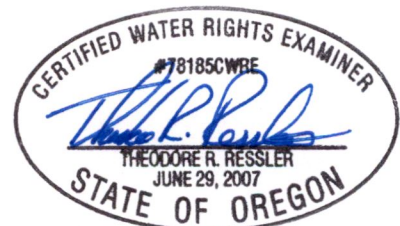

RENEWS: 12.31.2024

Date: 6/13/2023
Data Sources: OWRD, Oregon Geospatial Data Clearinghouse, BLM
Disclaimer: This map is not intended to provide legal dimensions or property ownership lines.



Scale
0 2,800 5,600
1 inch = 5,600 feet



Claim of Beneficial Use - Place of Use Map

Permit No. 27610, Application No. 37091

Townships 40 & 41 South, Ranges 13 & 14 West (W.M.)

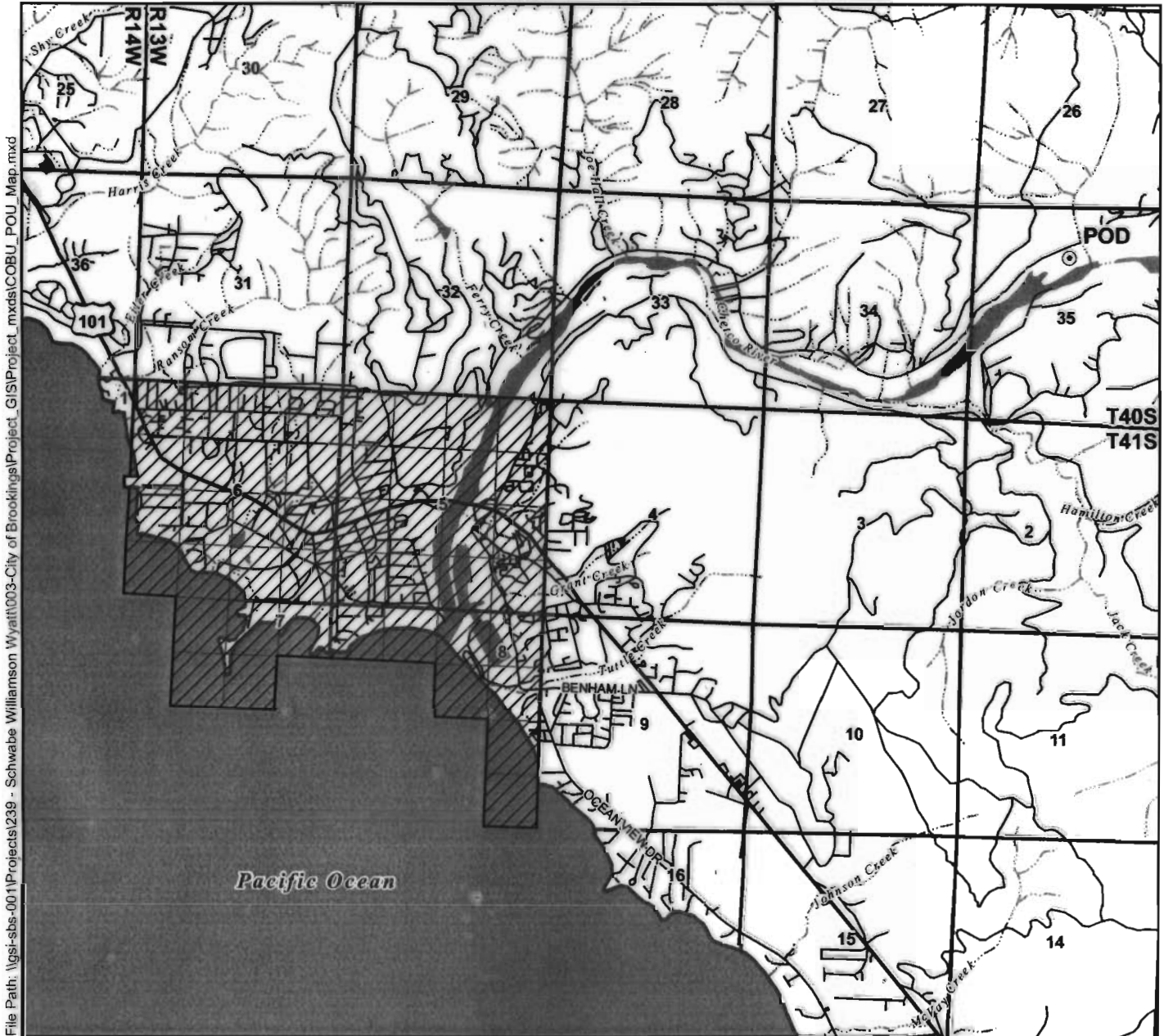

File Path: \\gsi-sbs-001\Projects\239 - Schwabe Williamson Wyatt\003-City of Brookings\Project_GIS\Project_mxd\COBU_POU_Map.mxd

Legend

- ⊙ Point of Diversion (POD)
- ▨ Place of Use (POU)
- Highways
- Roads
- ~ Watercourses
- Waterbodies



Map Information

Projection: Oregon State Plane South Zone
Datum: North American Datum of 1983
Date: December 6, 2007
Prepared By: GSI Water Solutions, Inc.

Data Sources

OWRD, Oregon Geospatial Data Clearinghouse

Notes

Under the provisions of ORS 540.510(3) the City of Brookings may lawfully provide and use water in locations other than those described.

This map was prepared for the purpose of identifying the location of a water right only and it is not intended to provide legal dimensions or location of property ownership lines.

POD Legal Description

Point of Diversion

Located 1,290 feet South and 2,415 feet East from the NW corner of Section 35, Township 40 South, Range 13 West (W.M.)



Scale

1 inch equals 4,000 feet
0 2,000 4,000
Feet

RECEIVED

DEC 12 2007

WATER RESOURCES DEPT
SALEM, OREGON



Claim of Beneficial Use - Point of Diversion Map

Permit No. 27610, Application No. 37091
Township 40 South, Range 13 West (W.M.)

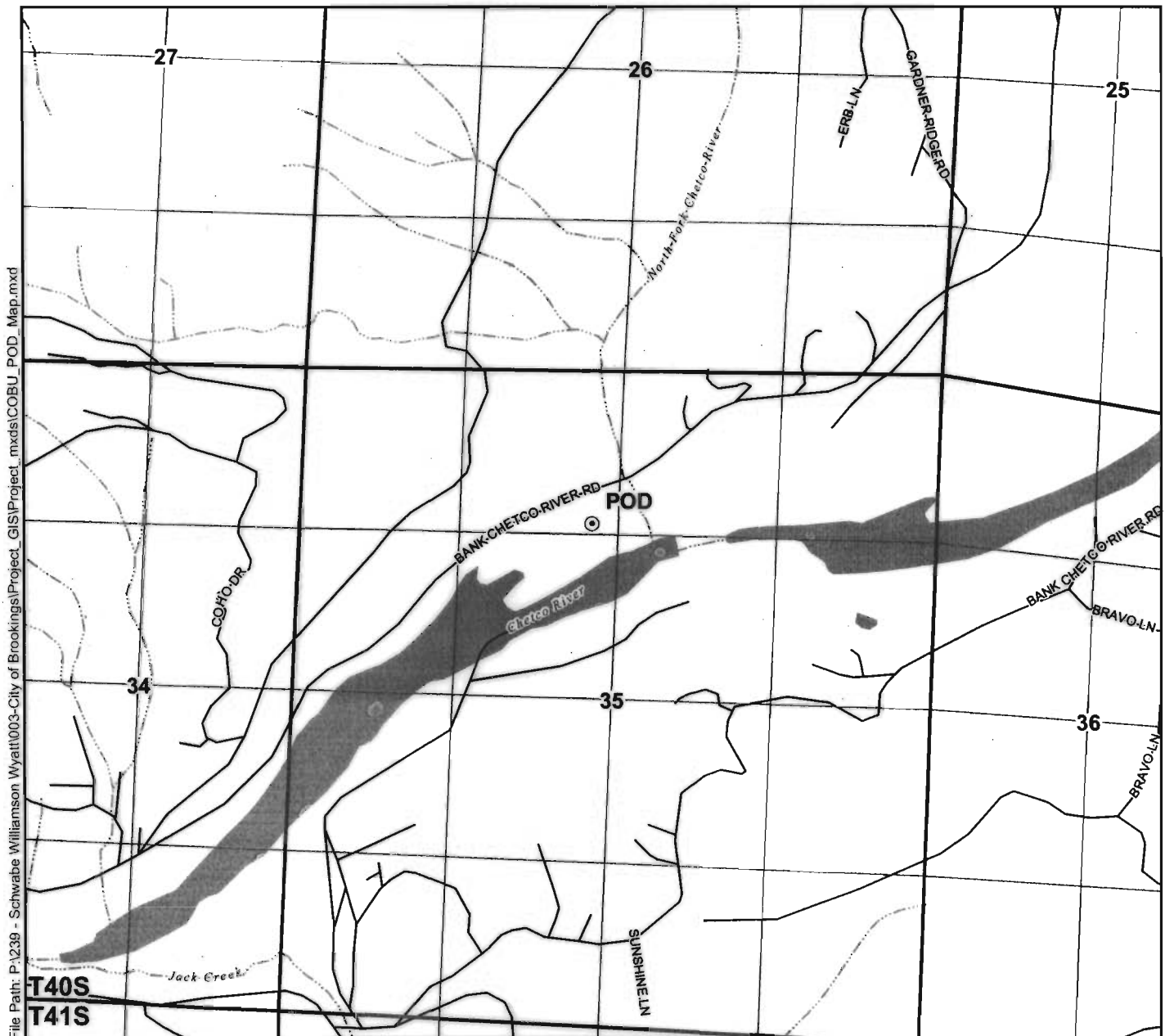

Legend

- Point of Diversion (POD)
- Roads
- ~ Watercourses
- Waterbodies

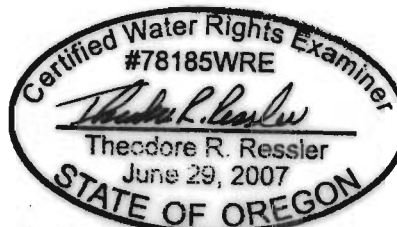

EXPIRES: 12-31-2008

Map Information

Projection: Oregon State Plane South Zone
Datum: North American Datum of 1983
Date: December 6, 2007
Prepared By: GSI Water Solutions, Inc.

Data Sources

OWRD, Oregon Geospatial Data Clearinghouse

Notes

This map was prepared for the purpose of identifying the location of a water right only and it is not intended to provide legal dimensions or location of property ownership lines.

POD Legal Description

Point of Diversion
Located 1,290 feet South and 2,415 feet East from the NW corner of Section 35, Township 40 South, Range 13 West (W.M.)



Scale

1 inch equals 1,320 feet
0 660 1,320
Feet

RECEIVED

DEC 12 2007

WATER RESOURCES DEPT
SALEM, OREGON

