

Section 26, T17S, R1W, W.M.,
Lane County, Oregon

Transfer T-12514
CLAIM OF BENEFICIAL USE MAP
Shangri-La Water District

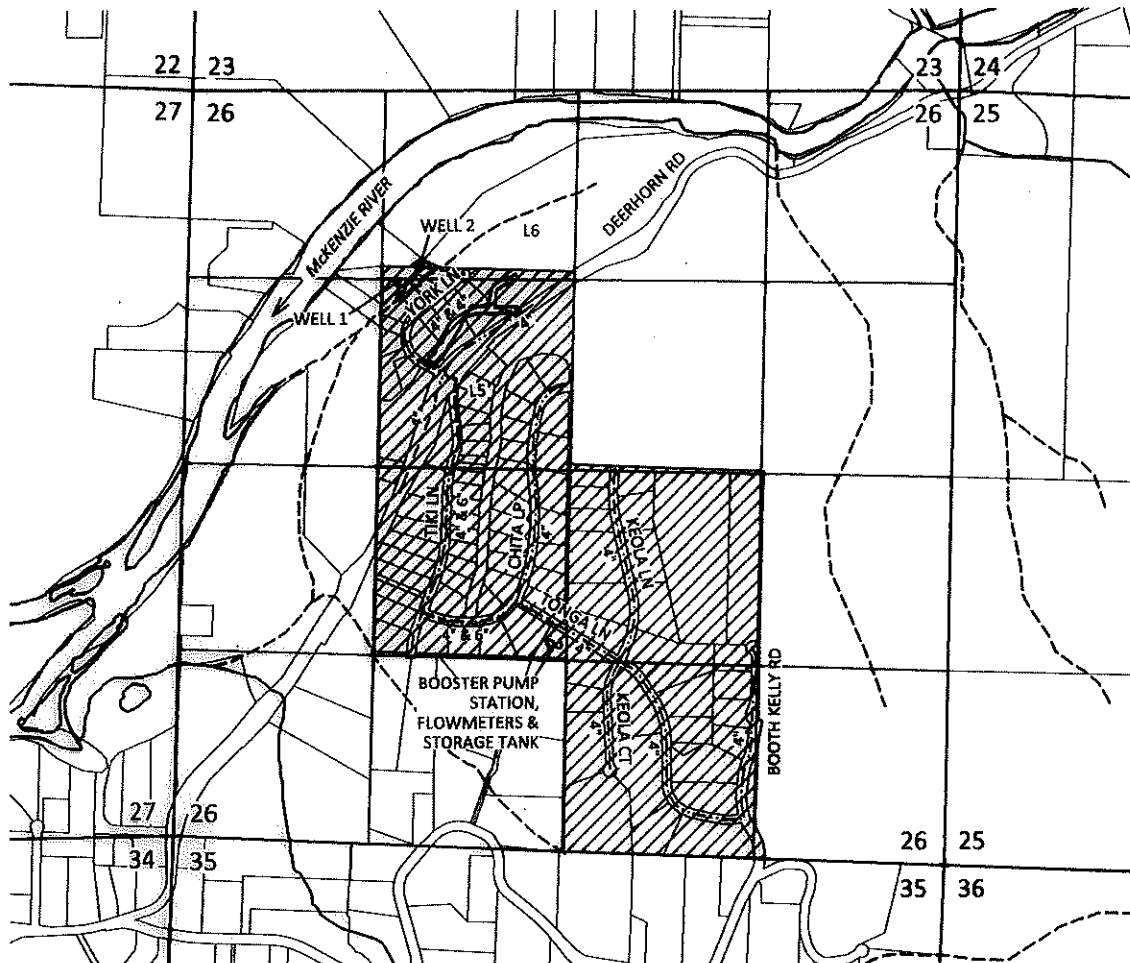

WELL 1 LOCATION: 1310 FT S AND 1400 FT E FROM NW CORNER OF SECTION 26, T17S, R1W, W.M.

WELL 2 LOCATION: 1190 FT S AND 1550 FT E FROM NW CORNER OF SECTION 26, T17S, R1W, W.M.

SITE INSPECTION CONDUCTED OCTOBER 15, 2019

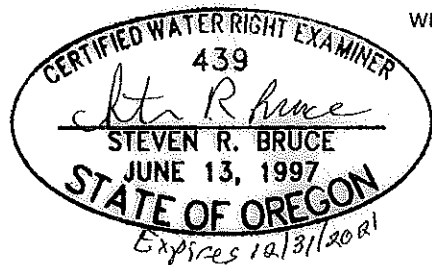

EXPLANATION



PLACE OF USE - QUASI-MUNICIPAL USE
PRIORITY: 3/1/1972



WELL



PIPE

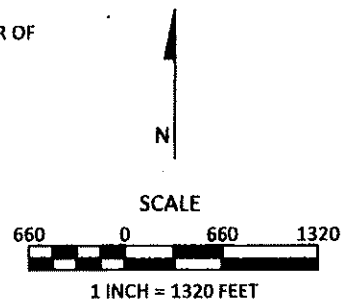

March 30, 2020

This map is not intended to provide legal dimensions or locations of property ownership lines

SKOOKUM
WATER ASSOCIATES INC

1626 VICTORIAN WAY
EUGENE, OR 97401
(503) 319-8926

RECEIVED

APR 09 2020

OWRD

Figure 1