

# T.3S. R.4E. Sec. 18 & 19, W.M.

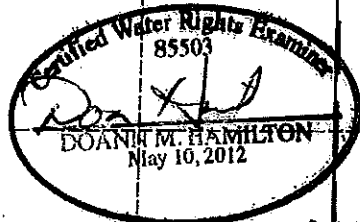

RENEWS June 30, 2017

RECEIVED

JUN 30 2015

WATER RESOURCES DEPT  
SALEM, OREGON

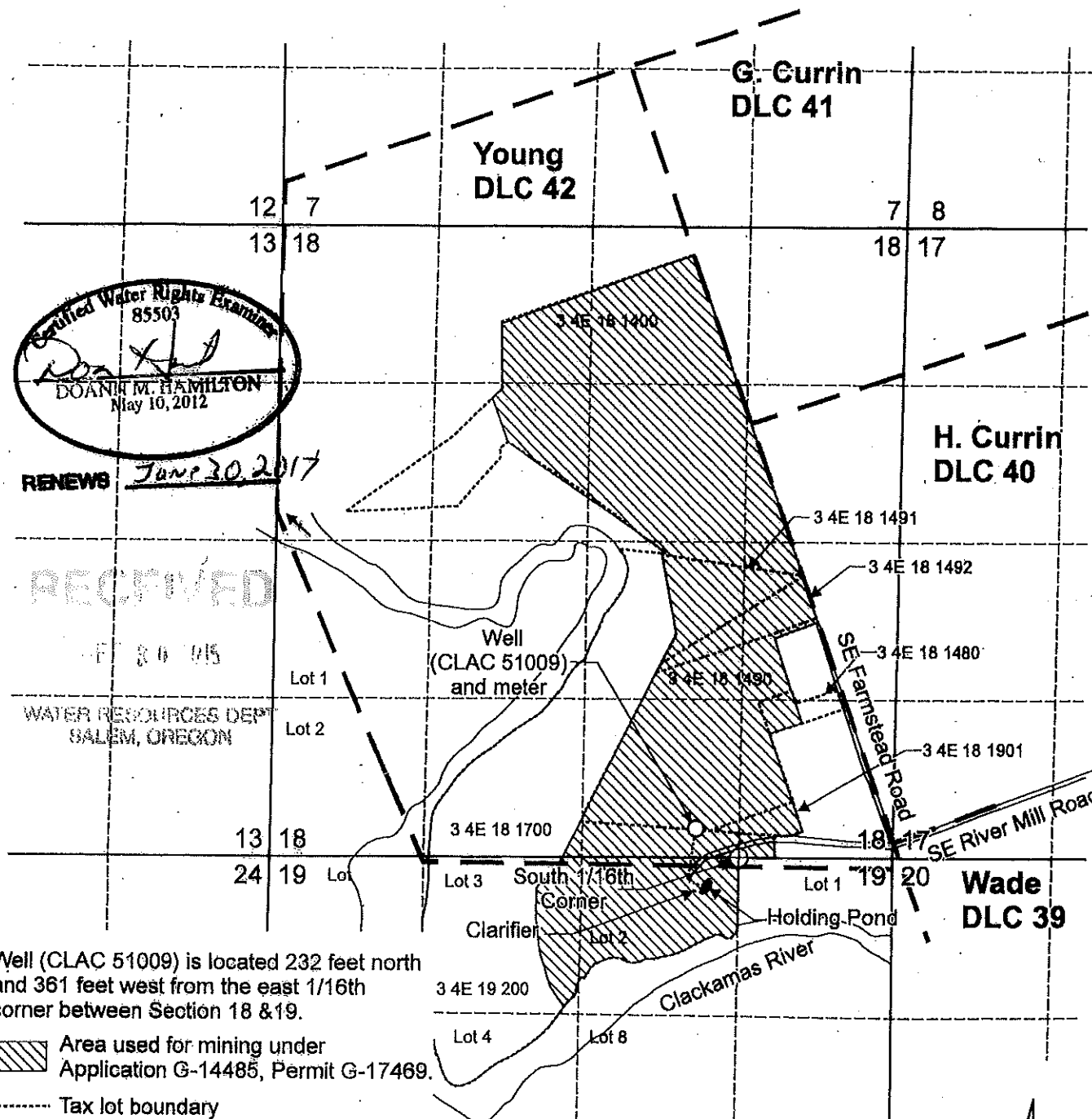

Well (CLAC 51009) is located 232 feet north and 361 feet west from the east 1/16th corner between Section 18 & 19.

Area used for mining under Application G-14485, Permit G-17469.

- Tax lot boundary
- Donation Land Claim boundary
- Mainlines

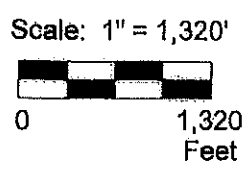

This map was prepared for the purpose of identifying the location of a water right only and is not intended to provide legal dimensions or location of property ownership lines.



Claim of Beneficial Use Map  
Application G-14485, Permit G-17469

Pacific Hydro-Geology Inc.

Estacada Rock Products, Inc.  
T.3S. R.4E. Sec. 18 & 19, W.M.

12/2015

EstacadaCOBUMap.cdr